

Installation & CARE

2008-2012 CHEVY MALIBU PROJECTOR HEADLIGHTS INSTALLATION

BEFORE INSTALLATION

- If you experience any difficulties that the instruction did not cover, please seek assistance at local automotive shop.
- Please wear protection before you work on any vehicle.
- An assistant is useful when removing the front bumper from your vehicle.
- Please be cautious when working with the bumper or any parts belonging to the vehicles's body to prevent scratching.
- Do not make direct contact with the halogen bulbs or the wire assembly until the unit has cooled down after use.

TOOLS AND SUPPLIES REQUIRED

1/4" Ratchet	7 mm socket	10 mm socket	Plastic Pry bar
			

PRODUCT NUMBER

2LHP-MBU08-TM
2LHP-MBU08G-TM
2LHP-MBU08JM-TM



LET'S START THE INSTALLATIONS



STEP 1

Lift hood



STEP 2

Remove ten 10mm radiator cover bolts



STEP 3

Remove four radiator cover fasteners



STEP 4

Remove radiator cover

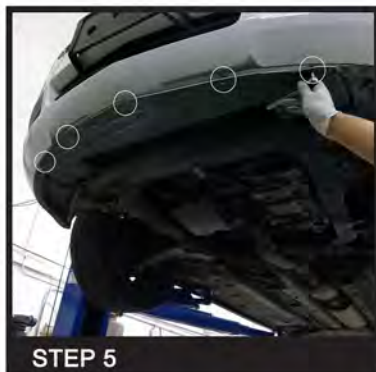

STEP 5

Remove five 7mm lower bumper screws

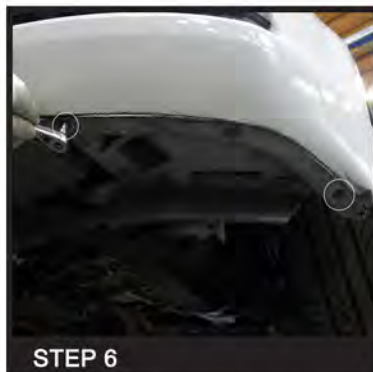

STEP 6

Remove two 7mm lower bumper screws per side

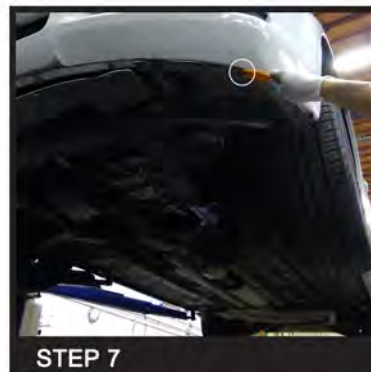

STEP 7

Remove one bumper fastener per side

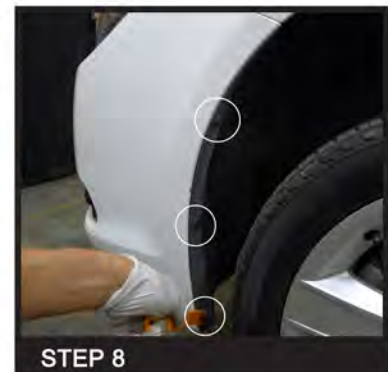

STEP 8

Remove 3 wheel well fasteners (per side)

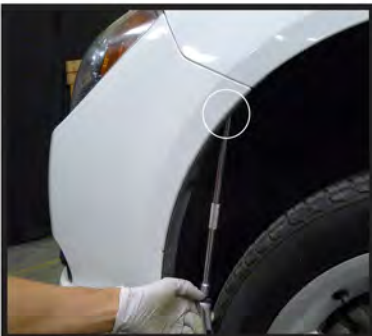

STEP 9

Remove 10mm bumper bolt inside wheel well



STEP 10

Pry side of bumper to loosen



STEP 11

Pry bumper front area



STEP 12

Remove bumper - Be careful not to scrape headlights when removing bumper



STEP 13

Remove one front 10mm headlight bolt

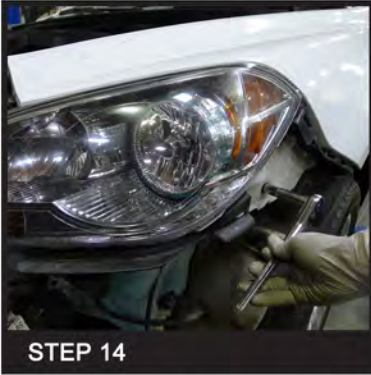

STEP 14

Remove one 10mm side headlight bolt

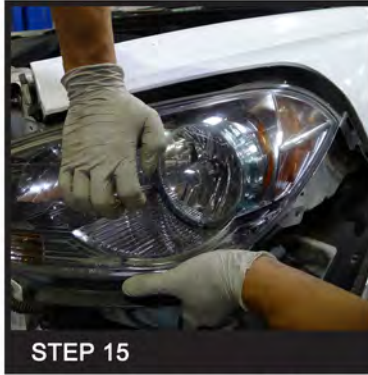

STEP 15

Push downward to unhinge headlight housing



STEP 16

Disconnect harness connector and remove headlight housing



STEP 17

Attach resistor to a clean metal area if provided

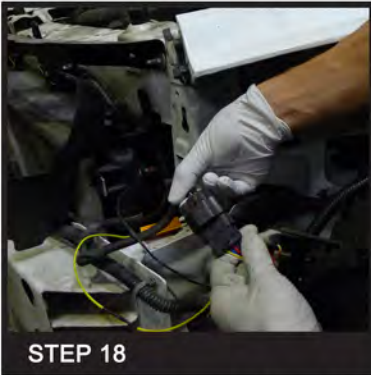

STEP 18

Connect harness connector to projector headlight

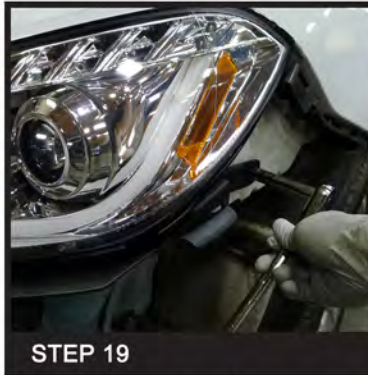

STEP 19

Install projector headlight - ensure that the rear center and inner headlight clips are aligned with the chassis



STEP 20

Repeat the step from 13-19 for opposite side

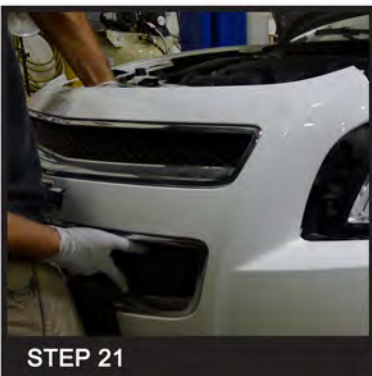

STEP 21

Be careful not to scratch projector headlight when reinstalling bumper



STEP 22

Reinstall 10mm bumper bolt inside wheel well

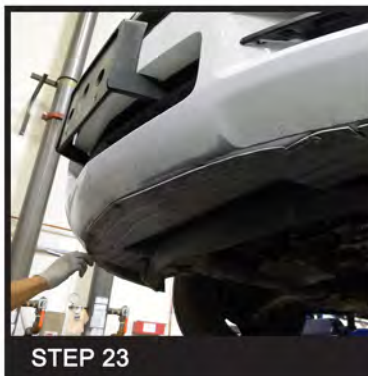

STEP 23

Reinstall five 7mm lower bumper screws

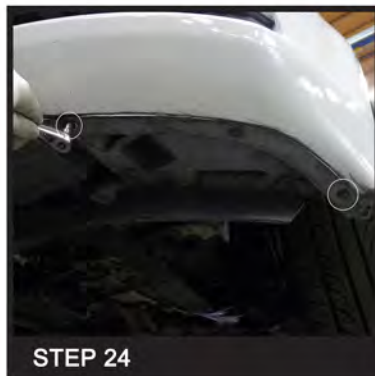

STEP 24

Reinstall two 7mm lower bumper screws



STEP 25

Reinstall one lower bumper fastener



STEP 26

Move wheel well guard into position and reinstall three wheel well fasteners



STEP 27

Place Radiator cover in position



STEP 28

Reinstall ten 10mm radiator cover bolts



STEP 29

Reinstall four radiator cover fasteners

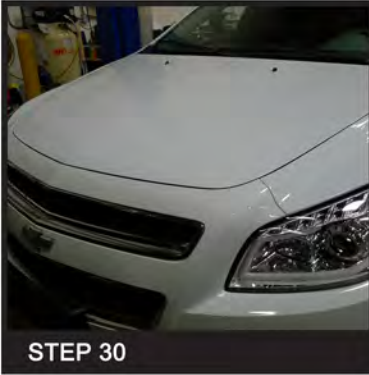

STEP 30

Close hood