

Installation & CARE

2007-2013 CHEVY SILVERADO PROJECTOR HEADLIGHTS INSTALLATION INSTRUCTIONS

BEFORE INSTALLATION:

- If you experience any difficulties that the instructions did not cover, please seek assistance at a local automotive shop.
- Please wear protection before you work on any vehicle.
- An assistant is useful when removing the front bumper from your vehicle.
- Please be cautious when working with the bumper or any parts belonging to the vehicles's body to prevent scratching.
- Do not make direct contact with the halogen bulbs or the wire assembly until the unit has cooled down after use.

TOOLS AND SUPPLIES REQUIRED

1/4" Ratchet	6 inch Extension	10 mm socket	Trim Pad Remover
			
Needle Nose Pliers			
			

PRODUCT NUMBER

2LHP-SIV07-RS 2LHP-SIV07G-RS
2LHP-SIV07JM-RS 2LHP-SIV07SM-RS



LET'S START THE INSTALLATION



STEP 1

Remove the eight plastic clips

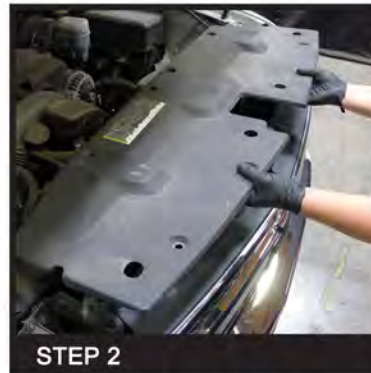

STEP 2

Remove the plastic radiator cover



STEP 3

Remove the four 10mm bolts

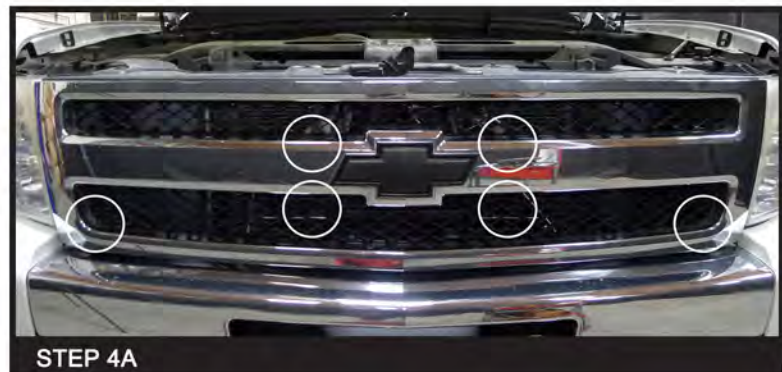

STEP 4A

Unclip and remove the front grill



STEP 4B

Unclip and remove the front grill



STEP 5

Remove one 10mm headlight bolt at the bottom



STEP 6

Remove two 10mm headlights bolts at the top



STEP 7

Disconnect the headlight harness

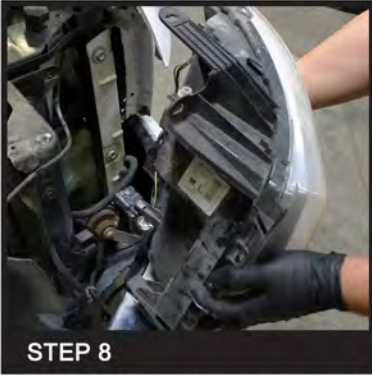

STEP 8

Remove the factory headlight housing



STEP 9

Remove the headlight harness from the factory headlights



STEP 10

Install the headlight harness to the new headlights



STEP 11A

Connect the light bar wires to parking lights, the red wire to positive and the black wire to negative



STEP 11B

Connect the light bar wires to the parking lights, the red wire to positive and the black wire to negative



STEP 12

Connect the headlight harness

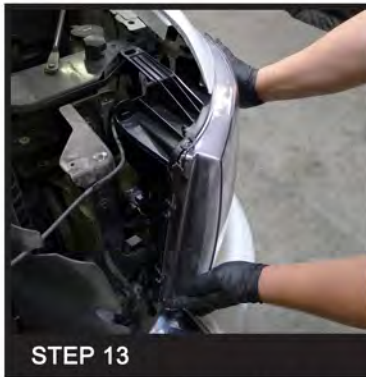

STEP 13

Install the headlight assembly in place



STEP 14

Reinstall the two 10mm headlight mounting bolts at the top

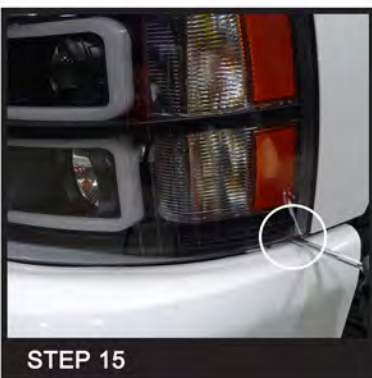

STEP 15

Reinstall one 10mm headlight mounting bolt at the bottom



STEP 16

Please repeat the steps from 5 to 15 for the opposite side



STEP 17

Reinstall the four 10mm bolts



STEP 18

Reinstall the plastic radiator cover

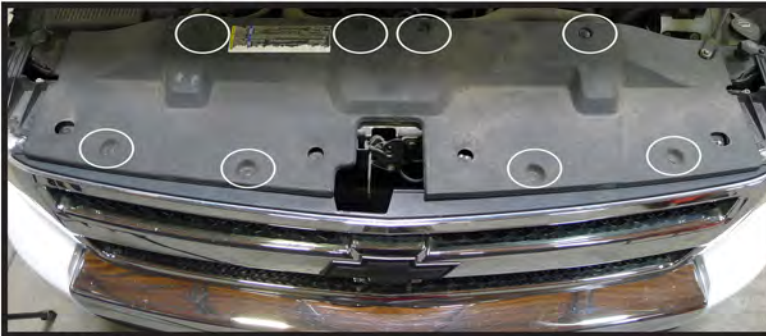

STEP 19

Reinstall the eight plastic clips and close the hood



STEP 20

Complete

2007-2013 CHEVY SILVERADO PROJECTOR HEADLIGHTS INSTALLATION INSTRUCTIONS

BEFORE INSTALLATION

- If you experience any difficulties that the instruction did not cover, please seek assistance at local automotive shop.
- Please wear protection before you work on any vehicle.
- An assistant is useful when removing the front bumper from your vehicle.
- Please be cautious when working with the bumper or any parts belonging to the vehicles's body to prevent scratching.
- Do not make direct contact with the halogen bulbs or the wire assembly until the unit has cooled down after use.

2007-2013 CHEVY SILVERADO PROJECTOR HEADLIGHTS INSTALLATION INSTRUCTIONS

● HIGH / LOW BEAM Adjustment Screw

