



WWW.SMITTYBILT.COM

Installation Instructions

Security Stereo Floor Console

(Part # 318xx) 1976-1995 CJ & Wranglers

IMPORTANT NOTICE: Carefully read instructions before attempting to install this product. Smittybilt is in no way responsible for any damage to the vehicle or personal injury that may occur during the installation or use of this product. **DRILLING REQUIRED.**

1. Apply Neoprene Gasket to the bottom of the main compartment.
2. Locate (4)-Cap Nuts, (4)-10-32 x 1/2" Hex Washer Phillips Screws, (4)-10-32 Flat Washers, and (2)-Seat Belt Straps. Attach Seat Belt Straps to the side of the Security Console by using the hardware listed in this step (Figure 1).



Figure 1

3. Locate (2)-10-32 x 1/2" Hex Washer Phillips Screws, (2)-10-32 Flat Washers, and (2)-10-32 Lock Nuts. Attach Mounting Bracket to the two small center holes on the bottom of the console by using the hardware listed in this step (Figure 2).
4. Position Security Floor Console between the seats and mark the floor directly under the three mounting holes on the bottom of the Console (Figure 3). NOTE: Check to make sure that the shift lever will not interfere with console.

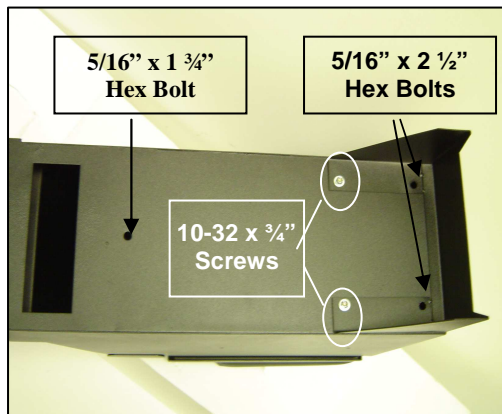

Figure 2



Figure 3

For Technical Support/Warranty Information please call 310-762-9944

Smittybilt, 1600 Walnut Parkway, Rancho Dominguez, CA 90220



WWW.SMITTYBILT.COM

Installation Instructions

Security Stereo Floor Console
(Part # 318xx) 1976-1995 CJ & Wranglers

WARNING! Before you proceed to the next step, make sure that there is nothing under the vehicle that will be damaged by the drill bit when drilling.

5. Remove the Security Floor Console, cut holes in the carpet where the marks are and drill a 5/16" hole on each marked spot (Figure 5). Use touch up paint or silicone sealant (not included) in any drilled holes to prevent rusting.

NOTE: If you are not installing a stereo proceed to Step 6.

NOTE: If a stereo is to be mounted in the console, an antenna extension wire will be required and is available at most stereo equipment stores.

- **Run all required stereo and speaker wires to the console mounting location. Smittybilt recommends running wires in a protective wire loom and using rubber grommets when passing through any drilled holes.**
 - **Insert stereo into the front of the Security Console. You may need to purchase a mount/install kit from a local electronic shop.**
 - **Connect all wires to the stereo according to your stereo owner's manual.**
 - **A strap is included (if desired) to secure the stereo to the console. Installation is left up to your preference. No hardware for it is included. A common way is to connect to back of stereo then Drill a hole in the console and attach with a nut and bolt. (Fig 6)**
6. Locate (2)-5/16" x 2/12" Hex Head Bolts, (4)-5/16" Flat Washers, and (2)-5/16" Lock Nuts. Fasten down the rear of the console through rear holes in the Security Console and holes in mounting Bracket by using the hardware listed in this step (Figure 5).
 7. Locate (1)-5/16 x 1 3/4" Hex Head Bolt, (2)-5/16" Flat Washers, and (1)-5/16" Lock Nut. Fasten down the front of the Security Console by using the hardware listed in this step (Figure 5).

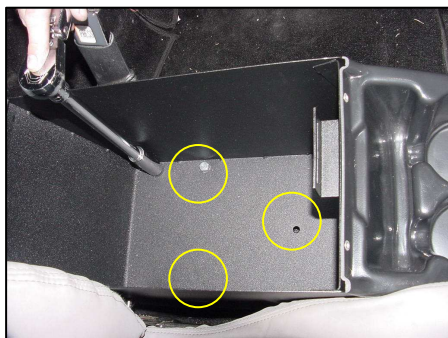

Figure 5



Figure 6

For Technical Support/Warranty Information please call 310-762-9944

Smittybilt, 1600 Walnut Parkway, Rancho Dominguez, CA 90220



WWW.SMITTYBILT.COM

Installation Instructions

Security Stereo Floor Console

(Part # 318xx) 1976-1995 CJ & Wranglers

8. Installation is now complete. Note: *To lock and unlock Security Console; insert key, push down and turn.*



Compliment your CJ or YJ with other quality Smittybilt products

- Soft-goods
- Armor
- Bumpers
- Rocker Guards
- Seats

LIMITED 90 DAY WARRANTY

Smittybilt (the Company) warrants to the original purchaser of this product that should the product or any part thereof, under normal use and conditions, be proven defective in material or workmanship within 90 DAYS from the date of original purchase, such defect(s) will be repaired or replaced (at the Company's option) without charge for parts or labor.

To obtain repair or replacement within the terms of this Warranty, the product is to be delivered with proof of warranty coverage (e.g. Dated bill of sale), specification of defect(s) to the place of purchase or, with prior approval from the Company, freight pre-paid to the Company address listed below.

This warranty does not apply to any product or part thereof which, in the opinion of the Company, has suffered or been damaged through alteration, improper installation, mishandling, misuse, neglect, accident or by acts of nature. THE EXTENT OF THE COMPANY'S LIABILITY UNDER THIS WARRANTY IS LIMITED TO THE REPAIR OR REPLACEMENT PROVIDED ABOVE AND, IN NO EVENT, SHALL THE COMPANY'S LIABILITY EXCEED THE PURCHASE PRICE PAID BY PURCHASER FOR THE PRODUCT.

This Warranty is in lieu of all express warranties or liabilities. ANY IMPLIED WARRANTIES, INCLUDING ANY IMPLIED WARRANTY OF MERCHANTABILITY, SHALL BE LIMITED TO THE DURATION OF THIS WRITTEN WARRANTY. ANY ACTION FOR BREACH OF ANY WARRANTY HEREUNDER INCLUDING ANY IMPLIED WARRANTY OF MERCHANTABILITY MUST BE BROUGHT WITHIN THE PERIOD OF 90 DAYS FROM DATE OF ORIGINAL PURCHASE.

IN NO CASE SHALL THE COMPANY BE LIABLE FOR ANY CONSEQUENTIAL OR INCIDENTAL DAMAGES FOR BREACH OF THIS OR ANY OTHER WARRANTY, EXPRESS OR IMPLIED, WHATSOEVER. No person or representative is authorized to assume for the Company any liability other than expressed herein in connection with the sale of this product.

Some States do not allow limitations on how long an implied warranty lasts or the exclusion or limitation of incidental or consequential damage, so the above limitations may not apply to you. This warranty gives you specific legal rights and you may also have other rights which vary from state to state

For Technical Support/Warranty Information please call 310-762-9944

Smittybilt, 1600 Walnut Parkway, Rancho Dominguez, CA 90220