

INSTALLATION INSTRUCTIONS

WESTIN®

HDX GRILLE GUARD

APPLICATION:
2019 GMC Sierra 1500
PART NUMBER:
57-3965, 57-3960

1	1	HDX GRILLE GUARD ASSEMBLY	RATCHET
2,3	2	LOWER MOUNTING BRACKET—DRIVER & PASSENGER	10MM SOCKET
4,5	2	UPPER SUPPORT STRAP—DRIVER & PASSENGER	12MM SOCKET
6	2	LOWER SUPPORT BRACKET	16MM SOCKET
7	6	M12 HEX HEAD CAP SCREW SHORT (YELLOW ZINC)	18MM SOCKET
8	2	M12 HEX HEAD CAP SCREW LONG (YELLOW ZINC)	ALLEN WRENCH
9	8	M12 SPLIT LOCK WASHER (YELLOW ZINC)	TORQUE WRENCH
10	14	M12 FLAT WASHER SMALL (YELLOW ZINC)	FLAT HEAD SCREW-DRIVER
11	2	M12 FLAT WASHER LARGE (YELLOW ZINC)	
12	8	M12 HEX NUT (YELLOW ZINC)	CUTTING TOOL
13	2	M10 BUTTON HEAD BOLT (BLACK) (SS*)	
14	2	M10 BELLVILLE WASHER (BLACK) (SS*)	
15	2	M10 SERRATED FLANGE NUT (BLACK) (SS*)	
16	6	M12 BUTTON HEAD BOLT (BLACK) (SS*)	
17	6	M12 SERRATED FLANGE NUT (BLACK) (SS*)	
18	6	M12 BELLVILLE WASHER (BLACK) (SS*)	

***Raw Stainless Steel hardware is for polished stainless grille guards**

ANTI-SEIZE LUBRICANT MUST BE USED ON ALL STAINLESS STEEL FASTENERS TO PREVENT THREAD DAMAGE AND GALLING

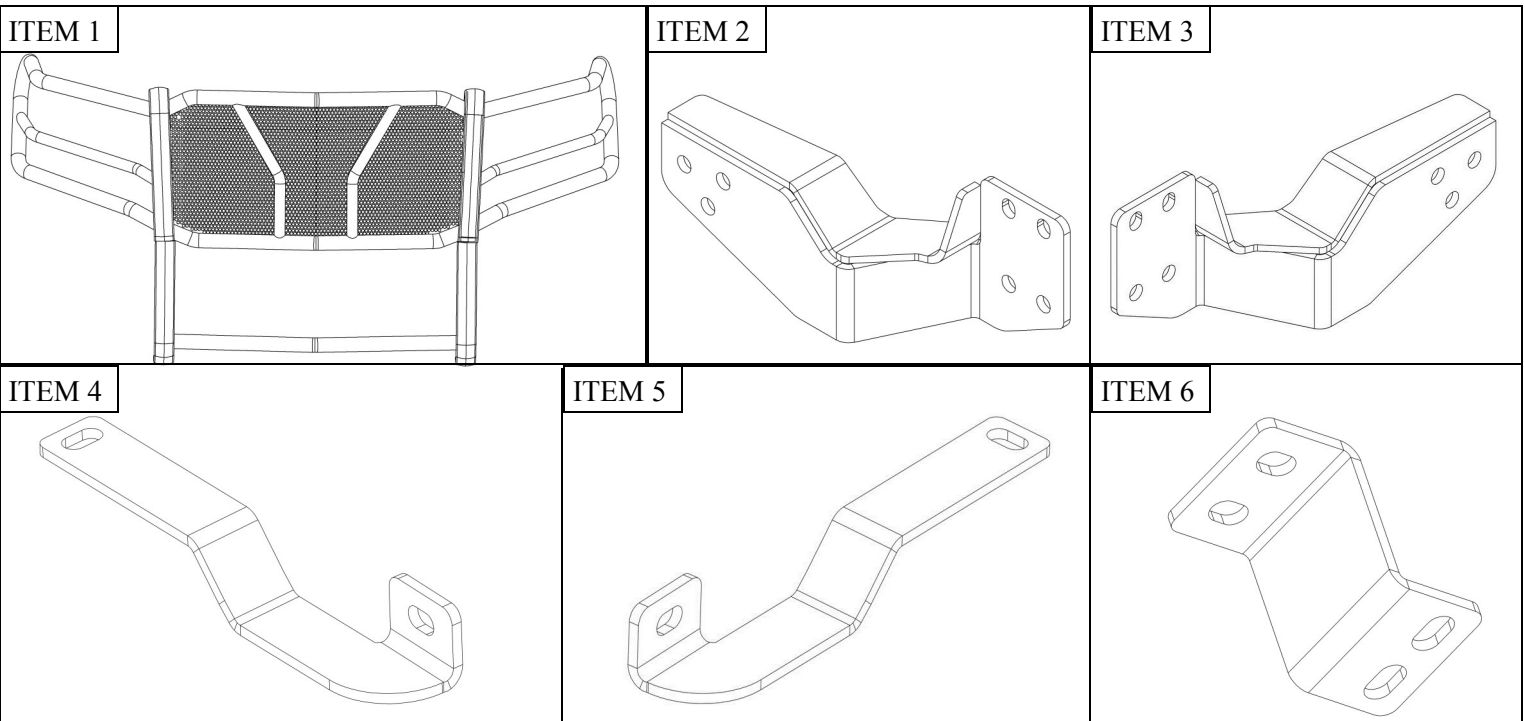

WESTIN Westin Automotive Products, Inc.
320 W. Covina Blvd
San Dimas, Ca. 91773

Thank you for choosing Westin products
for additional installation assistance please call
Customer Service (800) 793-7846
www.westinautomotive.com

PROCEDURE

1. Remove contents from box, verify if all parts listed are present and free from damage.
Carefully read and understand all instructions before attempting installation.
Failure to identify damage before installation could lead to a rejection of any claim.

2. Start by removing the fender trim on both sides. **See Figure 1.**
3. Remove the indicated bolt in **Figure 2** in order to remove the bumper trim.

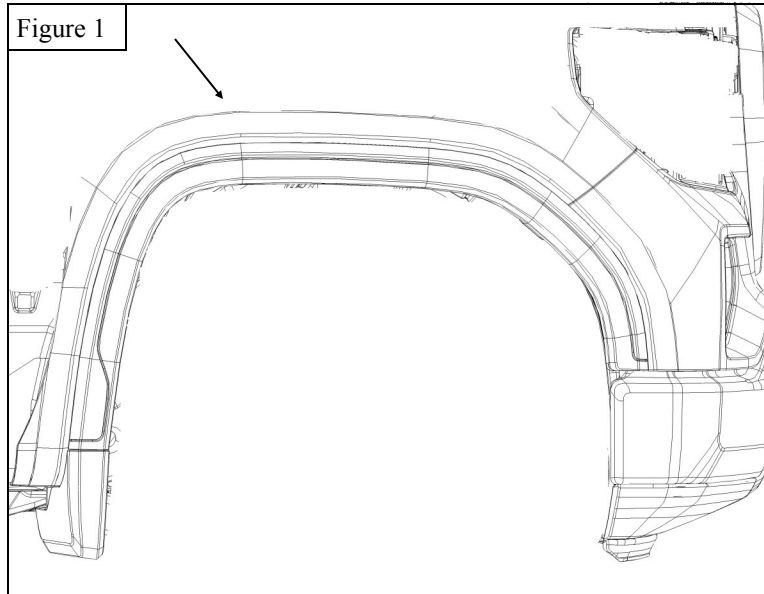

3. Remove the two screws from the inner fender trim as indicated in **Figures 3-4**
4. Using a trim removal tool or large flat head screwdriver, carefully pry on the bumper trim to pop out the retainer clips holding it on. Work your way to the middle starting from either side.

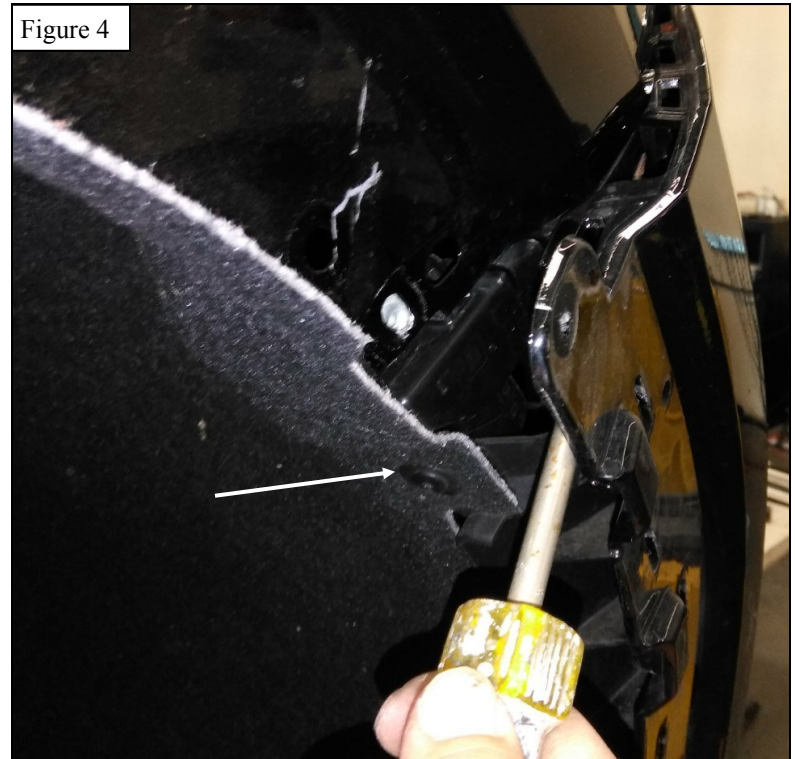

5. Moving to the front fog light pods, remove the bolt behind each pod, you will have to pry part of the rim to access this bolt.
6. Remove the center bolt holding on the bumper trim (above the front license plate area). **See Figure 5**
7. Then using a flat head screwdriver, pop out the remaining retainer clips. Remove the bumper trim. **See Figures 6-8**

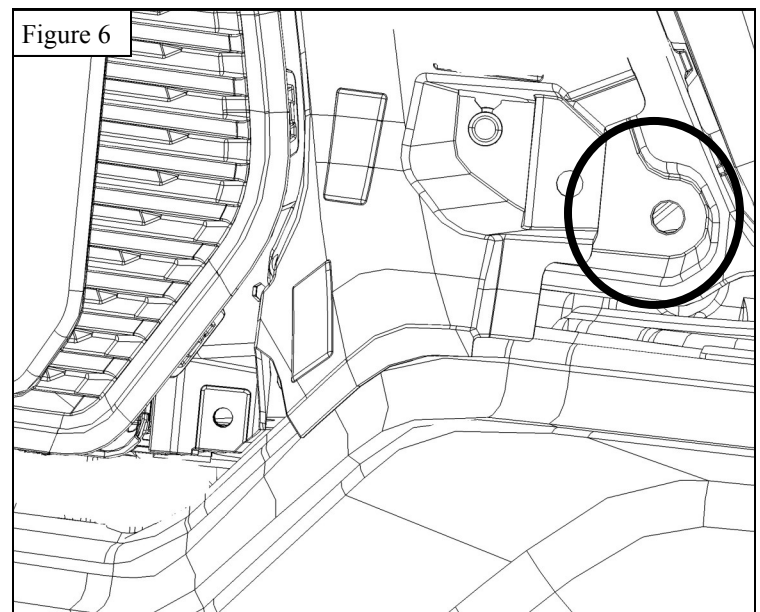
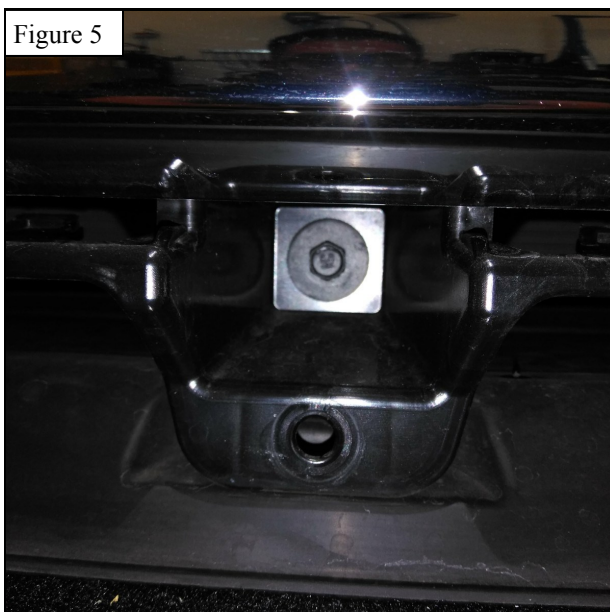

8. Remove the upper cover under the hood using a trim removal tool. There are multiple retainers that hold this piece on. See **Figure 9**.

Figure 7



Figure 8



9. Remove bolts attaching grille to vehicle. See **Figure 9**.
10. Pry grille wings of vehicle. See **Figure 10**.
11. Pry clip attaching the bottom of the grille to the vehicle. See **Figure 11**.

Figure 9



Figure 10



Figure 11

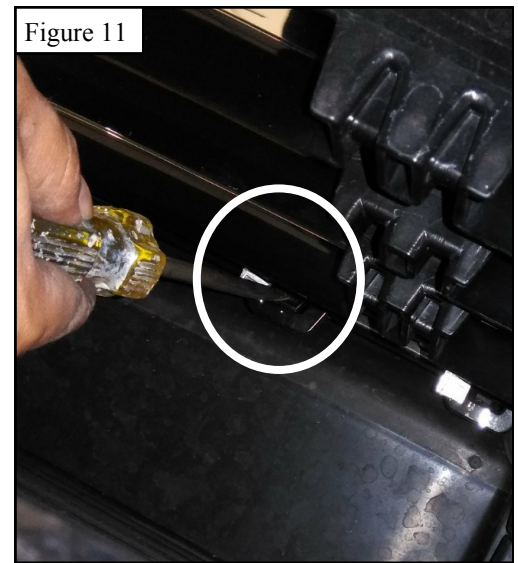

12. Remove the passenger bumper bolt as indicated in **Figure 12**. Slide the upper support strap in between the grille and bumper. Loosely install the upper support strap, reusing the factory bolt. Repeat on the driver side. **See Figures 12-13.**

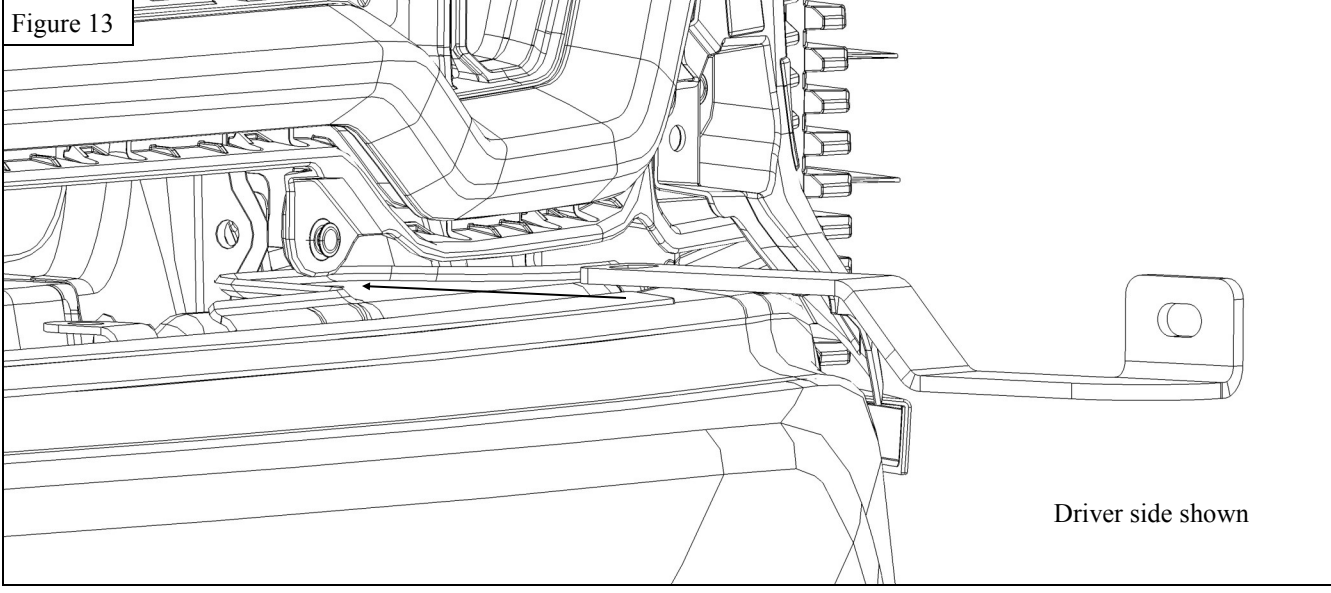
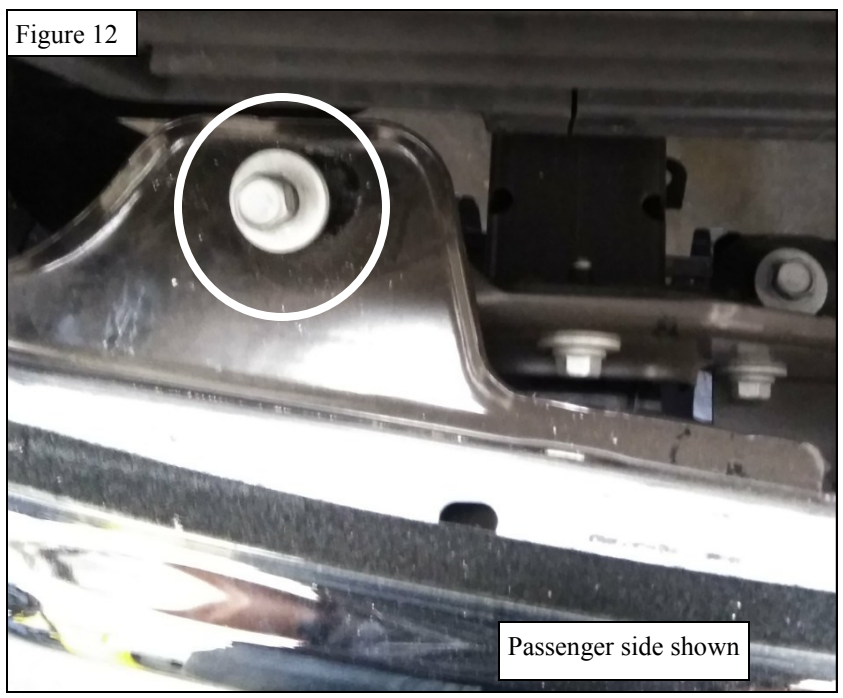

13. Measure from the outside face to the outer face of the other support bracket (where the brackets will meet the grille guard). Ensure that the measurement is 40.5 inches. Tighten down the factory bumper bolts. **See Figure 14**
14. Replace the bumper trim that was previously removed.

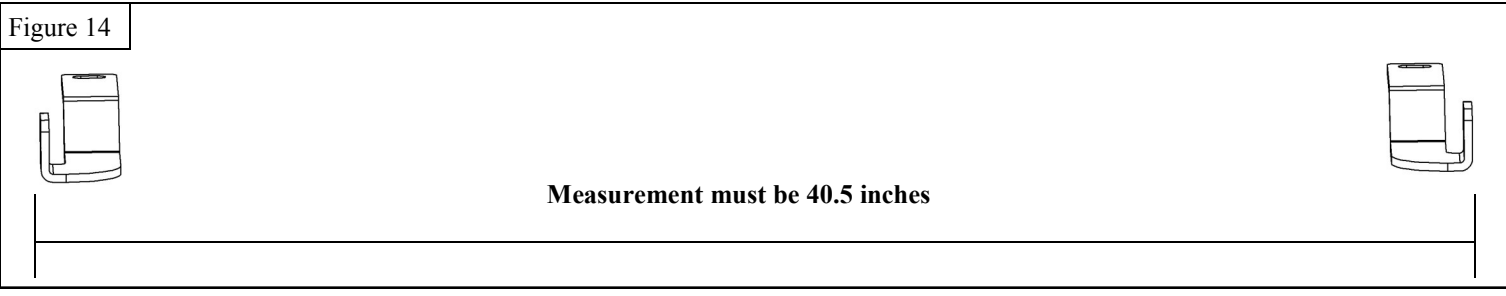

Note: Front Valence trimming will be required!

15. You will need to trim the valence around the light pod area. Using the diagrams below, cut out the area in order to clear-
ance the lower mounting bracket. Cut out the shape of the bracket with a little extra room using the dimensions from the
diagrams below.

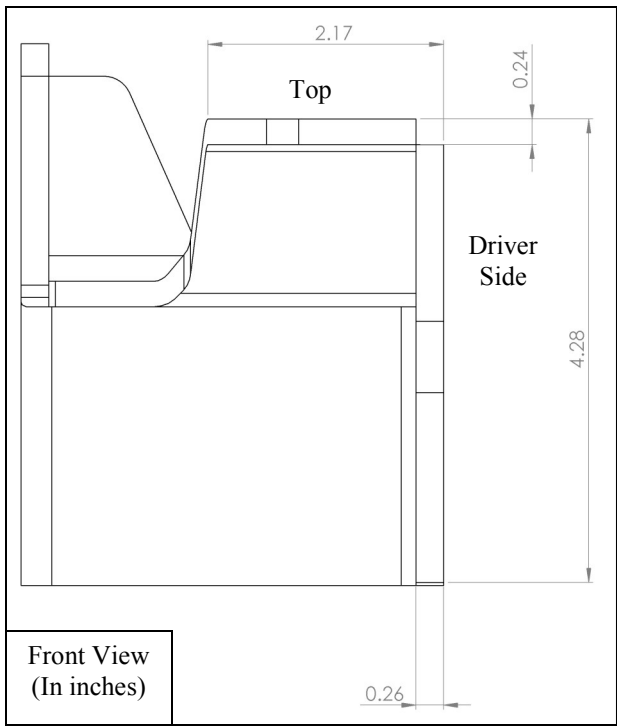
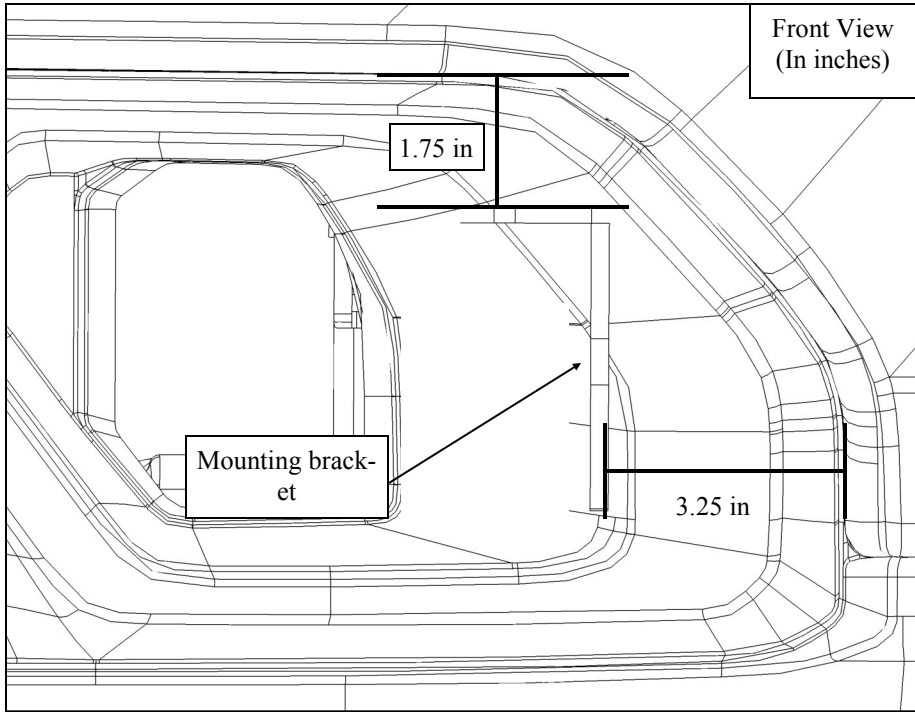

16. Using supplied M12 hardware, loosely install the lower mounting and support bracket on to each side of the frame. See Figure 13-14.

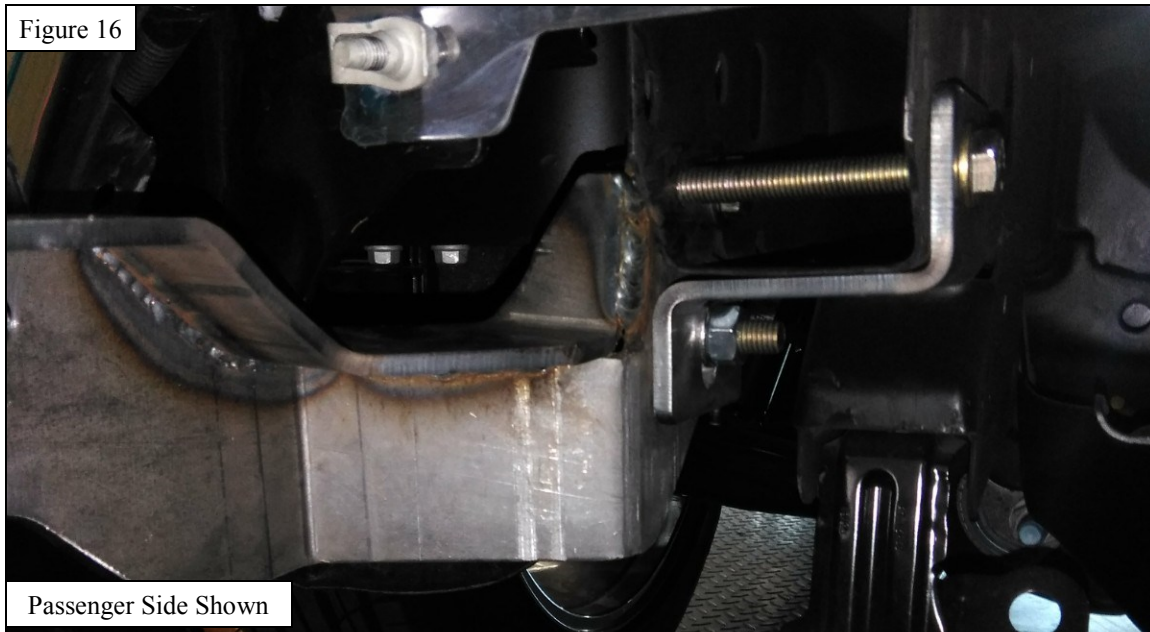
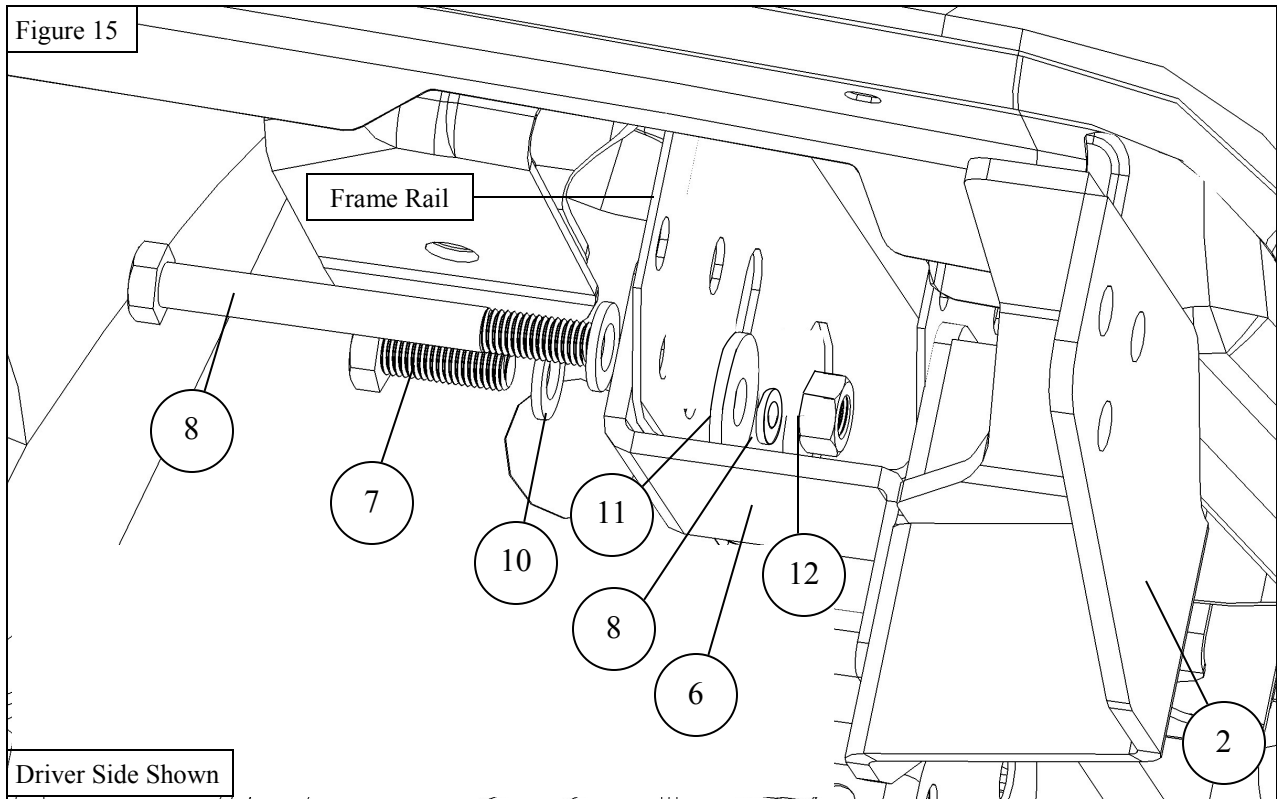

17. With help, loosely assemble the grille guard using supplied M10 and M12 hardware. **See Figure 15.**
18. Align Grille Guard as needed and then torque as specified: M10 to 35-40 ft-lbs and M12 to 55-60 ft-lbs.

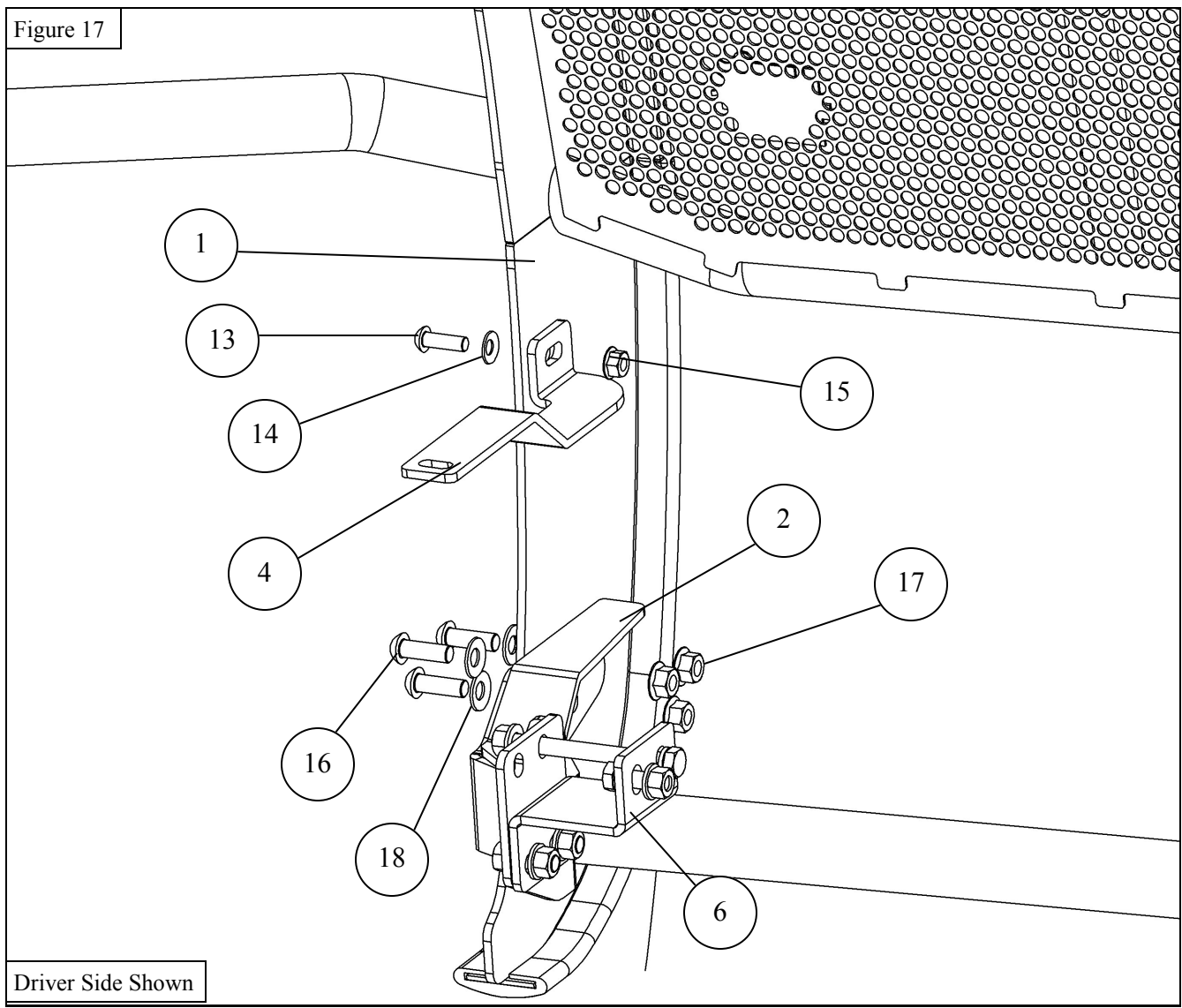

INSTALLATION COMPLETE



©2019 WESTIN AUTOMOTIVE PRODUCTS, INC. ALL RIGHTS RESERVED

CARE INSTRUCTIONS

- REGULAR WAXING IS RECOMMENDED. DO NOT USE ANY TYPE OF POLISH OR WAX THAT MAY CONTAIN ABRASIVES.
- STAINLESS STEEL PRODUCTS CAN BE CLEANED WITH MILD SOAP AND WATER. STAINLESS STEEL POLISH SHOULD BE USED TO POLISH SMALL SCRATCHES.
- GLOSS BLACK FINISHES SHOULD BE CLEANED WITH MILD SOAP AND WATER.

WESTIN Westin Automotive Products, Inc.
320 W. Covina Blvd
San Dimas, Ca. 91773

Thank you for choosing Westin products
for additional installation assistance please call
Customer Service (800) 793-7846
www.westinautomotive.com



WARNING



Failure to follow these instructions could lead to death, personal injury, and / or property damage.

Failure to follow these instructions could lead to death, personal injury, and / or property damage.

FASTENERS:

All Westin supplied fasteners must be utilized and installed in accordance with the installation instructions and apply torque to the specifications as defined. **DOUBLE CHECK ALL FASTENERS BEFORE INITIAL USE, AND PERIODICALLY IN THE FUTURE TO ENSURE PROPER FUNCTION AND SAFETY.**

DRILLING:

Most Westin products do not require drilling for installation. If drilling is defined as required, use caution when drilling a vehicle. **FAILURE TO REVIEW AN AREA TO BE DRILLED MAY RESULT IN PERSONAL INJURY AND/OR INJURY TO OTHERS AS WELL AS VEHICLE DAMAGE.**

EYE PROTECTION:

ALWAYS WEAR SAFETY GLASSES OR GOGGLES DURING THE INSTALLATION PROCESS TO AVOID PERSONAL INJURY.

MAXIMUM TOWING/CARRYING CAPACITY: (if applicable)

The Westin Receiver Hitches will have a visible tow rating label affixed directly on the product. User should never exceed the vehicle manufacturers maximum tow and weight rating regardless of the capacity of the hitch. **FAILURE TO FOLLOW THESE GUIDELINES WILL VOID THE WESTIN WARRANTY AND MAY RESULT IN PERSONAL INJURY AND/OR INJURY TO OTHERS AS WELL AS VEHICLE DAMAGE.**

FOR CALIFORNIA RESIDENTS ONLY-PROP 65 WARNING:

Some products may contain chemicals such as DEHP, which can cause cancer, birth defects or other reproductive harm. For more info go to www.p65warnings.ca.gov