

with Installation Instructions

Owner's Manual

Banks Ram-Air[®] Super-Scoop[®]

**2003-2007 Dodge 5.9L Cummins
Turbo-Diesel Pickups**
**2007-2009 Dodge 6.7L Cummins
Turbo-Diesel Pickups**

THIS MANUAL IS FOR USE WITH KITS 42190, 42191

Gale Banks Engineering
546 Duggan Avenue • Azusa, CA 91702
(626) 969-9600 • Fax (626) 334-1743

Product Information & Sales: (888) 635-4565
Customer Support: (888) 839-5600
Installation Support: (888) 839-2700

bankspower.com



Also Available from Banks Power

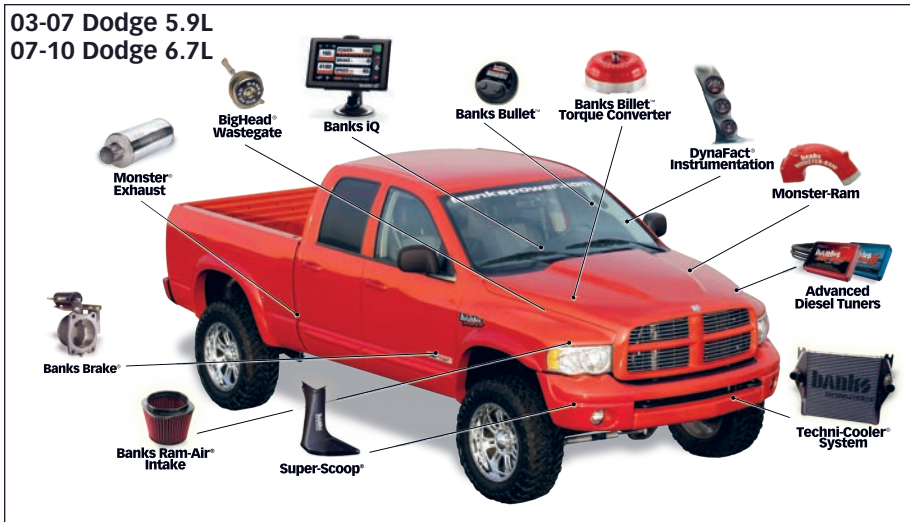

03-07 Dodge 5.9L
07-10 Dodge 6.7L

Banks iQ System

5.9L (P/N 61148-61149)

- 5" touchscreen interface that can control the Banks Diesel Tuner on the fly.
- Interchangeable gauge display, read and clear codes, monitor engine diagnostics, log data, time your vehicles runs and much more.

Banks Monster® Exhaust System

5.9L Single (P/N 48640-48643, 48700, 48701, 48708)

6.7L (P/N 49764)

5.9L Duals (P/N 48702-48707, 48709)

6.7L (P/N 49765-49767)

5.9L Sport (P/N 48777-48780)

- Increases exhaust flow, cuts backpressure, lowers exhaust gas temperatures (EGTs) and increases power

Banks Ram-Air Intake System

5.9L (P/N 42145)

6.7L (P/N 42175, 42180)

- Increases your airflow over stock.
- Adds power, improves fuel economy, lowers EGTs and reduces smoke.

Banks Monster-Ram

5.9L (P/N 42765-42766)

- Increased flow from intercooler
- Raises boost without increasing backpressure at the turbine

Big Hoss Intake Manifold System

5.9L (P/N 42747)

- Increases flow and provides more uniform air distribution to the engine for more available power at a given boost level.

Banks Techni-Cooler® System

5.9L (P/N 25980-25981)

6.7L (P/N 25983) 2009 (P/N 25985)

- Provides increased air flow to the engine by increasing air density for more increased power, lower EGTs and improved fuel economy.

Banks Exhaust Brake

5.9L (P/N 55222-55229)

- Increases the stopping power of your truck and extends the service life of your brakes

Banks SmartLock

5.9L (P/N 55270)

- Reduces wear on transmission
- Locks Torque Converter and raises trans-line pressure
- Works with Banks Exhaust Brake

Banks Billet Torque Converter

5.9L (P/N 72515)

- Higher torque capacity over stock
- Lockup clutch is slip-resistant so transmission fluids stay cooler and transmission life is prolonged

Banks Bullet

5.9L (P/N 66522-66523)

- Adds power safely to your vehicle
- Displays critical engine functions
- Engine safeguards
- Change power levels on-the-fly

Boost and Pyro Gauges

5.9L (P/N 64507)

- Keep your engine safe by monitoring vital engine parameters

Banks Diesel Tuner

EconoMind w/switch

5.9L (P/N 63725, 63793, 63795, 64507)

EconoMind w/iQ

5.9L (P/N 63807, 63808, 63817, 63818)

Six-Gun w/switch

5.9L (P/N 61022, 63797)

Six-Gun w/iQ 5.9L (P/N 63809, 63819)

- Adds power safely to your vehicle
- Engine and transmission safeguards
- Change power levels on-the-fly

Thermocouple

- Add a temperature limiting function to your Diesel Tuner

Banks BigHead® Actuator

5.9L (P/N 24331)

- Achieves a higher peak boost over stock and gives you precise boost control that gives you crisp acceleration and more mid-range pulling power

Banks Stinger Systems

5.9L (P/N 49692-49699, 49708-49711, 49716-49721)

Contains:

- Ram-Air Intake system
- Monster Exhaust (single or dual)
- EconoMind Tuner w/ Banks iQ
- Big Head Wastegate Actuator

Banks PowerPack Systems

5.9L (P/N 49700-49707, 49712-49715, 49722-49727)

Contains:

- Ram-Air Intake system
- Monster Exhaust (single or dual)
- EconoMind Tuner w/ Banks iQ
- Big Head Wastegate Actuator
- Monster-Ram
- Techni-Cooler System

Banks Six-Gun Bundle

5.9L (P/N 49728-49735, 49744-49747, 49752-49757)

Contains:

- Ram-Air Intake system
- Monster Exhaust (single or dual)
- Six-Gun Tuner w/ Banks iQ
- Big Head Wastegate Actuator

Banks Big Hoss Bundle

5.9L (P/N 49736-49743, 49748-49751, 49758-49763)

Contains:

- Ram-Air Intake system
- Monster Exhaust (single or dual)
- Six-Gun Tuner w/ Banks iQ
- Big Head Wastegate Actuator
- Monster-Ram
- Techni-Cooler System

**For More Information please call (888) 635-4565
or Visit us online @ www.bankspower.com**

General Installation Practices

Dear Customer,

If you have any questions concerning the installation of your Banks Ram-Air Super Scoop, please call our Technical Service Hotline at (888) 839-2700 between 7:00 am and 4:00 pm (PT). If you have any questions relating to shipping or billing, please contact our Customer Service Department at (888) 839-5600.

Thank you.

1. For ease of installation of your Banks Ram-Air Super-Scoop, familiarize yourself with the procedure by reading the entire manual before starting work. This manual contains 12 pages of copy, illustrations and parts listing. If any pages are missing from this manual please call Gale Banks Engineering immediately for a replacement.
2. The exploded view of the Ram-Air Super-Scoop assembly (pages 4-5) provides only general guidance. Refer to each step and section diagram in this manual for proper instruction.
3. Throughout this manual, the left side of the vehicle refers to the driver's side, and the right-side to the passenger's side.
4. Disconnect the ground cable from the battery before beginning work. If there are two batteries, disconnect both.
5. Route and tie wires and hoses a minimum of 6 inches away from exhaust heat, moving parts and sharp edges. Clearance of 8 inches or more is recommended where possible.

6. During installation, keep the work area clean. If foreign debris is transferred to any Banks system component, clean it thoroughly before installing.

7. When raising the vehicle, support it on properly weight-rated safety stands, ramps or a commercial hoist. Follow the manufacturer's safety precautions. Take care to balance the vehicle to prevent it from slipping or falling. When using ramps, be sure the front wheels are centered squarely on the topsides; put the transmission in park; set the parking brake; and place blocks behind the rear wheels.

Caution! Do not use floor jacks to support the vehicle while working under it. Do not raise the vehicle onto concrete blocks, masonry or any other item not intended specifically for this use.

Warning: This product is intended for general highway use. Do not use this product when fording streams or crossing bodies of water. Although this product is designed to separate water from entering the engine during normal highway driving in rainy conditions, it is not intended to be submerged under water for any amount of time. Regularly check the inlet of the Super-Scoop for any obstruction or debris that may impede the flow of air. After the installation of the Super-Scoop be aware of the decreased ride height and drive accordingly to avoid damage to the Super-Scoop. Regularly check to make sure the Super-Scoop is fastened securely and that all hardware and fasteners are tight and in good condition.

Tools Required:

- 3/8" drive ratchets with metric sockets
- Standard and Phillips head screwdrivers
- Standard and needle-nose pliers
- Clean shop towels or rags
- Electric Drill
- 1/8", 1/4" Drill bits
- 3/16" - 1/2" Step Drill bit

Table of Contents

Section 1 **6**
General Assembly

Section 2 **8**
Super-Scoop Installation

Section 1

GENERAL ASSEMBLY

Figure 1
System # 42190/42191 Shown

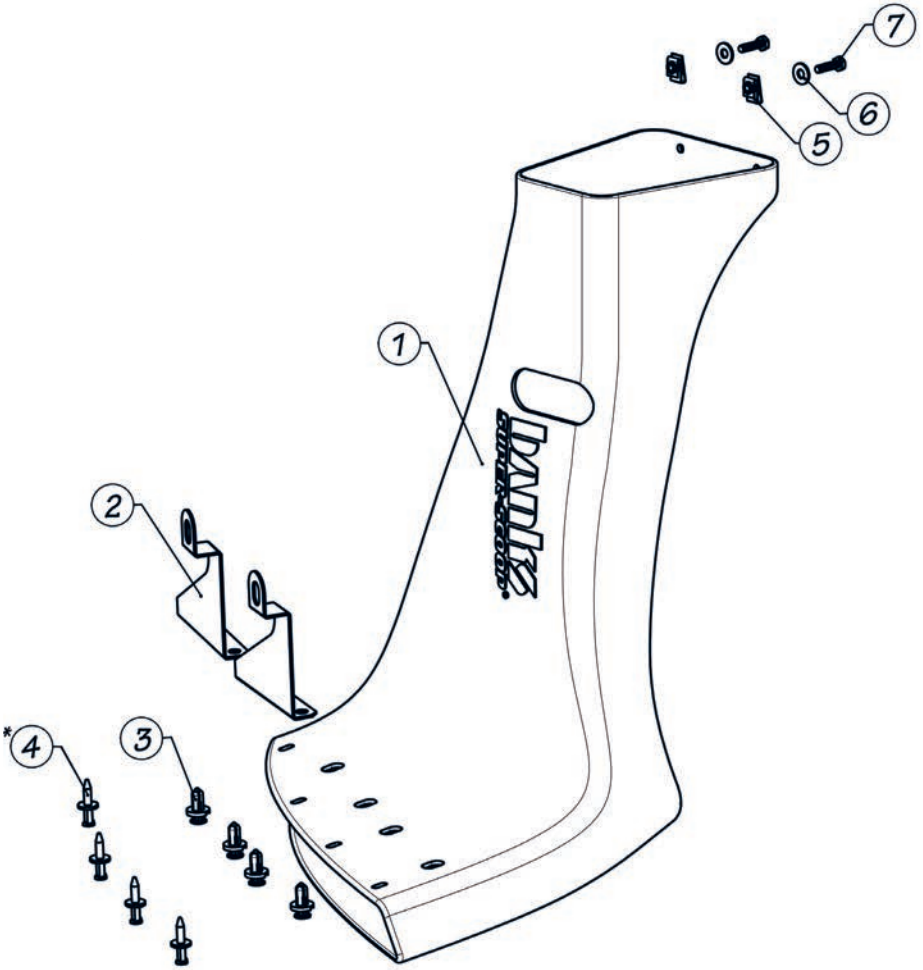

Item	Description	Part #	Qty.
1	SUPER-SCOOP, RAM-AIR SYSTEM, DODGE, 5.9L & 6.7L CUMMINS, STANDARD BUMPER	42192	1
	SUPER-SCOOP, RAM-AIR SYSTEM, DODGE, 5.9L CUMMINS, PAINTED BUMPER (5.9L 03-07)	42193	1
2	BRACKET, SUPER-SCOOP, STANDARD BUMPER	42194	2
	BRACKET, SUPER-SCOOP, PAINTED BUMPER (5.9L 03-07)	42195	2
3	RETAINER, PUSH-TYPE 20mm HEAD X 10mm DIA	92023	4
*4	RETAINER, PUSH-TYPE, 11/16 " HEAD X 1/4" DIA	92020	4
5	NUT, CLIP-ON, LOCKING, 6mm-1.00	91712	2
6	WASHER, USS, ZINC, 1/4	91103	2
7	HEX BOLT, GRADE 5, ZINC, 6mm-1.00 X 25mm	91742	2

* IS ONLY USED WITH THE STANDARD BUMPER SUPER-SCOOP (PART NO. 42190)

Note: For standard bumpers the bumper will be chrome around the factory fog lights opening. For Painted Bumpers the bumper is painted around the factory fog light opening.

Section 2

SUPER-SCOOP INSTALLATION

NOTE: Before installing the Banks Super-Scoop make sure to have a completely installed Banks Ram-Air Intake System in your vehicle.

1. Remove all Fasteners or plastic retainers attached to the fender lining then remove the wheel liner and set aside. See **Figure 2**

Note: Detach any wire harness clips from the fender well liner and secure them out of the way.

2. Locate supplied brackets and Banks Super-Scoop. Place the brackets on top of the Super-Scoop inlet over the slots. Note the location and direction of the bracket in **Figure 3**.

*Note: For standard bumper vehicles position the brackets over the larger slot on the Super-Scoop inlet. See **Figure 3**.*

3. Locate the supplied 20mm push-in retainers and insert them from the

inside of the Super-Scoop opening through the slots securing the brackets to the Super-Scoop. Push in the retaining pin to expand the retainer and fasten the Super-Scoop to the brackets. See **Figure 4**.

4. From under the vehicle on the passenger side locate the two (2) factory nuts attaching the bumper to the bumper support bracket, see **Figure 5**. Loosen and Remove the nuts, retain for reuse.

5. Install the Banks Super-Scoop from beneath the front bumper and place the Super-Scoop's opening over the bottom of the Banks Ram-Air housing down spout. If the bottom of the Banks air housing is sealed, see pages 8-9 of the Banks Ram-Air Intake Installation Manual. Insert the brackets over the frame bolts as shown in **Figure 6**. Re-install the factory nuts onto the factory bolts. Hand tighten the nuts at this time.

Figure 2 Removal of the passenger side wheel liner.

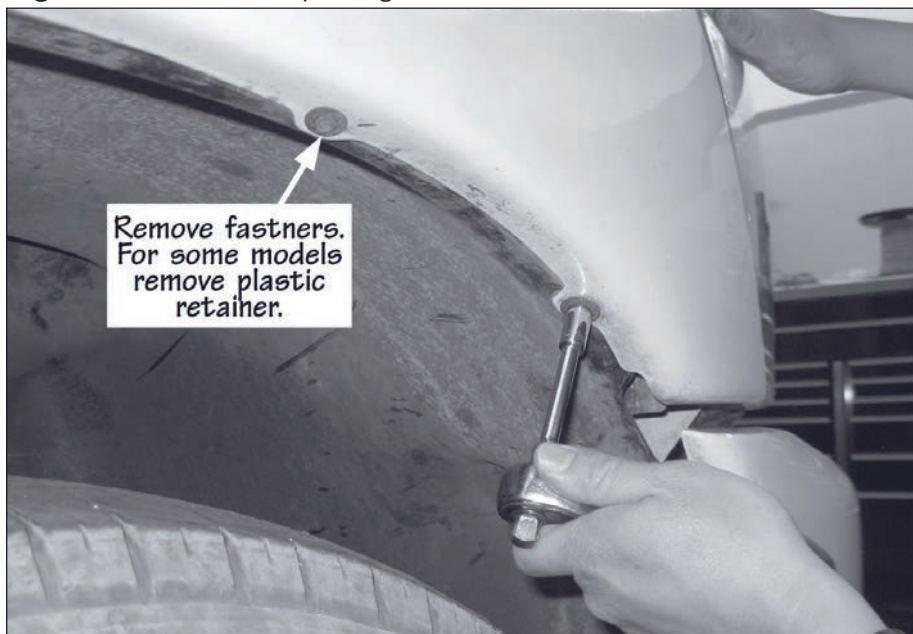

Figure 3 Installation of Super-Scoop Support Brackets



Figure 4

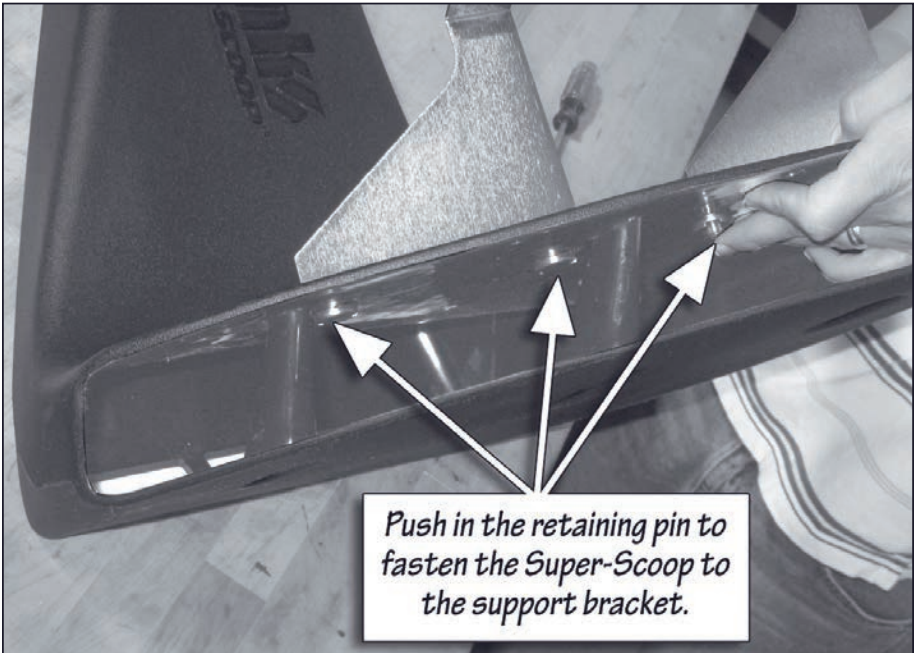

Figure 5 Remove Factory nuts

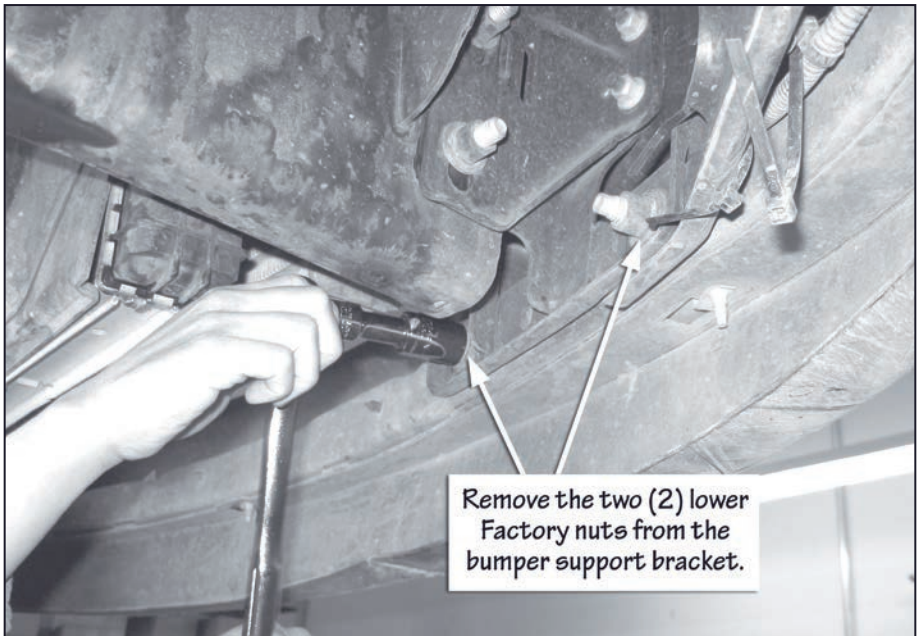

Figure 6 Install Super-Scoop support brackets over factory bolts



6. Lift up, align and fit the Banks Super-Scoop into position as far into the bottom of the Ram-Air housing down spout as possible. Using the two (2) holes on top of the Super-Scoop as a template, mark the Banks Ram-Air housing with a marker. See **Figure 7**.

7. Remove the Banks Ram-Air housing (reference Banks Ram-Air installation manual for removal). Center punch the location of the two (2) holes marked in the previous step then drill using a step drill to $\frac{5}{16}$ ".

*Note: Make sure the center of the holes are between $\frac{3}{8}$ "- $\frac{1}{2}$ " from the bottom edge of the housing. See **Figure 8**.*

8. Clean the holes and install the supplied clip-on-nuts over the holes.

Install the clip-on-nut so that the nut is on the inside of the Ram-Air housing. See **Figure 8**.

9. Re-install the Ram-Air housing following Banks Ram-Air installation manual. Make sure the Super-Scoop opening is over the bottom of the Bank's Ram-Air housing down spout. Lift the Super-Scoop into place and install the supplied $\frac{1}{4}$ " bolts and washers through the Super-Scoop holes attaching to the clip-on-nuts on the Ram-Air Housing. Hand tighten the bolts. See **Figure 9**.

10. Adjust the inlet of the Super-Scoop to fit the contour of the lower bumper.

Figure 7 Mark locations of holes on Ram-Air Housing.

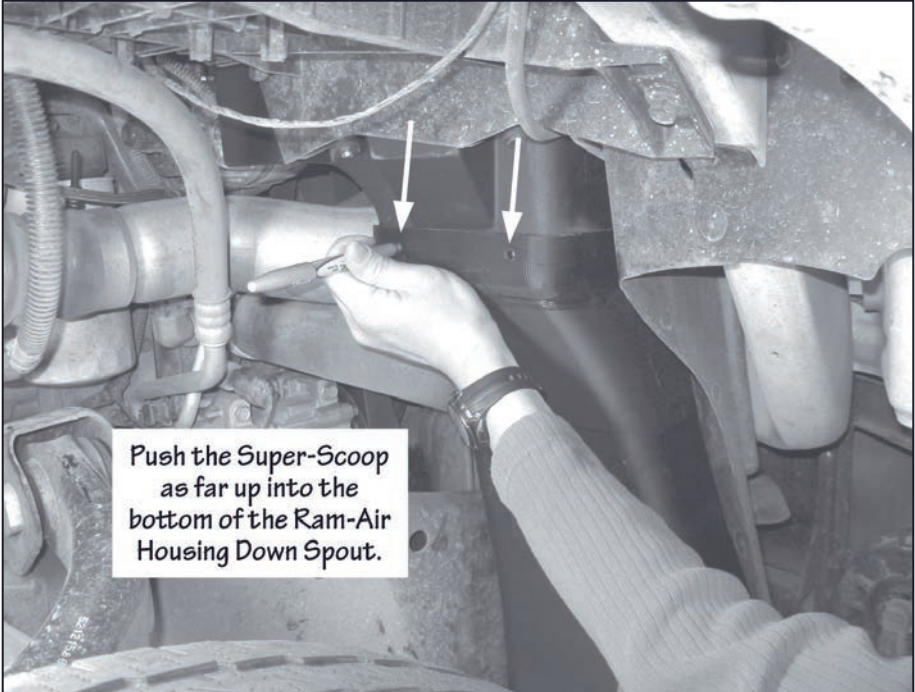

Figure 8 Drill marked holes in Ram-Air Housing.

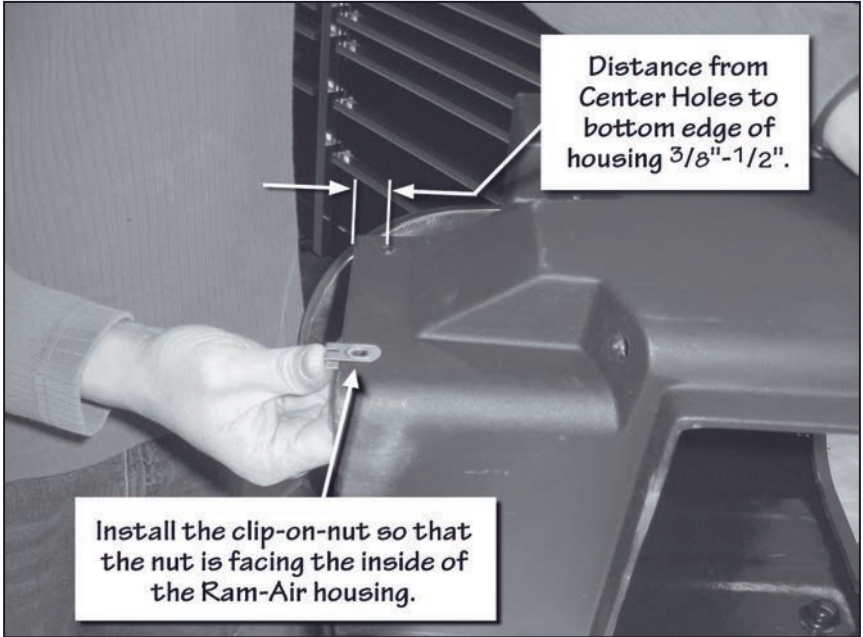
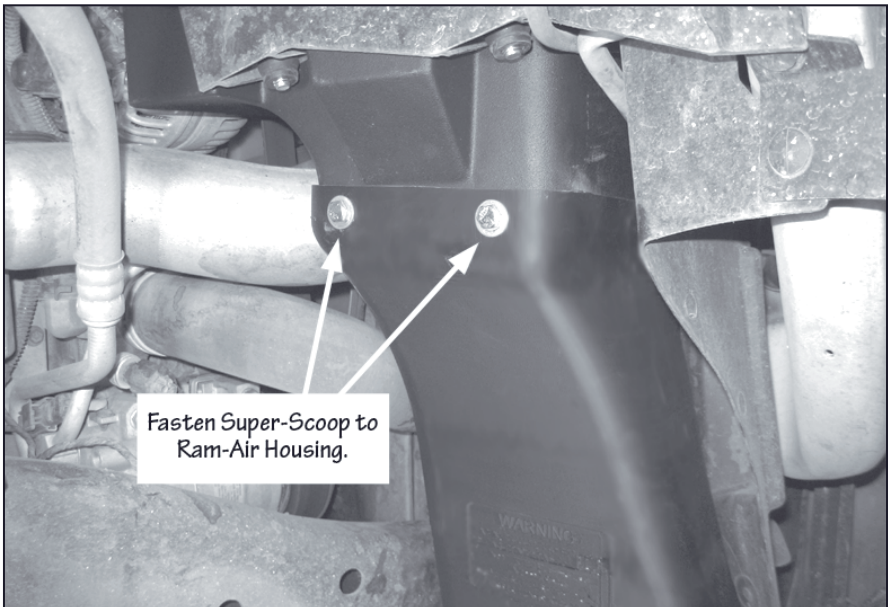

Figure 9 Secure Super-Scoop to Ram-Air Housing.



For Truck models with Painted Bumpers skip to Step 12.

For Trucks with Standard Bumpers

use the holes in front of the Banks Super-Scoop as a template to secure the Super-Scoop to the lower bumper. Center punch then drill the holes through the bumper. Use a 1/8" pilot drill first then finish off with a 1/4" drill. See **Figure 10**.

11. After drilling the lower bumper make sure to remove any debris and align the Super-Scoop to fit the contour of the bumper. Insert the supplied plastic retainers and push in the retaining pin to expand the retainer and fasten the Super-Scoop.

12. Now go back and tighten the factory Nuts attaching the Super-Scoop to the bumper support bracket

and the bolts attaching the Super-Scoop to the Ram-air housing.

Warning: if the Super-Scoop is not positioned properly it will interfere with the wheel or wheel well liner. Make sure there is adequate clearance between the Super-Scoop and wheel at all positions of the wheel. (Full steering and suspension travel).

13. Position the fender well liner into the wheel well. Attach the previously removed wire harness to the fender well liner. Install the fender well liner and secure it using the previously removed plastic retaining pins or fasteners.

14. You have now successfully installed the Banks Super-Scoop to your vehicle.

Figure 10 For Standard Bumper secure Super-Scoop to Lower Bumper



Notes

Notes

Gale Banks Engineering
546 Duggan Avenue • Azusa, CA 91702
(626) 969-9600 • Fax (626) 334-1743

Product Information & Sales: (888) 635-4565
Customer Support: (888) 839-5600
Installation Support: (888) 839-2700

bankspower.com