



**BX1648 Installation Instructions**  
**1999-03 Oldsmobile Alero**  
**1999-02 Pontiac Grand Am (Include GT)**  
**1997-05 Chevy Malibu (Include 2004-05 Classic)**  
**1998-03 Oldsmobile Cutlass (Not Supreme)**

Serial No.

The front fascia, horn bracket, headlight assemblies and windshield washer reservoir are removed for baseplate installation. Drilling is required. Trimming of fascia is required. The BX8869 is available for this vehicle. Attachment Tabs are 24 inches center to center and a height of 13 1/2 inches.



1. Remove the five push pins from the top side of fascia.



2. Just behind headlight assembly are two white clips, pull clips up, unplug electrical and remove headlight assembly, both sides.



3. Remove two metric bolts with the 10MM socket, just behind headlights on fascia corner, both sides.

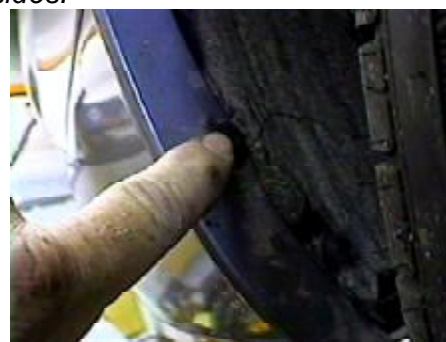

4. Forward of front tires, in wheel well, are two metric bolts to remove with the 7MM socket, both sides.



5. Remove eight metric bolts from the bottom side of the fascia with the 7MM socket and then remove five push pins. Pull fascia forward and set aside.



6. Using the 10MM socket, remove the metric bolt from horn bracket (black arrow), unplug and set aside.



Strong As An Ox™



7. Remove four metric bolts from wind shield washer reservoir, unplug hoses and electrical and set aside.



8. Slide baseplate on to frame to align with frame knob and reservoir bolt location on driver's side, clamp in place with vise grips. Set fascia in place, adjust baseplate to come through opening and remove fascia. Drill all holes with the 13/32" drill bit while assuring that the baseplate is level. Insert item 2 into frame to align with drilled holes, see white arrow in photo on step 6 and tighten items 4, 5 and 6 according to drawing on last page. **Do this to both sides. Be sure and use loctite on all bolts before tightening. Tighten all bolts according to torque chart in the General Instruction sheet. Be aware of coolant line on passenger's side. Slide baseplate forward for proper clearance.**

9. Reinstall horn and bracket and windshield washer reservoir. Use item 12 to replace upper reservoir and horn bracket metric bolts. Be sure all electrical lines and hoses are plugged in properly. Reinstall fascia trim as needed. **NOTE:** Trimming should only require a partial removal of one horizontal rib.
10. The dimensional variations between otherwise identical cars can be considerable. While the location and size of the holes in the baseplate were designed to allow for easy installation, it may be necessary to file a hole slightly to allow a bolt to clear.
11. Install the tow bar and safety cables according to the instructions included in their packages.
12. Do **not** substitute other devices if the tow bar pin and clip are lost.
13. **DEALER OR INSTALLER: BE CERTAIN THE USER RECEIVES THE INSTRUCTION SHEET.**





## Tools Required

9/16" Socket  
7MM Socket

Loctite  
10MM Socket

Vise Grips  
13/32" Drill Bit

## Parts List

Ref. No.	Qty.	Part No.	Description
1	1	61-5820	Weldment, Base Plate, BX1648
2	10	61-5208	3/8-16 Nut Plate
3	2	62-3469	Attachment, Assembly, SF/ LB (R)
4	2	201-0368	3/8-16 x 1 1/4 Bolt, Grd. 5, ZP
5	8	201-0440	3/8-16 x 1 1/2 Bolt, Grd. 5, ZP
6	10	203-0010	3/8 Lock Washer, ZP
7	2	201-0553	1/4-20 x 1/2 Hx. Wshd, Type F Screw
8	2	101-5822	Adapter, 4 Way Connector
9	2	201-0192	#10-32 x 1/2 Slot, Rd. Hd. Screw
10	2	203-0054	#10 Lock Washer
11	2	202-0047	#10-32 Hex Nut
12	2	201-0655	6MM-1 x 30MM Hex Bolt, Grd. 8.8(Not shown, replacement for horn bracket and washer reservoir)
	2	226-0046	Baseplate Safety Cable, 36" CL III (Not Shown)
	2	229-0359	Quicklink, 3/8, ZP (Not Shown)
	2	290-0437	Receiver Cap Plug, Blk (Not Shown)



*Location for the BX8869 on the passenger's side.*

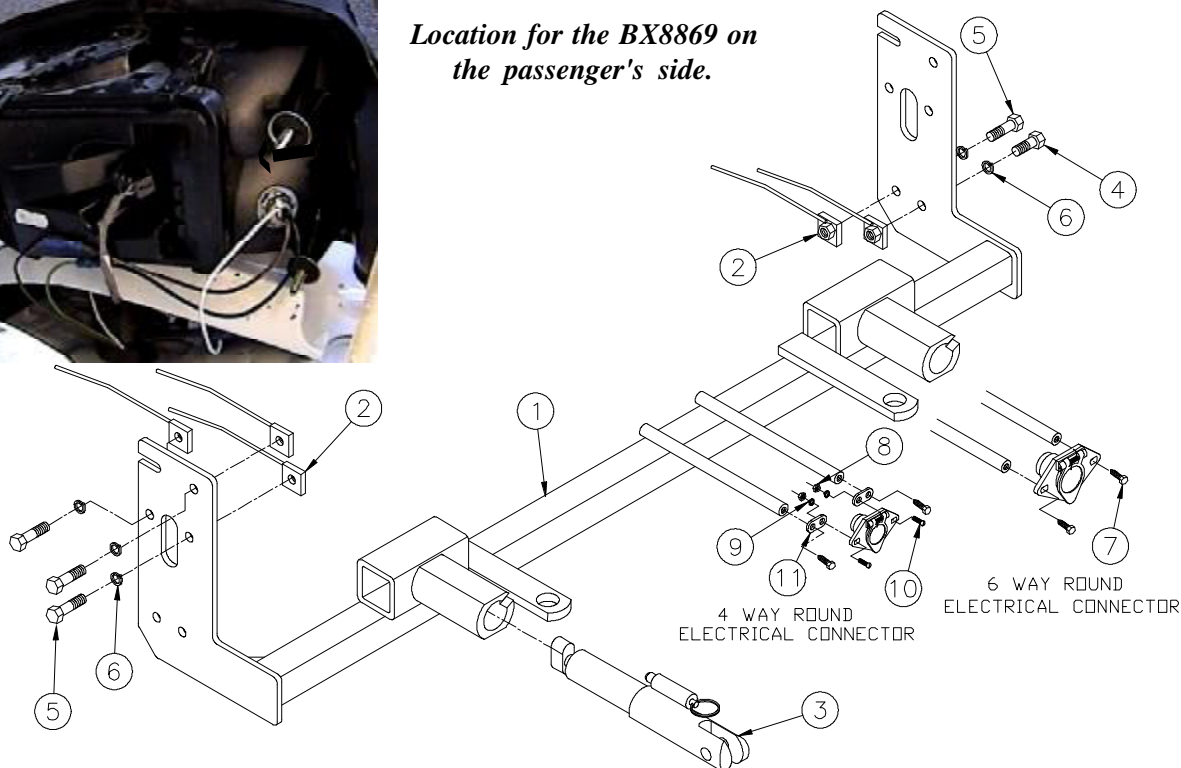

**IMPORTANT:** Use only genuine factory replacement parts on your Base Plate. Do not substitute homemade or nontypical parts. If a bolt is lost or in need of replacement, for your safety and the preservation of your Base Plate, be sure to use a replacement bolt of the same grade (Usually Grade 5, refer to parts list). Repair parts may be ordered through your nearest **Blue Ox** dealer or distributor.