

Serial Number

Please read **BOTH** these Installation Instructions and the General Towing Instructions before attempting to install or operate this equipment.

1. Blue Ox® towing products and accessories are intended to be installed by Blue Ox® Dealers who are familiar with our products and have the equipment and knowledge to do “fit work”. When necessary, Blue Ox® Dealers can be found at www.blueox.com or by contacting our Customer Care Department at (402) 385-3051.
2. Many Blue Ox® Baseplates are designed to use existing holes and hardware to mount the baseplate to the towed vehicle. Even though bolts are there, do not assume they are adequate for baseplate mounting. Always use hardware supplied in the hardware kit or existing hardware specified in the Baseplate Installation Instructions.

Attachment Tab Height: 15”
Attachment Tab Width: 24”

Bolt Torque Specifications
Torque in Foot-Pounds for Metric Bolts

Bolt Size	Grade 8.8	Grade 10.9
6MM	6	8
8MM	16	22
10MM	31	40
12MM	54	70
14MM	89	117

Confirm the towability and pre-towing procedures for your vehicle with the owner’s manual or contact the vehicle’s manufacturer for specific towing procedures.

Bolt Torque Specifications
Torque in Foot-Pounds for Inch Bolts

Bolt Size	Grade 5	Grade 8
1/4”	10	14
5/16”	19	29
3/8”	33	47
7/16”	54	78
1/2”	78	119
5/8”	154	230



If the front of your vehicle looks different than this, call us at (402) 385-3051.

⚠ WARNING
Failure to read and follow these instructions could result in separation of the towed vehicle from the tow bar, causing property damage, loss of towed vehicle, personal injury or death.

BX1975 2007-11 Dodge Caliber (No Sport) Installation Instructions

Parts List

Ref. No.	Qty.	Part #	Description
1	1	61-6316	Weldment, Base Plate, BX1975
2	3	61-5208	3/8" Nut Plate, with Wire
3	1	102-6753	Spacer, Driver's Side, BX1975
4	2	201-0443	3/8-16 x 1" Hex Bolt, Grd. 5, ZP
5	4	201-0440	3/8-16 1 1/2" Hex Bolt, Grd. 5, ZP
6	2	201-0404	3/8-16 x 1 3/4" Hex Bolt, Grd. 5, ZP
7	8	203-0010	3/8" Lock Washer, ZP
8	5	202-0003	3/8-16 Hex Nut, ZP
9	2	201-0553	1/4-20 x 1/2" Hx. Wshd. Type F Screw
10	2	201-0192	#10-32 x 1/2" Slot, Rd. Hd. Screw
11	2	203-0054	#10 Lock Washer
12	2	202-0047	#10-32 Hex Nut
13	2	101-5822	Adapter, 4 Way Connector
14	2	62-3468	Attachment, Assembly, SF/SB (R)
	2	226-0046	Permanent Baseplate Safety Cables, CL III (not shown)
	2	229-0359	3/8" Quick Link, ZP (not shown)
	2	290-0437	Cap Plug, Black (not shown)

Tools Required

7mm Socket	Flat Screwdriver
10mm Socket	Phillips Screwdriver
13mm Socket	Utility Knife
9/16" Socket	Hack Saw Blade
T-30 Torx Socket	1 1/4" Hole Saw
Vise Grips 13/32"	Drill Bit
Reciprocating Saw	Loctite® RED

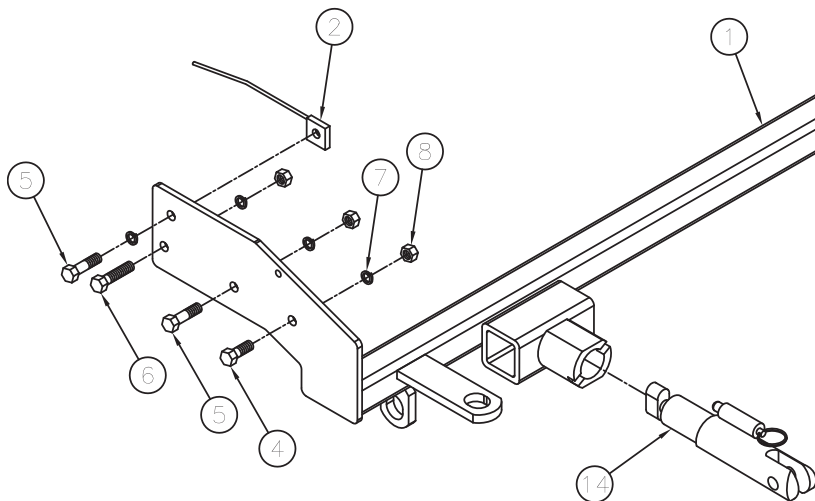
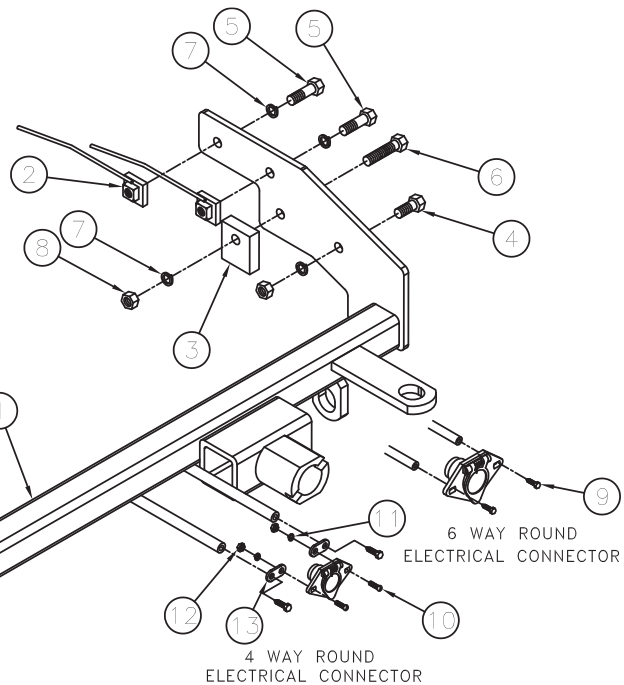

Important:

Use only genuine factory replacement parts on your baseplate. Do **NOT** substitute homemade or non-typical parts. If a bolt is lost or in need of replacement, for your safety and the preservation of your baseplate, be sure to use a replacement bolt of the same grade (In most cases it will be Grade 5, please reference the parts list above). Replacement parts may be ordered through your nearest Blue Ox® Dealer or Distributor. Failing to follow and/or altering these installation instructions in either installation or required equipment will void the manufacturer's warranty.

BX1975

2007-11 Dodge Caliber

(No Sport) Installation Instructions

Attachment Tabs:

Due to the design of the removable tabs, the RangeFinderII tow bar can not be used. Adapters, except the BX8833 and BX88151, can not be used with this baseplate.

Installation Notes: The fascia, horn, and wiring harness are removed for installation. Trimming of the metal bumper, frame webbing, and grille style is required. Drilling is required.

The dimensional variations between otherwise identical vehicles can be considerable. While the baseplate was designed for easy installation, it may be necessary to tailor the baseplate slightly to compensate for auto manufacturer's tolerances. These minor adjustments may include filing a hole slightly, bending electrical rods or bending end plates.

The BX8869 Bulb and Socket Wiring Kit is recommended for this vehicle.

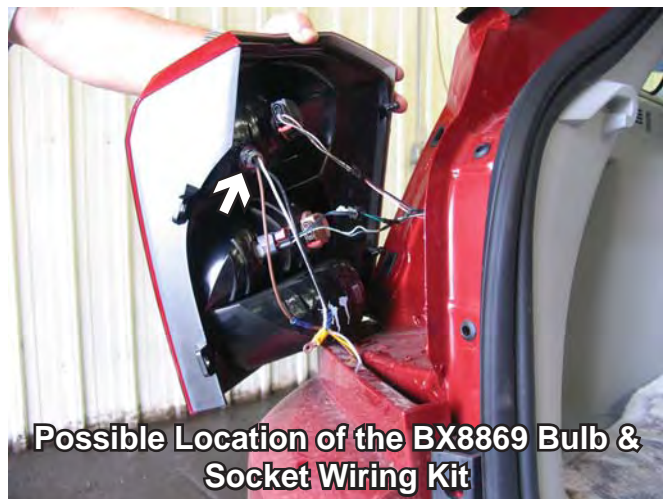

Handling of some cosmetic parts when installing this product may require the use of protective covers, rags, specialty tools, etc. to prevent damage.

Installation Instructions:

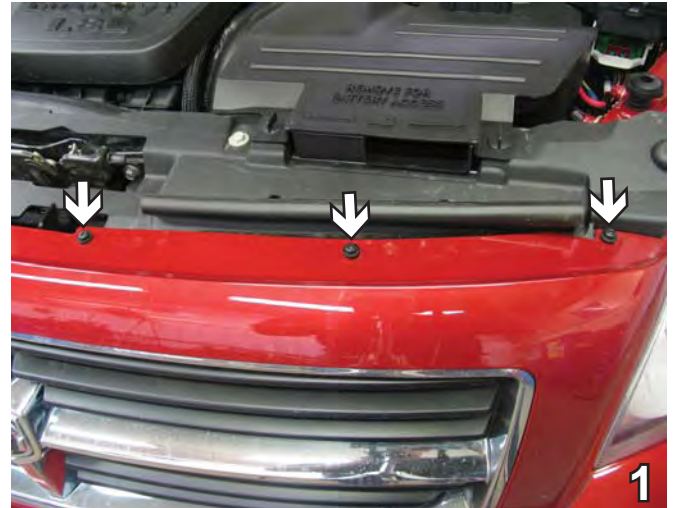

1. Remove three bolts from the top of the fascia using the 30-Torx socket. Do this to both sides of the vehicle. Set bolts aside to be reinstalled later.



2. Remove two metric bolts using the 7mm socket, just inside wheel well, on edge of fascia (see white arrows). Remove one pushpin just inside wheel well, on edge of fascia (see grey arrow). Do this to both sides of the vehicle. Set bolts and pushpins aside to be reinstalled later.

BX1975
2007-11 Dodge Caliber
(No Sport) Installation Instructions



3. Push wheel well cover aside to remove one metric bolt using the 7mm socket. Do this to both sides of the vehicle. Set bolts aside to be reinstalled later.



4. Remove two metric bolts just forward of the front tire, on the underside of fascia, using the 7mm socket. Do this to both sides of the vehicle. Set bolts aside to be reinstalled later.



5. Remove four pushpins from bottom of fascia. Do this to both sides of the vehicle. Pull fascia forward to remove. Set pushpins and fascia aside carefully to be reinstalled later.



6. Under the radiator, remove two metric bolts from the coolant tubing brackets using the 10mm socket. Set bolts aside to be reinstalled later.

BX1975
2007-11 Dodge Caliber
(No Sport) Installation Instructions



7. On the passenger's side, pry the coolant tubing clips from the side of the frame rail using a flat screwdriver. Move the tubing aside to clear the area for cutting.

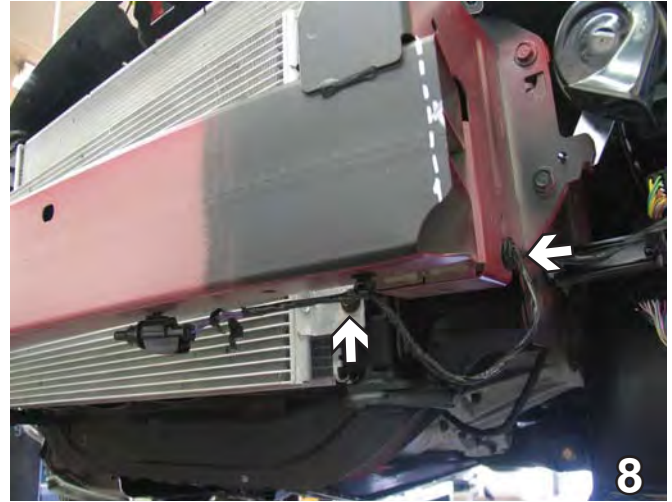

8. On the driver's side, disconnect sensor wire from the side of the frame and the bottom of metal bumper to clear area for cutting. Set sensor wire aside to be reinstalled later.



9. On the driver's side, press the clip on the horn cable to release it (see white arrow). Using the 10mm socket, remove the metric bolt from the bottom of the horn bracket (see upper grey arrow). Using the 13mm socket, remove the metric bolt from the lower wiring harness bracket (see lower grey arrow). Set the horn and bolts aside to be reinstalled later.



10. On the driver's side, use the 13mm socket to remove the metric bolt from the upper wiring harness bracket. Set wiring harness and bolt aside to be reinstalled later.

BX1975
2007-11 Dodge Caliber
(No Sport) Installation Instructions



11. Using the reciprocating saw, cut the end of the bumper so that it is flush with the frame. Do this to both sides of the vehicle.

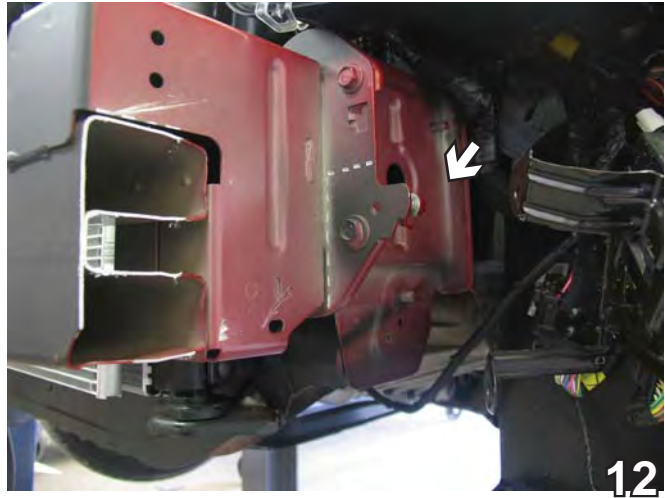

12. Using the reciprocating saw, start cutting 3/4" above the tab of the frame webbing. Cut horizontally until reaching the frame rail. Then, cut vertically until reaching the bottom of webbing. Do this to both sides of the vehicle.

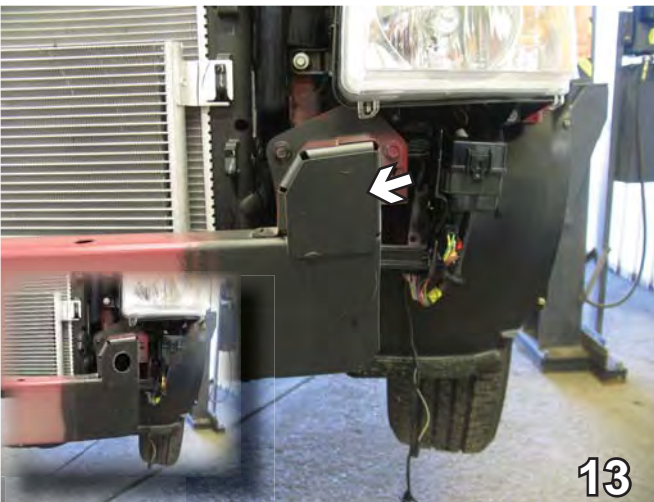

13. Using the 1 1/4" hole saw, drill into the front of the frame rail (to open an area to insert nut plates). Do this to both sides of the vehicle.

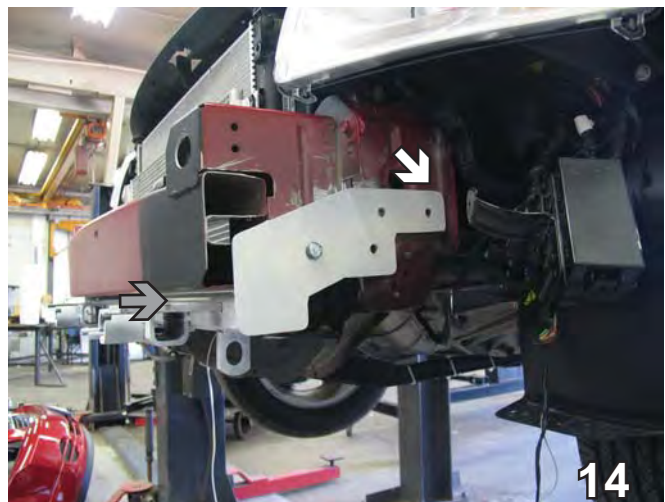

14. On the driver's side, slide baseplate against the side of frame rail with back of baseplate resting against the frame rail webbing (see white arrow). Baseplate crosstube will be 1/4" from bottom of the bumper (see grey arrow). Clamp in place using the vise grips. **Baseplate painted white for illustration. Actual baseplate will be powder-coat black.**

BX1975
2007-11 Dodge Caliber
(No Sport) Installation Instructions



15. Insure crosstube is parallel with bottom of bumper. Using the baseplate as a template, drill the front hole into frame with the 13/32" drill bit. Do this on both sides of the vehicle. On the driver's side, install 3/8-16 x 1 1/2" hex bolt with 3/8" lock washer and 3/8-16 hex nut and tighten. On the passenger's side, install 3/8-16 x 1" hex bolt with 3/8" lock washer and 3/8-16 hex nut and tighten.



16. On the driver's side, using the baseplate as a template, drill three remaining holes into frame rail with the 13/32" drill bit.

BE SURE TO USE LOCTITE® RED ON ALL BOLTS BEFORE TIGHTENING. TIGHTEN ALL BOLTS ACCORDING TO THE TORQUE CHART ON THE FRONT PAGE OF THESE INSTRUCTIONS OR ON PAGE 3 OF THE BASEPLATE TOWING GENERAL INSTRUCTIONS.

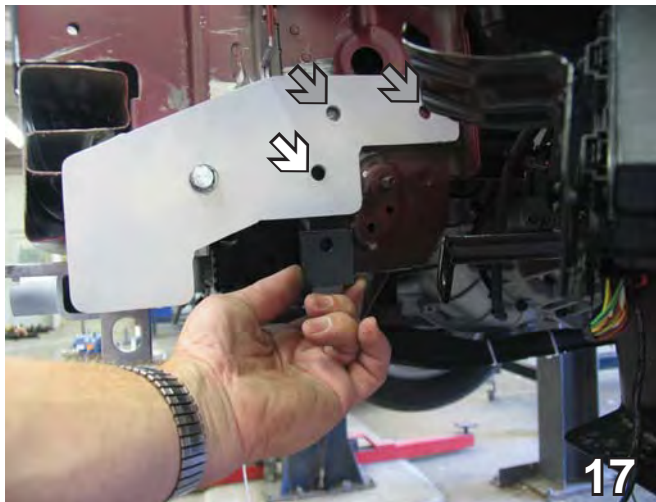

17. Align the spacer between frame and the lower middle hole of baseplate. Install the 3/8-16 x 1 3/4" hex bolt with 3/8" lock washer, 3/8-16 hex nut and tighten (see white arrow). Insert 3/8" nut plates through frame end and align to upper holes (see grey arrows). Install 3/8-16 x 1 1/2" hex bolts with 3/8" lock washers and tighten. Trim excess nut plate wires.

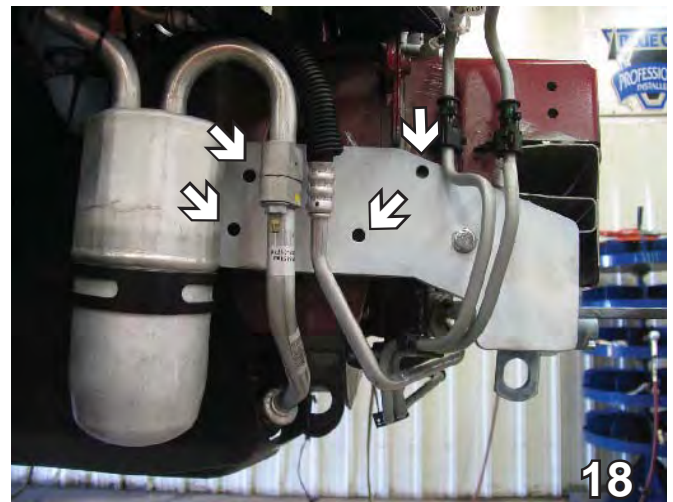

18. On the passenger's side, using the baseplate as a template, drill four holes into frame rail with the 13/32" drill bit. *Note: Cover the drill bit with a pipe to protect the coolant tubing while drilling.*

When using power drills be aware of the dangers of torque and drill bit length.

BX1975
2007-11 Dodge Caliber
(No Sport) Installation Instructions



19. On the passenger's side, insert 3/8" nut plate through frame end and align to rear upper hole. Install 3/8-16 x 1 1/2" hex bolt with 3/8" lock washer and tighten to nut plate. On lower back hole (see white arrow), install 3/8-16 x 1 3/4" hex bolt with 3/8" lock washer and 3/8-16 hex nut and tighten. On remaining lower hole (see grey arrow) install 3/8-16 x 1" hex bolt with 3/8" lock washer and 3/8-16 hex nut and tighten. Trim excess nut plate wire.



20. On the passenger's side, insert the coolant tube's clip into the front upper hole of the baseplate.

BE SURE TO USE LOCTITE® RED ON ALL BOLTS BEFORE TIGHTENING. TIGHTEN ALL BOLTS ACCORDING TO THE TORQUE CHART ON THE FRONT PAGE OF THESE INSTRUCTIONS OR ON PAGE 3 OF THE BASEPLATE TOWING GENERAL INSTRUCTIONS.

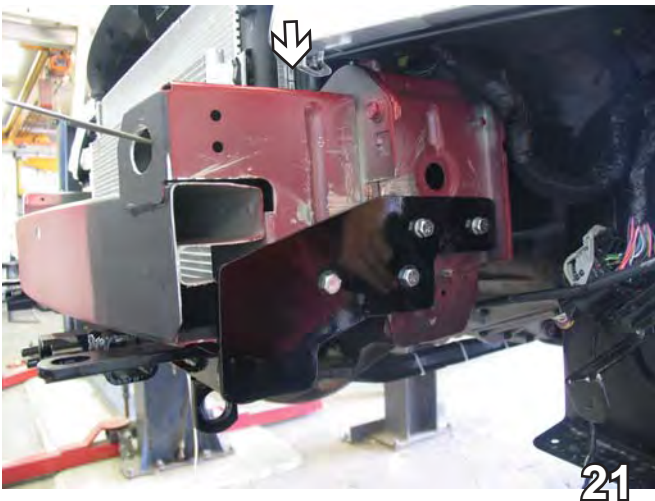

21. Relocate one end of the sensor wire to the existing hole on top of the frame (see white arrow). Attach the other end of sensor wire to original location under the metal bumper.



22. Remove the panels behind fascia (see inset). Align the fascia to its original position and, using the hack saw blade, trim necessary openings in the grille style for the attachment tabs. Do this to both sides of the vehicle. Fascia panels will not be reinstalled. Remove the fascia.

BX1975

2007-11 Dodge Caliber (No Sport) Installation Instructions



23. Attach the permanent baseplate safety cables to the provided convenience link on the baseplate (see white arrow). The photo above shows the recommended installation of the permanent baseplate safety cables to frame of the vehicle (see grey arrow). If the vehicle has additional options, not shown above, which interfere with mounting the permanent baseplate safety cables, secure the cable to a solid piece of the vehicle's frame as described in the instructions included with the permanent baseplate safety cables.

Be sure that **ALL** electrical connections are plugged in properly and functioning **BEFORE** installing the fascia.

24. Reinstall the wiring harness, horn, fascia, pushpins and bolts.

Install the tow bar and safety cables according to the instructions provided in their packages. When demonstrating this to the customer, be sure to include all the contents and packages.

Do **NOT** substitute other devices if the tow bar pins and clips are misplaced.

DEALER or INSTALLER:

Be certain the user receives the instruction sheets for their products.

BX1975
2007-11 Dodge Caliber
(No Sport) Installation Instructions



Shown without removable tabs installed.



Shown with removable tabs installed.

If the baseplate is in an accident, it must be replaced. DO NOT use it again! An accident can cause unseen damage and using it again could result in more damage or serious injury. DO NOT use the baseplate if it is damaged or missing parts.

CUSTOMER SERVICE COMMITMENT

Blue Ox is committed to providing you with exceptional customer care throughout your lifetime with our products. Our team is here to assist you with any questions you may have regarding the performance of your product. Simply call 1-402-385-3051 and you can speak with our customer care team.

Additionally, please visit our website to see which rallies our Destination America team will be attending. For a nominal fee, our service technician will service your towing system to ensure it's in proper working condition. Also as a commitment to our customers, should you visit our factory you can stay at our full service Blue Ox campground at no charge along with enjoying a factory tour.

Again thank you for being our customer and for the confidence you have shown in the performance of our products. It is because of customers like you we enjoy the success we have today.



© 2006, 07, 08, 09, 11 Blue Ox
One Mill Road, Industrial Park
Pender, Nebraska 68047
Phone: (402) 385-3051 • Fax: (402) 385-3360
www.blueox.com