



BX1676

07-12 Cadillac Escalade (Includes Hybrid)

07-13 Chevy Avalanche 1500

07-12 Chevy Suburban 1500

07-12 Chevy Tahoe 1500 (Not 09-11 Tahoe Hybrid)

07-12 GMC Yukon 1500 (Includes Denali)

Installation Instructions

Please read BOTH these Installation Instructions and the General Towing Instructions before attempting to install or operate this equipment.

Serial Number

1. Blue Ox® towing products and accessories are intended to be installed by Blue Ox® Dealers who are familiar with our products and have the equipment and knowledge to do “fit work.” When necessary, Blue Ox® Dealers can be found at www.blueox.com or by contacting our Customer Care Department at (402) 385-3051.

Attachment Tab Height: 17-1/4”

Attachment Tab Width: 31-1/4”

2. Many Blue Ox® Baseplates are designed to use existing holes and hardware to mount the baseplate to the towed vehicle. Even though bolts are there, do not assume they are adequate for baseplate mounting. Always use hardware supplied in the hardware kit or existing hardware specified in the Baseplate Towing Installation Instructions.

Bolt Torque Specifications

Torque in Foot-Pounds for Metric Bolts

Bolt Size	Grade 8.8	Grade 10.9
6MM	6	8
8MM	16	22
10MM	31	40
12MM	54	70
14MM	89	117

Confirm the towability and pre-towing procedures for your vehicle with the owner’s manual or contact the vehicle’s manufacturer for specific towing procedures.

Bolt Torque Specifications

Torque in Foot-Pounds for Inch Bolts

Bolt Size	Grade 5	Grade 8
1/4”	10	14
5/16”	19	29
3/8”	33	47
7/16”	54	78
1/2”	78	119
5/8”	154	230



If the front of your vehicle looks different than this, call us at (402) 385-3051.



WARNING

Failure to read and follow these instructions could result in separation of the towed vehicle from the tow bar, causing property damage, loss of towed vehicle, personal injury or death.

BX1676
 07-12 Cadillac Escalade (Includes Hybrid)
 07-13 Chevy Avalanche 1500
 07-12 Chevy Suburban 1500
 07-12 Chevy Tahoe 1500 (Not 09-11 Tahoe Hybrid)
 07-12 GMC Yukon 1500 (Includes Denali)
Installation Instructions

Parts List			
Ref. No.	Qty.	Part #	Description
1	2	61-6248	Weldment, Baseplate
2	1	102-6797	Convenience Link, 12", PS
3	1	102-6798	Convenience Link, 12", DS
4	4	201-0786	1/2-13 X 5" Hex Bolt, Grd. 5, ZP
5	4	203-0012	1/2" Lock Washer, ZP
6	4	202-0094	1/2-13 Hex Nylon Insert, Lock Nut, ZP
7	1	101-6135	Electrical Bracket, 90 Degree
8	6	201-0050	1/4-20 X 3/4" Hex Bolt, Grd. 5, ZP
9	4	203-0008	1/4" Lock Washer, ZP
10	4	203-0001	1/4" Flat Washer, ZP
11	4	202-0069	1/4-20 Hex Flange Whiz Lock Nut, ZP
12	2	201-0192	#10-32 X 1/2" Slot, Round Head Screw
13	2	203-0054	#10 Lock Washer
14	2	202-0047	#10-32 Hex Nut
15	2	101-5822	Adapter, 4 Way Connector
16	2	62-3468	Attachment, Assembly, SF/SB, 1 Hole
17	1	102-7056	Coolant Brkt, BX1689
18	2	202-0102	1/4-20 Hex Nyl Nut, ZP
	2	290-0437	Cap Plug, Black (Not Shown)
	2	229-0512	Quicklink, 1/2", ZP (Not Shown)
	2	226-0049	Baseplate Safety Cable, 36" Class IV (Not Shown)
	8	203-0005	1/2" Flat Washers (Not Shown)
	4	229-0536	6.3MM, Plastic Rivets (Not Shown)

Tools Required	
7MM Socket	Phillips Screw Driver
10MM Socket	Utility Knife
18MM Socket	Drill
21MM Socket	1 1/2" Hole Saw
7/16" Socket	1/4" Drill Bit
5/8" Wrench	1/2" Drill Bit
3/4" Socket & Wrench	17/32" Drill Bit
Loctite® RED	

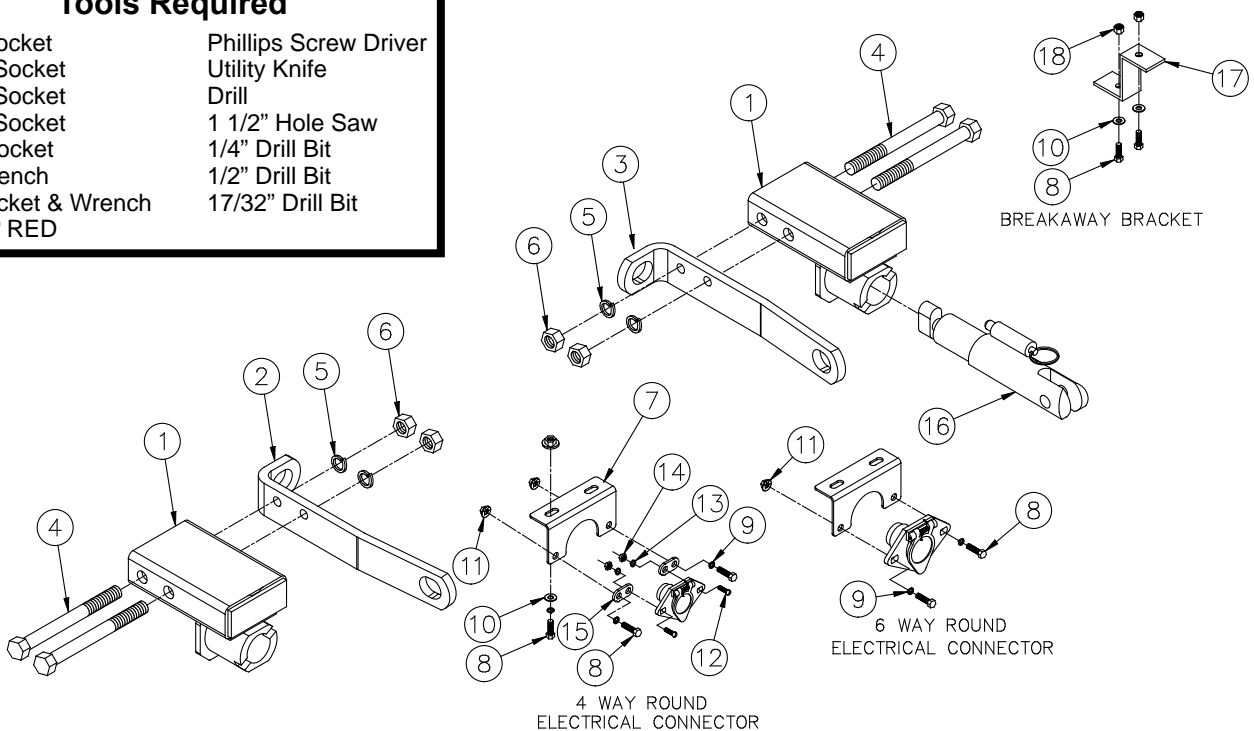

Important:

Use only genuine factory replacement parts on your baseplate. Do NOT substitute homemade or non-typical parts. If a bolt is lost or in need of replacement, for your safety and the preservation of your baseplate, be sure to use a replacement bolt of the same grade (In most cases it will be Grade 5, please reference the parts list above). Replacement parts may be ordered through your nearest Blue Ox® Dealer or Distributor. Failing to follow and/or altering these installation instructions in either installation or required equipment will void the manufacturer's warranty.

BX1676

07-12 Cadillac Escalade (Includes Hybrid)
07-13 Chevy Avalanche 1500
07-12 Chevy Suburban 1500
07-12 Chevy Tahoe 1500 (Not 09-11 Tahoe Hybrid)
07-12 GMC Yukon 1500 (Includes Denali)
Installation Instructions

Vehicle Weight: The weight of this vehicle is near the Class III, 5,000 lb. rating limitations. Some models, depending on options, may well exceed this 5,000 lb rating. Be sure to confirm the weight of your individual vehicle before towing. As of 1999 the Aventa® II is now 10,000 lbs. and either the Aventa® II or the Aventa® LX tow bar must be used for these applications.

Tow Bar Adapters are NOT to be used with vehicles weighing over 5,000 lbs.

Installation Notes: The fascia is removed and reinstalled during installation of the baseplate. Tow hooks are removed and not reinstalled. Drilling is required. Trimming of the fascia is required.

The dimensional variations between otherwise identical vehicles can be considerable. While the baseplate was designed for easy installation, it may be necessary to tailor the baseplate slightly to compensate for auto manufacturer's tolerances. These minor adjustments may include filing a hole slightly, bending electrical rods or bending end plates.

The BX8869 Bulb & Socket Wiring Kit is recommended for the Chevy Suburban 1500 and the GMC Yukon. **NOTE:** The BX8848 Diode Wiring Kit is recommended for the other vehicles.



1. **Cadillac Escalade:** Remove nine push pins from the cover on the top side of the fascia. Do this to both sides of the vehicle. Set push pins aside to be reinstalled later.

Do not use the towed vehicle for storing luggage, equipment, etc. This may cause you to exceed the towing capacity of the tow bar, baseplate, and its accessories.

Handling of some cosmetic parts when installing this product may require the use of protective covers, rags, specialty tools, etc. to prevent damage.

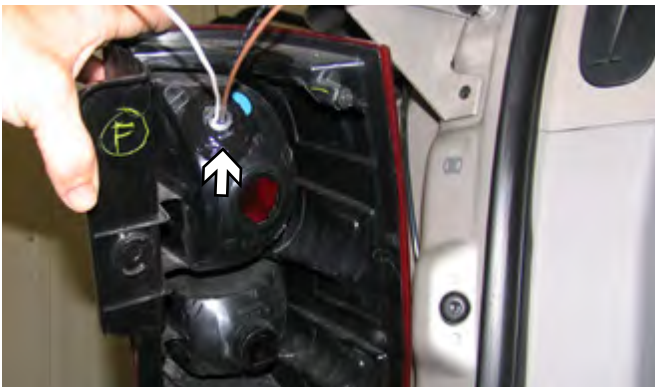

Chevy Suburban - Possible location for the Bulb and Socket Wiring Kit (BX8869).



GMC Yukon- Possible location for the Bulb and Socket Wiring Kit (BX8869).

The 4-Diode Wiring Kit (BX8848) is recommended for all other vehicles.

BX1676

07-12 Cadillac Escalade (Includes Hybrid)

07-13 Chevy Avalanche 1500

07-12 Chevy Suburban 1500

07-12 Chevy Tahoe 1500 (Not 09-11 Tahoe Hybrid)

07-12 GMC Yukon 1500 (Includes Denali)

Installation Instructions



2. **Cadillac Escalade & Chevy Avalanche:** Using a 10MM socket, remove three bolts from each side on top of the fascia. Do this to both sides of the vehicle. Set bolts aside to be reinstalled later.



2. **GMC Yukon:** Use a 10MM socket to remove three bolts (white arrows) from the top side of the fascia. Use a 7MM socket to remove the bolt second in from the edge (gray arrow). Do this to both sides of the vehicle. Set bolts aside to be reinstalled later.



3. **All Vehicles except Cadillac Escalade:** Using a 7MM socket, remove one metric bolt from the outside corner of the lower bumper support (see 3A). Using a 10MM socket, (a 7MM socket on the '09 GMC Yukon) remove two metric bolts from the front of the lower bumper support (see 3B). Do this to both sides of the vehicle. Set bolts aside to be reinstalled later.



4. **Cadillac Escalade & GMC Yukon:** Using a 7MM socket, remove two metric bolts (white arrows) from just forward of the front tire, inside the wheel well. Also remove the push pins (gray arrows). Do this to both sides of the vehicle. Pull fascia forward and set bolts, push pins and fascia aside carefully to be reinstalled later.

BX1676

07-12 Cadillac Escalade (Includes Hybrid)
07-13 Chevy Avalanche 1500
07-12 Chevy Suburban 1500
07-12 Chevy Tahoe 1500 (Not 09-11 Tahoe Hybrid)
07-12 GMC Yukon 1500 (Includes Denali)

Installation Instructions



4. **All Others:** Using a 7MM socket, remove one metric bolt (white arrow) from just forward of the front tire, inside the wheel well. Pop out two Christmas trees (gray arrows). Do this to both sides of the vehicle. Set bolts and trees aside to be reinstalled later. Pull the '07-'08 Chevy Avalanche fascia forward and set aside carefully to be reinstalled later.



5. **All Vehicles:** Using a 10MM socket, remove one metric bolt located right above the lower bumper support. Do this to both sides of the vehicle. Remove lower bumper support. Set bolts and lower bumper support aside to be reinstalled later.

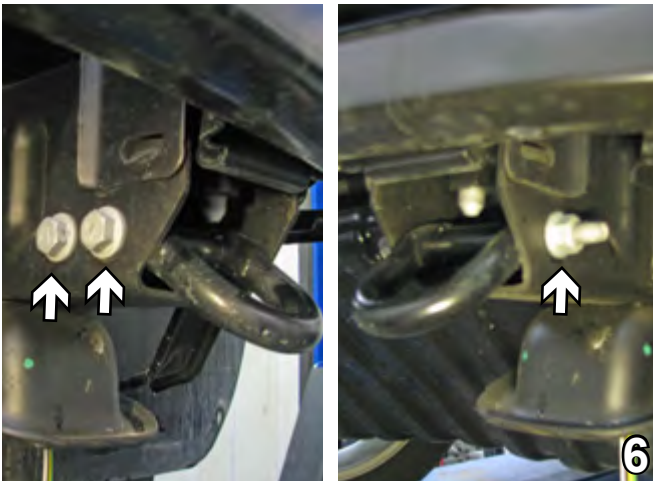

6. **All Vehicles:** Using a 18MM socket, remove two metric bolts from the outside edge of the frame rail and one nut from the inside edge of the frame rail. Pull the tow hook forward and remove it. Do this to the passengers side of the vehicle first. Please insure the tow hooks and all hardware are returned to customer, because they will not be reinstalled.



7. **Cadillac Escalade & GMC Yukon:** Use a 21MM socket, remove metric bolt from top of metal bumper. Reinstall with three 1/2" flat washers. **All Others:** With an 18MM socket, remove metric bolt from top of metal bumper on the passenger side first. This bolt will be reinstalled at a later time with three or four 1/2" flat washers.

BX1676

07-12 Cadillac Escalade (Includes Hybrid)
07-13 Chevy Avalanche 1500
07-12 Chevy Suburban 1500
07-12 Chevy Tahoe 1500 (Not 09-11 Tahoe Hybrid)
07-12 GMC Yukon 1500 (Includes Denali)
Installation Instructions



8. **All Vehicles:** Slide the baseplate into frame end to align with the two existing tow hook holes on the frame rail, passenger side first. Hold the convenient link to align with the front hole on the engine side of the frame and try to align back hole as close as possible. Then, insert a 1/2-13x5" hex bolt and 1/2" lock washer into front hole and tighten down with a 1/2-13 hex nylon lock nut. Be sure to use Loctite Red on all bolts before tightening.



9. **All Vehicles:** Using the existing back hole in frame and baseplate as a guide, drill a hole through the frame with the 17/32" drill bit. On the '09 Cadillac Escalade use a 1/2" drill bit. Insure the baseplate is level. Passenger side first.

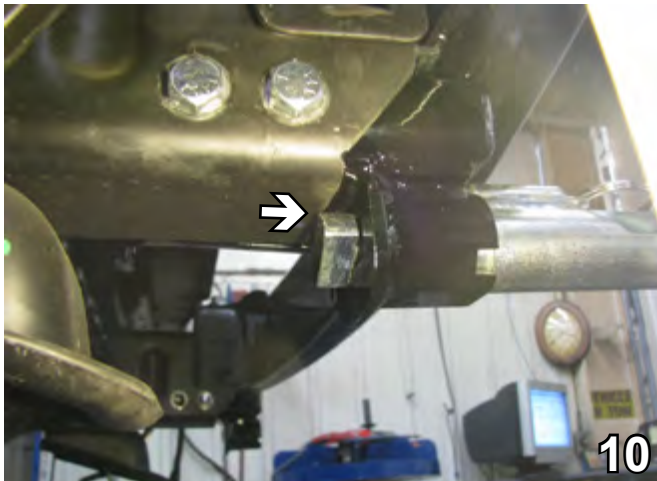

10. **All Vehicles:** If the back of the tab hits and won't turn, take a hammer and pound the frame up.



11. **All Vehicles:** Install the remaining 1/2-13 x 5" hex bolt and nylon lock hex nuts on passenger's side. **All Others:** Reinstall metric bolt in to top of metal bumper using three or four 1/2" flat washers as needed to give baseplate enough clearance. This may differ between vehicle models. (Refer to step 6.)

BE SURE TO USE LOCTITE® RED ON ALL BOLTS BEFORE TIGHTENING. TIGHTEN ALL BOLTS ACCORDING TO THE TORQUE CHART ON THE FRONT PAGE OF THESE INSTRUCTIONS OR ON PAGE 3 OF THE BASEPLATE TOWING GENERAL INSTRUCTIONS.

When using power drills be aware of the dangers of torque and drill bit length.

BX1676
07-12 Cadillac Escalade (Includes Hybrid)
07-13 Chevy Avalanche 1500
07-12 Chevy Suburban 1500
07-12 Chevy Tahoe 1500 (Not 09-11 Tahoe Hybrid)
07-12 GMC Yukon 1500 (Includes Denali)
Installation Instructions



12. **All Vehicles:** Attach the permanent baseplate safety cables to a solid piece of the vehicle frame, which are described in the instructions, included with the permanent baseplate safety cables. Be sure the safety cables do not rub against any hoses or moving parts.
13. **All Vehicles:** Repeat steps 5-10 on driver's side.
14. **All Vehicles:** Reinstall the fascia and the lower bumper support.

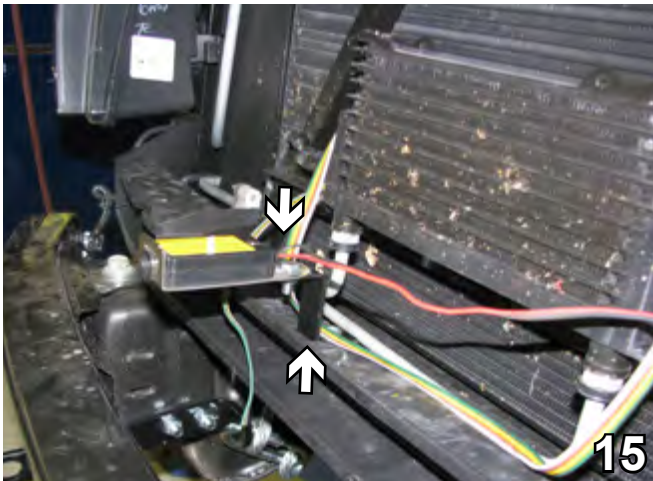

15. **All Vehicles:** Attach the coolant bracket for use with the breakaway to the cross member. Use 1/4-20 x 3/4" hex bolt, with 1/4" flat washer and 1/4-20 hex nut.



16. **All Vehicles:** Using a utility knife, trim out the tow hook shield by following the seam all the way around (see photo above for template). Do this to both sides of the vehicle.

BX1676

- 07-12 Cadillac Escalade (Includes Hybrid)
 - 07-13 Chevy Avalanche 1500
 - 07-12 Chevy Suburban 1500
 - 07-12 Chevy Tahoe 1500 (Not 09-11 Tahoe Hybrid)
 - 07-12 GMC Yukon 1500 (Includes Denali)
- Installation Instructions



17. **Cadillac Escalade:** Hold the fascia in place, mark it on each side of the baseplate and cut the top of the tow hook opening so that the fascia will go back a little farther. Do this to both sides of the vehicle.



18. **Cadillac Escalade:** On the front of the car after the baseplate is installed, drill out the pop rivets on the license plate bracket with a 3/16" drill bit and replace them with plastic pop rivets.

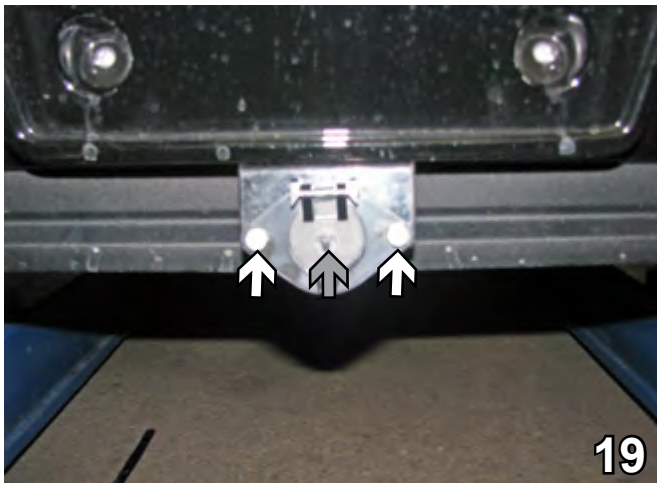

19. **Cadillac Escalade:** Center the bracket and use as a template to drill with a 1" hole saw into the lower fascia (gray arrow) for the wire to go through. Attach the electrical bracket to the bottom of the license plate bracket with 1/4-20 x 3/4" hex bolts (white arrows), 1/4" lock washers and 1/4-20 whiz nuts.



20. **All Others:** The photo to the left shows the recommended location of the electrical connector.

Be sure that ALL electrical connections are plugged in properly and functioning BEFORE installing the fascia.

DEALER or INSTALLER:
Be certain the user receives the instruction sheets for their products.

Install the tow bar and safety cables according to the instructions provided in their packages. When demonstrating this to the customer, be sure to include all the contents and packages.

Do **NOT** substitute other devices if the tow bar pins and clips are misplaced.

BX1676

07-12 Cadillac Escalade (Includes Hybrid)
07-13 Chevy Avalanche 1500
07-12 Chevy Suburban 1500
07-12 Chevy Tahoe 1500 (Not 09-11 Tahoe Hybrid)
07-12 GMC Yukon 1500 (Includes Denali)
Installation Instructions



2007 Chevy Suburban shown with removable tabs installed.



2008 Chevy Avalanche shown with removable tabs installed.



2009 GMC Yukon shown with removable tabs installed.



2009 Cadillac Escalade shown with removable tabs installed.

CUSTOMER SERVICE COMMITMENT

Blue Ox is committed to providing you with exceptional customer care throughout your lifetime with our products. Our team is here to assist you with any questions you may have regarding the performance of your product. Simply call (402) 385-3051 and you can speak with our customer care team.

Additionally, please visit our website to see which rallies our Destination America team will be attending. For a nominal fee, our service technician will service your towing system to ensure it's in proper working condition. Also, as a commitment to our customers, should you visit our factory, you can stay at our full service Blue Ox campground at no charge along with enjoying a factory tour.

Again thank you for being our customer and for the confidence you have shown in the performance of our products. It is because of customers like you we enjoy the success we have today.

If the baseplate is in an accident, it must be replaced. DO NOT use it again! An accident can cause unseen damage and using it again could result in more damage or serious injury. DO NOT use the baseplate if it is damaged or missing parts.



© 2011 Blue Ox
One Mill Road, Industrial Park
Pender, Nebraska 68047
Phone: (402) 385-3051
Fax: (402) 385-3360
www.blueox.com