

## 2006-2008 Dodge 1500-3500 Installation Part # 200-40-6005, XGG Part # 700-40-6005

Bolt Bag Contents:	
Quantity	Description
12	1/2" Flat Washers
6	1/2" Hex Nuts
6	1/2" Lock Washer
4	1/2" X 1-3/4" Bolts
2	1/2" X 2 1/4" bolts
30	<b>Total Pieces</b>

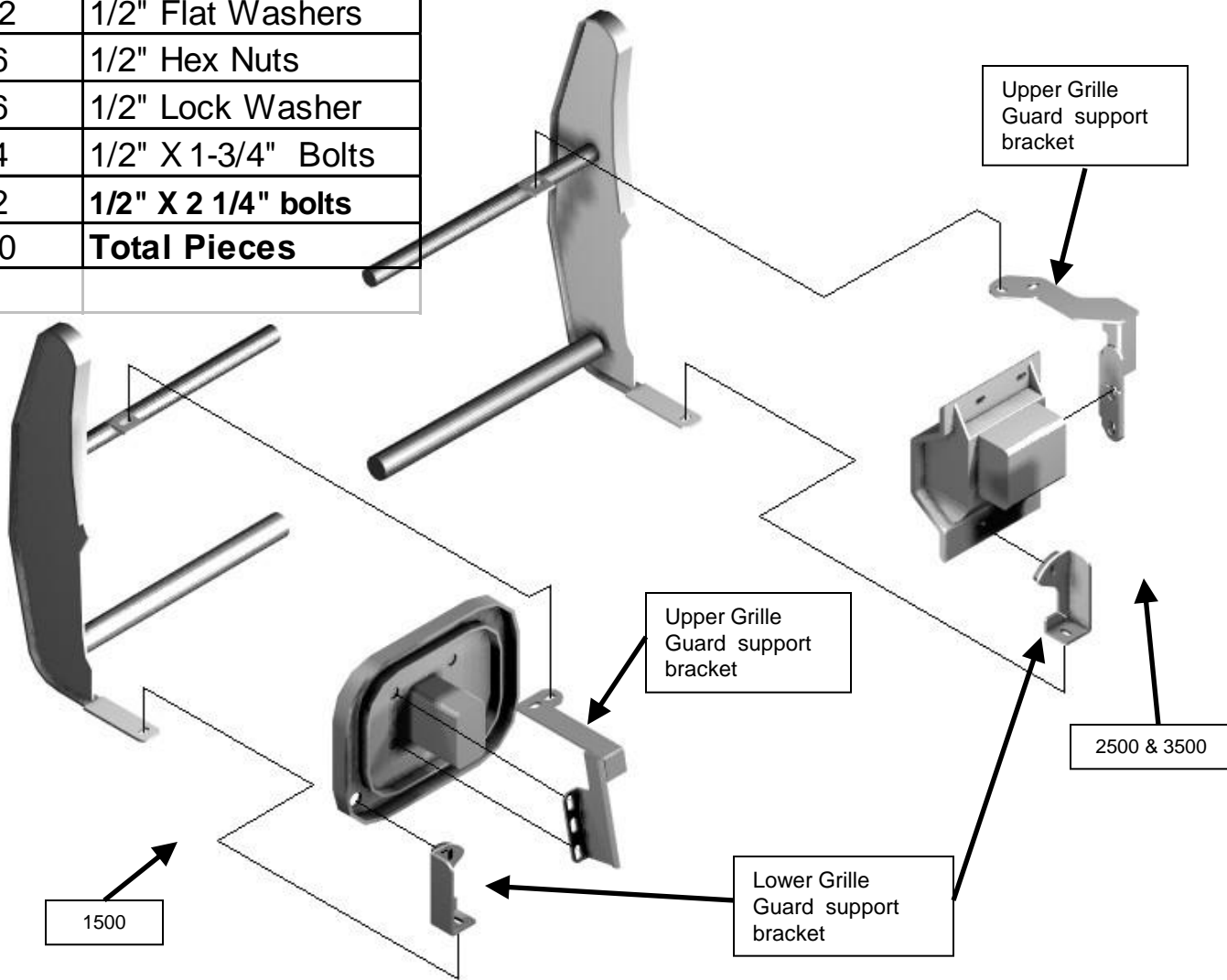

**Step 1:** Raise the Hood. Remove the two nuts on the side of the frame behind the frame cap (2500, 3500). Remove the two or three nuts on the back of the frame cap (1500). Insert upper grille guard support bracket and align to the two bolts, replace nuts and tighten. (Hint: the bracket should be below the hood 3/8" when the hood is closed).

**Step 2:** Remove the lower bumper bolt located on the bottom outside corner of frame cap. (**Note: DO NOT REMOVE FACTORY BUMPER – Bumper is not shown in photos for illustration only!**). Install lower support bracket behind to this bolt hole using 12mm X 60mm bolt supplied. Attach lower strap of Grille Guard to this bracket. Tighten bolt.

**Step 3:** Align grille guard to upper grille guard support bracket and align holes and insert 1/2" X 1-3/4" bolts and tighten with 1/2" nuts.

**Step 4:** Check alignment of grille guard to truck and don't forget to tighten all bolts.