

Installation & CARE

1988-1998 CHEVY C10 FENDER FLARE INSTALLATION INSTRUCTIONS

BEFORE INSTALLATION

- Confirm that the flare fits for your vehicle specifically. Filing, sanding, or cutting may be adopted for proper fit if necessary.
- Painting: (optional) if paint is desired it must be done prior to installing flares on vehicle. Clean outer surface with a good grade degreaser.
- Metal protection: Rust resistance paint on all exposed fasteners and bare metal should be done BEFORE installing flares. Undercoating the inner fender wells should be done AFTER flare attachments have been completed.
- Flares may interfere with existing decals on vehicle. If you wish, remove decals prior to the installation of the flares.

TOOLS AND SUPPLIES REQUIRED



PRODUCT NUMBER

FDF-C1088-TS-RS

PARTS LIST



LET'S START THE INSTALLATION

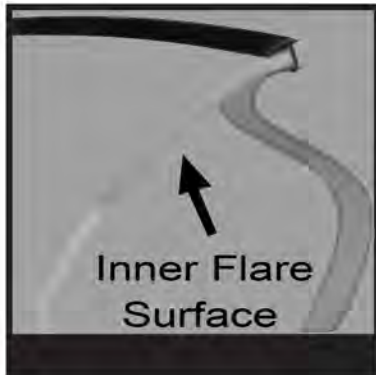

Edge trim installation: Peel 2 to 3 inches of red vinyl backing away from the Edge Trim (GP1-0008) tape. Applying the adhesive side of the edge trim to the inner side of the flare, affix the edge trim to the top edge of the flare (the portion that comes in contact with the vehicle)



Put a Washer (WA1-0012) on each bolt (SW1-0059)



Put each Bolt/Washer combination through a pocket hole in the flare. Bolt head and washer should be on the outside



Place a Nut (NU1-0019) on each bolt and tighten using a 1/2" wrench for the nut and the supplied Torx Bit (SW1-0052) for the bolt. Repeat for remaining pockets



Remove the factory fender trim, front fender body side molding and mud flaps (when installed)



Use a hair dryer or heat gun to heat the molding. This helps loosen the adhesive making it easier to remove

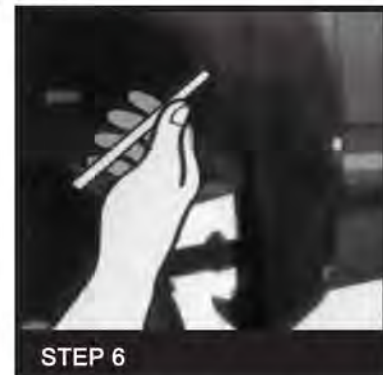

Hold the flare in position on fender using moderate pressure. Using a grease pencil, mark five hole locations using the holes in the flare as a guide



STEP 7

Hole locations to be marked



STEP 8

Remove the flare. Center a supplied black tab over the marks made in Step 5. Align the edge of the tab with the inside edge of the fender lip (tab may extend over outside of fender)



STEP 9

Install supplied "U" clips over each tab location



STEP 10

Reposition flare on fender. Install supplied Phillips screws through upper two hole locations and through each "U" clip installed in Step 8. If needed, use awl to align holes with the installed clips



STEP 11

Install supplied Phillips screws through each of the remaining holes



STEP 12

Applying moderate pressure to outside surface of the flare, tighten all screws beginning with the two top locations and then the remaining screws



STEP 13

Remove the factory fender trim and mud flaps (when installed)



STEP 14

Trim the installed body side molding, to allow the flare to lay flush against the sheet metal. Hold the flare up to the wheel well opening and mark a line on the body side molding where the flare overlaps it



STEP 15

Remove the flare and mark a cut line 1/4" beyond overlap line. Use blow dryer or heat gun to heat molding



STEP 16

Slide putty knife between the molding and the body of the vehicle



STEP 17

Carefully cut on the marked line with a utility knife, using the putty knife as a guard against the vehicle. Sand molding to desired finished edge



STEP 18

Hold the flare in position on the fender using moderate pressure. Using a grease pencil, mark five hole locations using the holes in the flare as a guide



STEP 19

Hole locations to be marked



STEP 20

Remove the flare. Center a supplied black tab over the marks made in Step 17. Align the edge of the tab with the inside edge of the fender lip (tab may extend over outside of fender)



STEP 21

Install supplied "U" clips over each tab location



STEP 22

Reposition the flare on the fender. Install supplied Phillips screw through two corner hole locations and through each "U" clip installed in Step 20. If needed, use awl to align holes with the installed clips



STEP 23

Ensuring the flare is properly located on the fender, install supplied Phillips screws through each of the remaining holes



STEP 24

Applying moderate pressure to the outside surface of flare, tighten all screws beginning with the two corner locations and then the remaining screws



STEP 25

Use the edge trim tool to seat the edge trim against the vehicle by hooking the curved end under the edge trim at one end of the flare. Next, slide around the outer edge of the flare to the other end



STEP 26

Using the flat end of the edge trim tool, seat the edge trim against the flare by inserting the straight end between the edge trim and the flare at one end. Next, slide around the entire edge to the other end