



## 2013+ TOYOTA RAV4 MUD FLAP INSTALLATION INSTRUCTIONS

For high resolution color images of these instructions, please visit <http://www.rallyarmor.com>

Check wheel clearance after installation, especially vehicles outfitted with non-OEM wheels and suspensions.

To protect your Rally Armor mud flap set, **care must be taken during parking and reversing.** Rally Armor is not responsible for damage or loss of installed flaps.



YOUR MOUNTING HARDWARE CONSISTS OF:			GUIDE TO SCREWS/CLIPS PROVIDED:						
Quantity	Hardware Item	Item ID	SHORT SCREW (1SS)	LONG SCREW (1.5SS)	LARGE SPACER (.5SP)	SMALL SPACER (.25SS)	FLAT "U" CLIP (Uclip)	INSERT 2 (Ins2)	"L" BRACKET (LBRKT)
8	Flat "U" Clips	UClip							
20	Washers	SmWash							
4	Long Screws	1.5SS							
14	Short Screws	1 SS							
4	Large Plastic Spacers	.5SP							
2	Small Plastic Spacers	.25SP							
2	Rear "L Mounting Brackets	LBRKT							
2	Insert #2	Ins2							

### ! IMPORTANT NOTES

**Cautionary Tip:** The hardware is strong and self-threading but over-tightening the clips is not advised. Tighten until washers are firmly seated.

**Installation Tip:** To ease installation and avoid damage to existing OEM clips during removal, a well-lit, climate controlled installation environment is recommended.

**Parking and Reversing:** Any extended mud flap application can be damaged or dislodged should they get caught in between a tire/curb or object. To protect your Rally Armor mud flap set, care must be taken during parking and reversing. Rally Armor is not responsible for damage or loss of installed flaps.

#### Recommended tools:

Small Flat Screw Driver or Pick, Offset, ratcheting Phillips screwdriver, 10mm wrench.

**To the customer:** Retain these instructions after installation. They may be necessary for installing other optional parts or removal of this accessory.

**To the installer:** Please return these instructions to the customer after installation. Always test and adjust wheel clearance before returning vehicle.

## Front Mud Flap Installation

- **(Figure A)** Park vehicle on an even surface. Turn the steering wheel towards the side you are working on.

**Splash Guard Equipped Vehicles-** Remove the 3 outer 10mm bolts (1,2,3) , and fastener underneath (5). Remove splash guard. Your new mud flaps will be replacing the smaller OEM splash guards. Re- install fastener underneath after removing splash guard (5).

**Non Guard Equipped Vehicles –** You will be utilizing the existing three outer mounting point (1,2,3) inserts found on the vehicle.

- **(Figure B)** Remove inner wheel well liner fastener (4).
- **(Figure C)** Remove inner screw from supplied insert (INS2). Install new the insert (Ins2) until flush against the mounting hole.

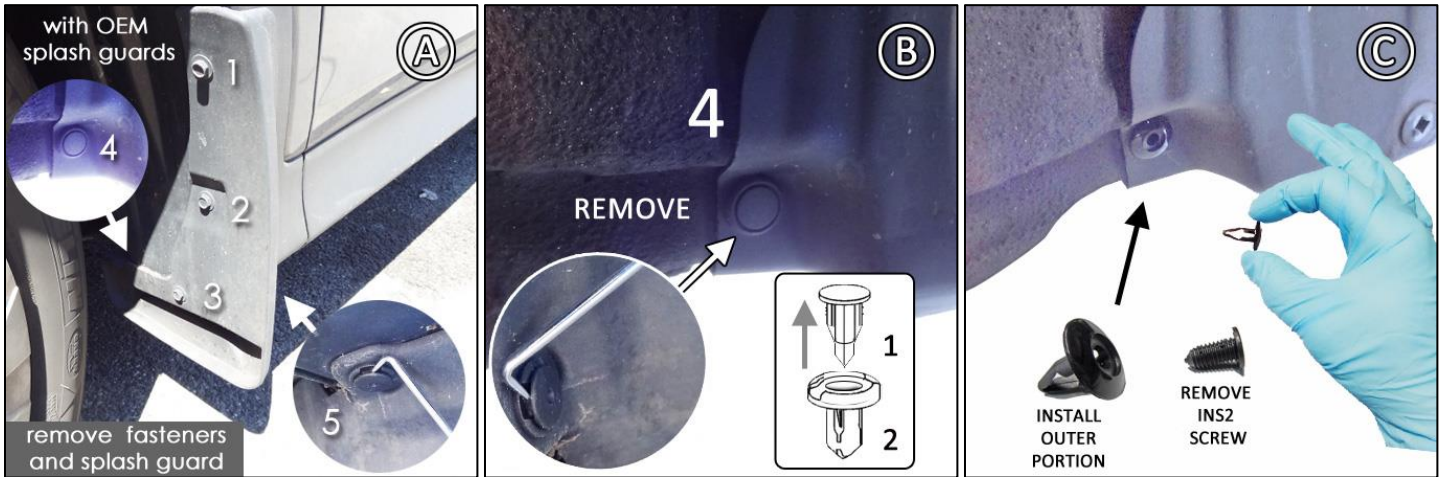

- **(Figure D)** Place the front mud flap against the corresponding mounting points with the logo facing toward the rear of the vehicle. Mount mud flap by hand threading a short screw (1SS) and washer (SmWash) into each of the mounting points (1) (2) (3). **For the center mounting point (2) place two additional washers (SmWash) behind the mud flap** to ensure flush fitment against the vehicle. **Do not fully tighten. You will be adjusting the flap**

- **(Figure E)** For the innermost mounting point (4), place a long screw and washer through the mud flap, along with a small and large spacer **behind** the mud flap against the liner. Thread the long screw into the new insert you have installed. **Do not fully tighten. You will be adjusting the flap.**

- **(Figure F)** Align outer edge of the flap by incrementally adjusting the assembly side to side, as well as the lower & upper portions of the flap. Check your adjustment, and confirming the flap is perpendicular to even ground. Tighten all mounting screws until the washers are seated.

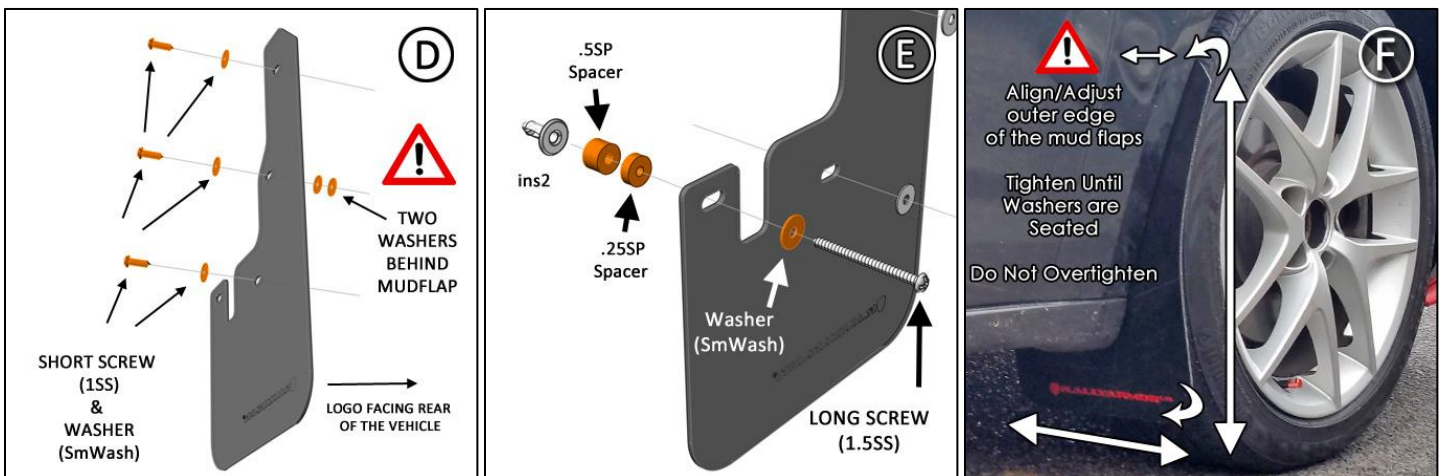

## Rear Mud Flap Installation

- (Figure G)

**Splash Guard Equipped Vehicles-** Uninstall splash guard by removing the three outer screws (1,2,3) and two 10mm fasteners (4,5) underneath. Remove splash guard. Your new mud flaps will be replacing the smaller OEM splash guards. **Reinstall the outer 10mm fastener (4).**

**Non Splash Guard Equipped Vehicles** – remove the innermost 10mm fastener underneath **only (5) if present**. Otherwise the outer bumper fastener **remains (4)**.

**Expand the preset factory mud guard mounted points (visible dimples) in place using a screw or small bit .**

- (Figure H) Remove any existing factory spring clips from the bumper area (Present on splash guard equipped vehicles). Place flat U clip (UClip) over each of the 3 outer mounting mounts (1, 2, 3).

- (Figure I) Reinstall the Innermost OEM 10mm bolt fastener through the **slotted mounting point** on the L bracket. Mount the L bracket to the vehicle with circular mounting hole facing down. Install a flat U Clip (UClip) over circular mounting hole.

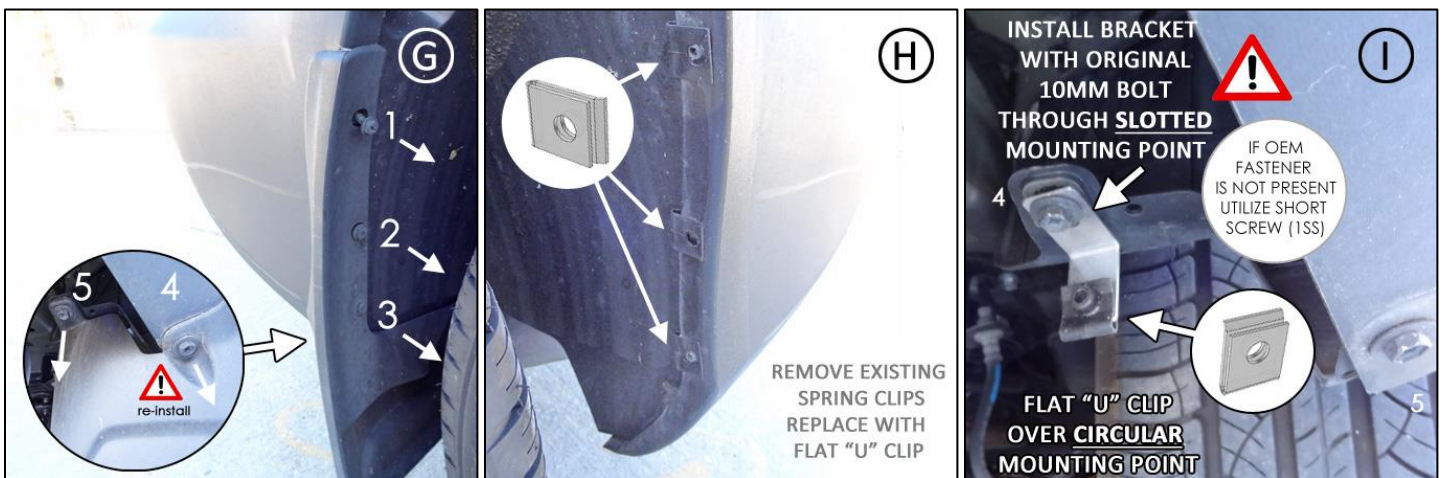

- (Figure J) Place the mud flap with the logo facing the rear of the vehicle, against the corresponding mounting points on the vehicle and bracket. Place a short screw (1SS) and washer (SmWash) over each of the three outer mounting points through the flap into the outer edge mounted clips (1)(2)(3). **Do not fully tighten. You will be adjusting the flap.**

- (Figure K) Mount innermost mud flap mounting point to bracket with a Long screw (1.5SS) ,washer (SmWash) and large spacer (.5Spc) between the mud flap and bracket. **Do not fully tighten. You will be adjusting the flap.**

- (Figure L) Align outer edge of the flap by incrementally adjusting the assembly side to side and the lower & upper portions of the flap. Check your adjustment, and confirming the flap is perpendicular to even ground. Tighten all mounting screws until the washers are seated. **Do not over tighten.**

## IMF41/IMF 44

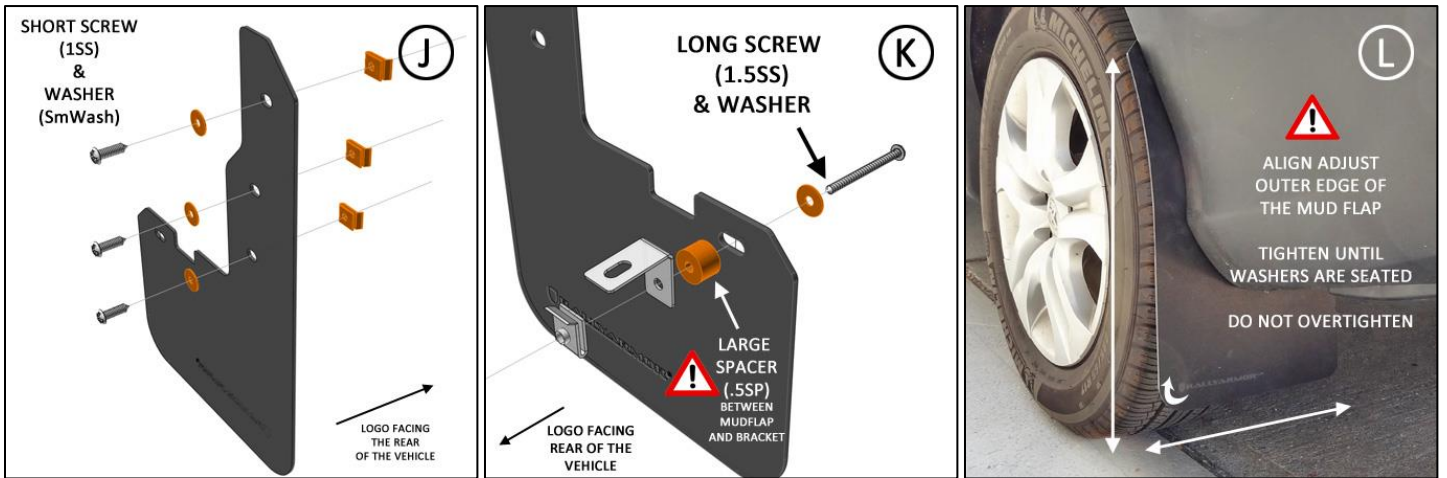

## RALLYARMOR® MF41/MF44 MOUNTING DIAGRAM

FRONT

REAR

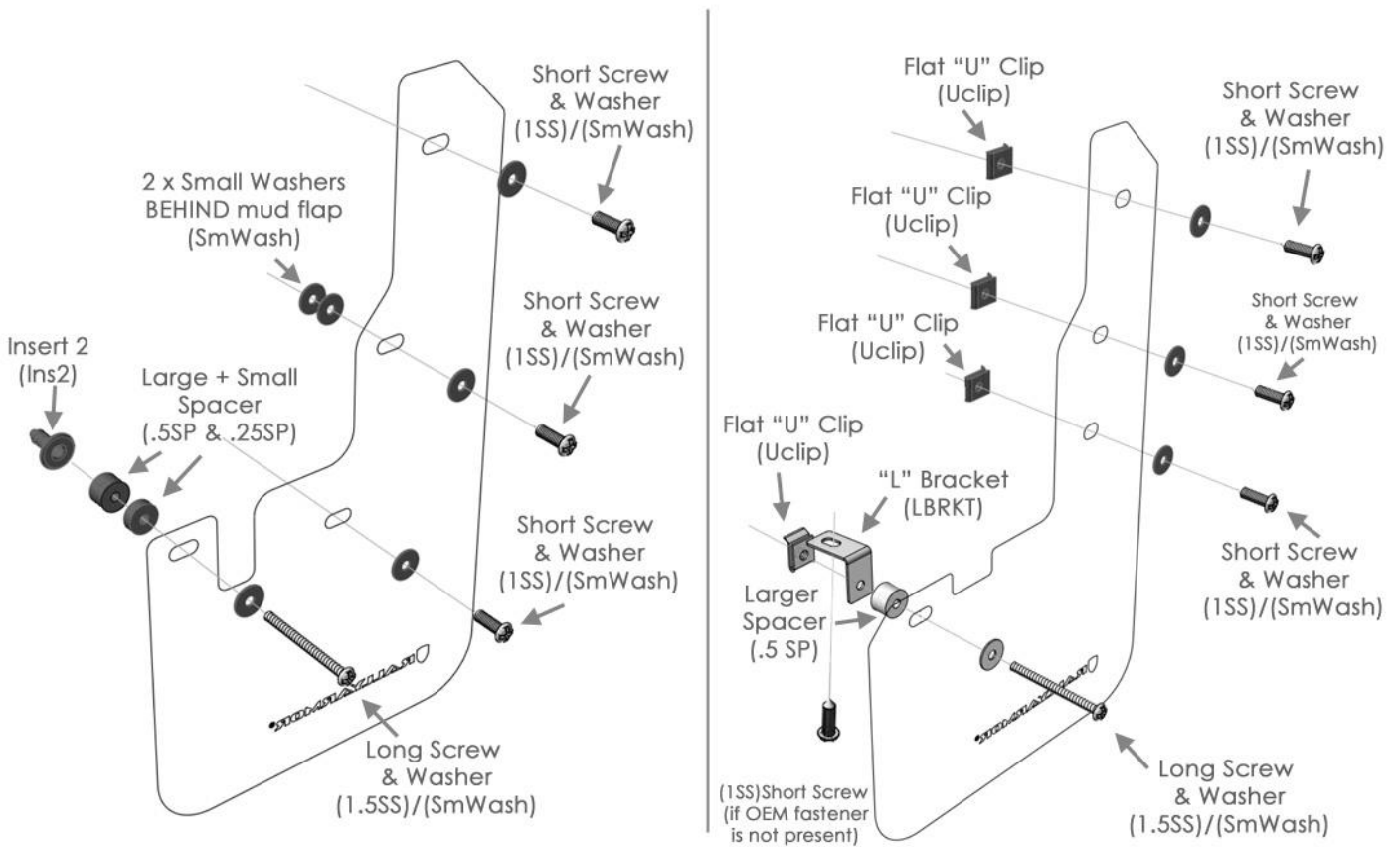

Check wheel clearance after installation, especially on vehicles outfitted with non-OEM offset wheels and suspensions. Adjust to accommodate accordingly in these scenarios. Rally Armor is not responsible for damage or loss of installed flaps.