

Installation & CARE

2001-2003 BMW 5 SERIES E39 LED TAIL LIGHTS INSTALLATION

BEFORE INSTALLATION

- If you experience any difficulties that the instruction did not cover, please seek assistance at local automotive shop.
- Please wear protection before you work on any vehicle.
- An assistant is useful when removing the front bumper from your vehicle.
- Please be cautious when working with the bumper or any parts belonging to the vehicles's body to prevent scratching.
- Do not make direct contact with the halogen bulbs or the wire assembly until the unit has cooled down after use.

TOOLS AND SUPPLIES REQUIRED

¼" Ratchet	8 mm socket	Plastic Pry bar	
			

PRODUCT NUMBER

LT-E3901RLED-TM
LT-E3901RGLED-TM
LT-E3901GLED-TM



LET'S START THE INSTALLATIONS



STEP 1

Before installation



STEP 2

Open trunk



STEP 3

Pull tab to lower access panel



STEP 4

Push down on center tab and disconnect tail light harness



STEP 5

Remove four 8mm nuts



STEP 6

Remove OEM Tail Light



STEP 7

Install LED Tail light

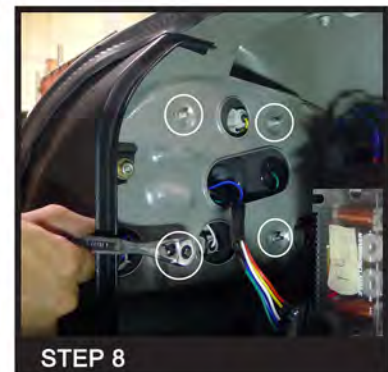

STEP 8

Secure four 8mm nuts



STEP 9

Connect chassis connector to tail light harness



STEP 10

Close access panel

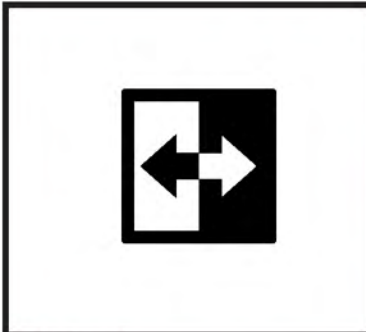

STEP 11

Please repeat the steps from 3 to 10 for the opposite side



STEP 12

The installation is now complete