



Strong As An Ox™

BX1957 Installation Instructions 2003 Dodge Ram 1500

Serial No.

With a vehicle with tow hooks the existing bolts and nutplates will be used for baseplate installation. A vehicle without tow hooks, the black trim piece will be removed, existing holes will be used. Drilling is NOT necessary. No trimming of the fascia is needed. The BX8869 is available for this vehicle. Attachment tabs are 24 inches center to center and a height of 23 1/2 inches.



1. For a vehicle **with** tow hooks, remove the six 15MM bolts to remove the tow hooks. Using existing metric bolts and fasten the baseplate to the truck. **Be sure and use loctite on all bolts before tightening. Tighten and torque all bolts according to chart on the General Instruction Sheet.**



2. For a vehicle **without** tow hooks has a plastic trim piece that will need to be removed. Once this is removed, bolt the baseplate to existing holes in frame with 1/2-13 x 1 1/2 hex bolts, lockwashers and hex nuts as shown on page 2 (items 2, 3 and 4). **Be sure and use loctite on all bolts before tightening. Tighten and torque all bolts according to chart on the General Instruction Sheet.**



3. The dimensional variations between otherwise identical cars can be considerable. While the location and size of the holes in the baseplate were designed to allow for easy installation, it may be necessary to file a hole slightly to allow a bolt to clear.
4. Install the tow bar and safety cables according to the instructions included in their packages.
5. Do **not** substitute other devices if the tow bar pin and clip are lost.
6. **DEALER OR INSTALLER: BE CERTAIN THE USER RECEIVES THE INSTRUCTION SHEET.**



Strong As An Ox™

Tools Required

15MM Socket

Loctite Blue

3/4 Socket

Parts List

Ref. No.	Qty.	Part No.	Description
1	1	61-5887	Weldment, Base Plate, BX1957
2	6	201-0051	1/2-13 x 1 1/2 Hex Bolt, Grd.5, ZP
3	6	202-0005	1/2-13 Hex Nut, Grd.5, ZP
4	6	203-0012	1/2 Lock Washer, ZP
5	2	101-5822	Adapter, 4-way Connector
6	2	201-0553	1/4-20 x 1/2 Hex Washer Head, Type F, Screw,ZP
7	2	201-0192	#10-32 x 1/2 Slot, Rd. Hd Screw
8	2	202-0047	#10-32 Hex Nut, ZP
9	2	203-0054	#10 Lock washer, ZP
	2	226-0049	Baseplate Safety Cable, 36" CL IV (Not Shown)
	4	229-0512	Quicklink, 1/2, ZP (Not Shown)
E	6	Note: When tow hooks are on vehicle, use existing nutplates, and metric bolts	

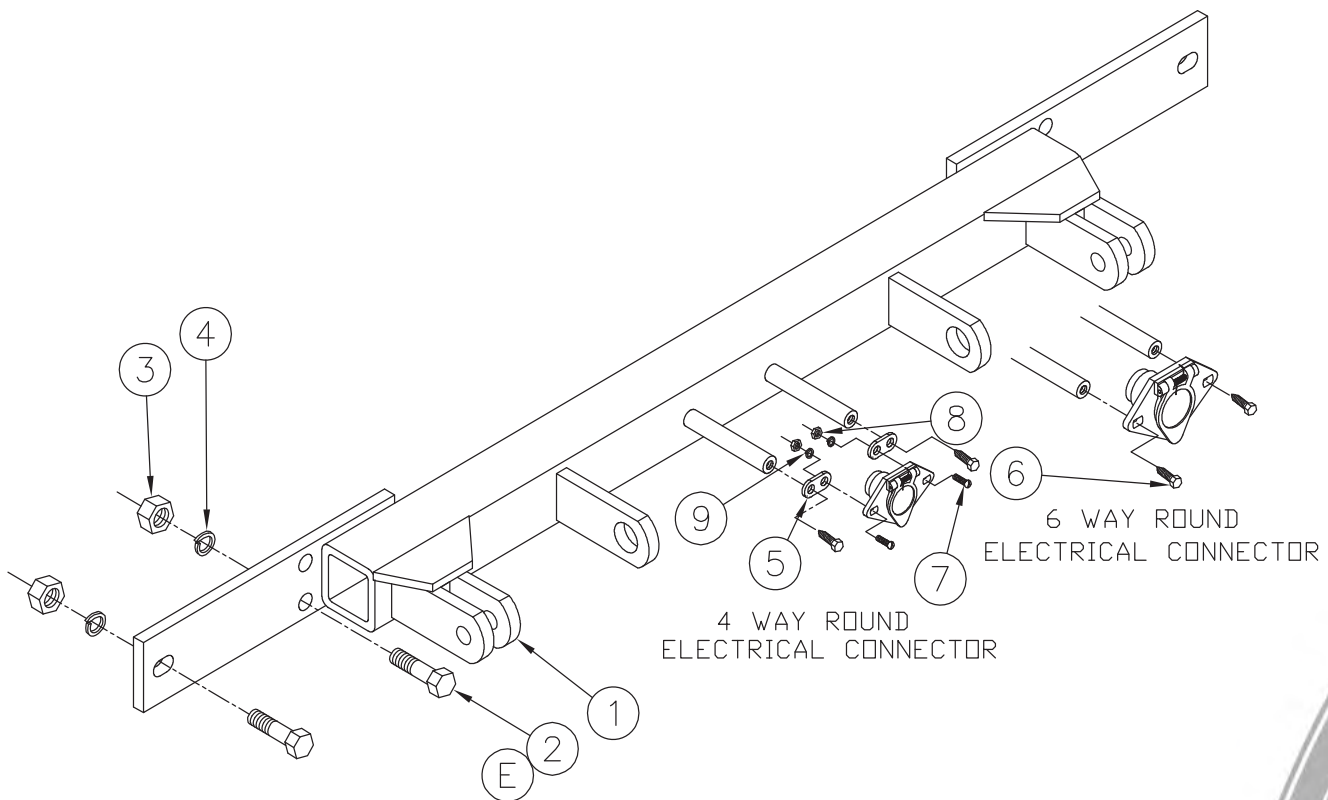

IMPORTANT: Use only genuine factory replacement parts on your Base Plate. Do not substitute homemade or nontypical parts. If a bolt is lost or in need of replacement, for your safety and the preservation of your Base Plate, be sure to use a replacement bolt of the same grade (Usually Grade 5, refer to parts list). Repair parts may be ordered through your nearest **Blue Ox** dealer or distributor.