



Strong As An Ox™

BX2166 Installation Instructions 2002-03 Ford Explorer Sport Trac

Serial No.

Two tow hook bolts on each side are removed for baseplate installation and will be replaced. Drilling is necessary. No trimming of the fascia is needed. The BX8869 is available for this vehicle. Attachment tabs are 18 inches center to center and a height of 19 1/2 inches.



1. Remove the metric bolts from the belly pan with 8MM & 10MM sockets (5 total). If the vehicle has tow hooks, take both off, slide the baseplate up in position and bolt it to the frame with the existing four 15 MM bolts and two nutplates. If the vehicle does not have tow hooks, use the four 1/2-13 x 1 1/2 hex bolts, hex nuts, and lock washers (items 3, 4 and 5). **Be sure and use loctite on all bolts before tightening. Tighten and torque all bolts according to chart on the General Instruction Sheet.**
2. Using the baseplate as a template, drill the two holes on the outside of the baseplate into the bottom of the frame with the 17/32 inch drill bit, one on each side. Using the remaining 1/2-13 x 1 1/2 hex bolts, 1/2 lock washer and 1/2 wire nuts (items 2, 3 and 5), finish bolting the baseplate to the frame. Note: There are slots on the outside of the tube to feed the wire nuts into. **Be sure and use loctite on all bolts before tightening. Tighten and torque all bolts according to chart on the General Instruction Sheet.**
3. With all nuts and bolts tightened with loctite and torqued correctly, replace the belly pan and tighten all metric bolts.
4. The dimensional variations between otherwise identical cars can be considerable. While the location and size of the holes in the baseplate were designed to allow for easy installation, it may be necessary to file a hole slightly to allow a bolt to clear.
5. Install the tow bar and safety cables according to the instructions included in their packages.
6. Do **not** substitute other devices if the tow bar pin and clip are lost.
7. **DEALER OR INSTALLER: BE CERTAIN THE USER RECEIVES THE INSTRUCTION SHEET.**





Strong As An Ox™

Tools Required

8, 10 & 15MM Sockets
3/4" Socket

17/32" Drill Bit
Loctite Red

Parts List

Ref. No.	Qty.	Part No.	Description
1	1	61-5888	Weldment, Base Plate, BX2166
2	2	61-4029	Weldment, 1/2 Nut Wire
3	6	201-0051	1/2-13 x 1 1/2 Hex Bolt, Grd.5, ZP
4	4	202-0005	1/2-13 Hex Nut, Grd.5, ZP
5	6	203-0012	1/2 Lock Washer, ZP
6	2	201-0553	1/4-20 x 1/2 Hex Washer Head, Type F, Screw, ZP
7	2	101-5822	Adapter, 4-way Connector
8	2	202-0047	#10-32 Hex Nut, ZP
9	2	201-0192	#10-32 x 1/2 Slot, Rd. Hd Screw
10	2	203-0054	#10 Lock washer, ZP
E	2	Note: When tow hooks are on vehicle, use existing nutplates, and metric bolts	
	2	226-0049	Baseplate Safety Cable, 36" CL IV (Not Shown)
	4	229-0512	Quicklink, 1/2, ZP (Not Shown)

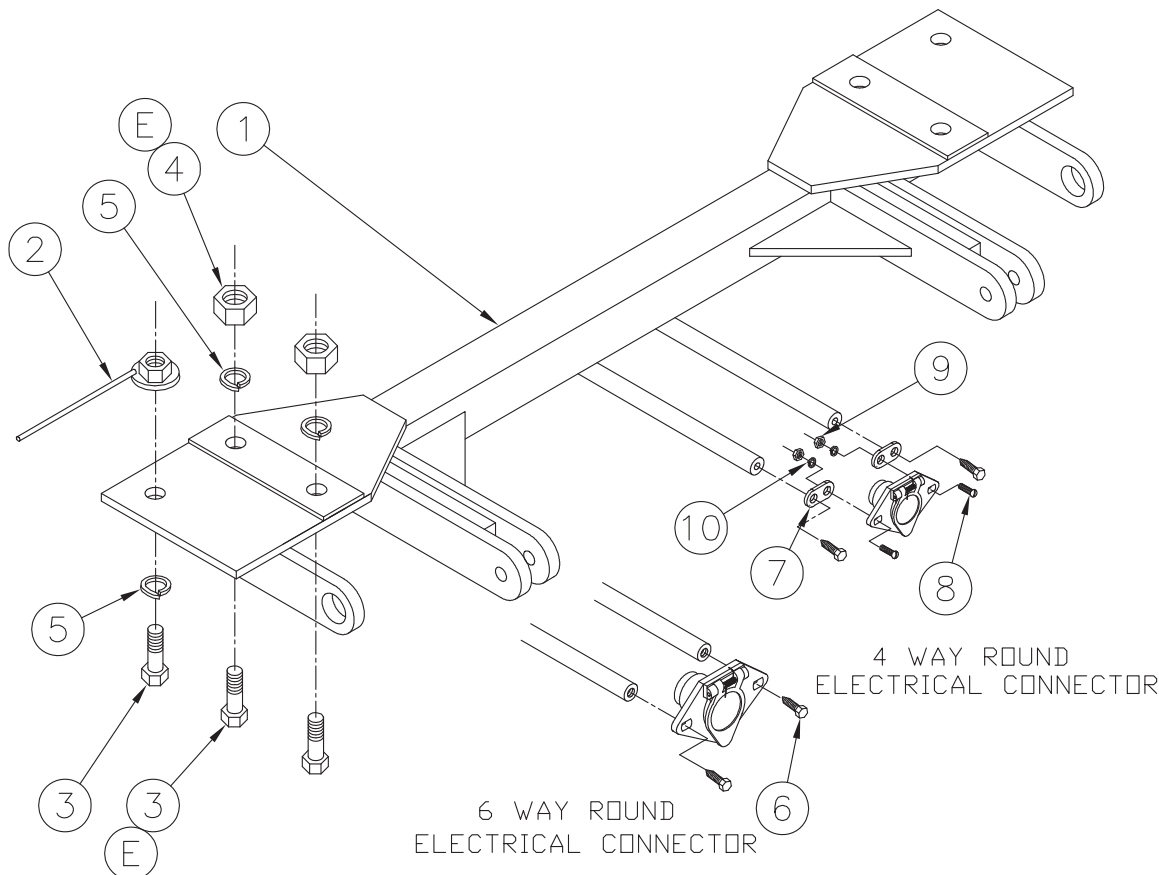

IMPORTANT: Use only genuine factory replacement parts on your Base Plate. Do not substitute homemade or nontypical parts. If a bolt is lost or in need of replacement, for your safety and the preservation of your Base Plate, be sure to use a replacement bolt of the same grade (Usually Grade 5, refer to parts list). Repair parts may be ordered through your nearest **Blue Ox** dealer or distributor.