



Strong As An Ox™

## BX2236 Installation Instructions 2003-05 Honda Civic Hybrid (Not CVT)

Serial No.

The front fascia, headlight assembly and windshield washer reservoir are removed for baseplate installation. Drilling is required. Trimming or removal of black lower grill plastic is required. The BX8869 is available for the 2004 model and the BX8847 for the 2005 model. Attachment Tabs are 20 inches center to center and a height of 12 inches.



1. Remove the eight push pins from black plastic cover on top side of fascia, lift cover and set aside.



2. Remove eight push pins and two phillips screws from the lower back edge of fascia.



3. Just forward of front tire is one metric bolt to remove, using the 8MM socket, both sides, pull fascia down on the ends and forward, set aside.



4. Using the 10MM socket, remove one metric bolt and one push pin from the top side of headlight assembly, both sides.

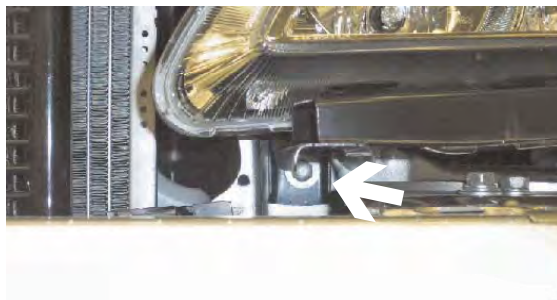

5. Remove one metric bolt from below headlight assembly with the 10MM socket, both sides.



6. Remove the metric bolt from headlight assembly with the 10MM socket, pull forward, unplug electrical and set aside, both sides.



Strong As An Ox™



7. Using the 12MM socket, remove metric bolt from the top side of metal bumper, both sides.



8. Remove one metric bolt from the bottom side of metal bumper using the 12MM socket, pull forward and set aside.

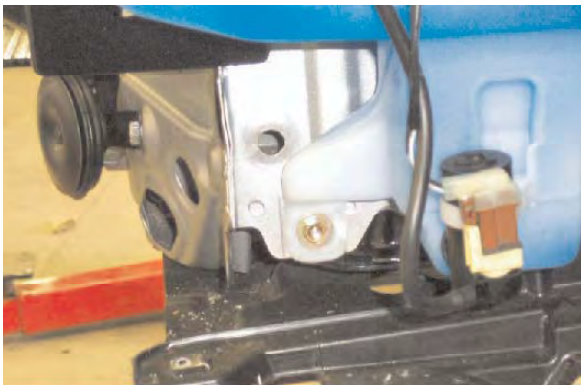

9. Remove the three metric bolts from washer reservoir using the 10MM socket, unplug electrical connections, disconnect and plug water lines, set aside.



10. Using the 12MM socket, remove the metric bolt from horn bracket on driver's side.

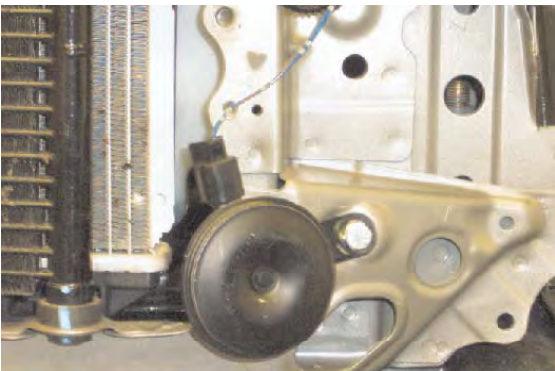

11. Relocate horn bracket to existing hole just below original location using the 5/16-18 x 3/4" hex bolt, lock washer and whiz nut.



12. Cut and remove forward webbing on lower frame with the hack saw or reciprocating saw, both sides.



Strong As An Ox™

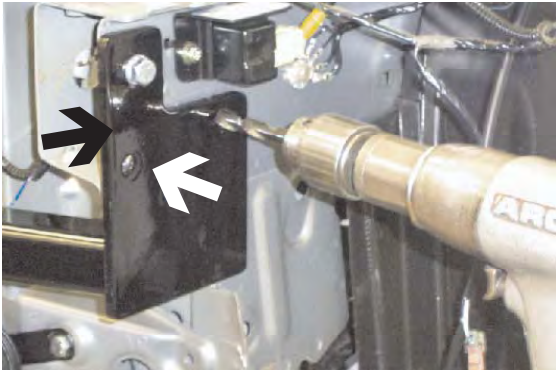

13. Align the front edge of baseplate, with the end of frame (black arrow) and align to existing hole on driver's side for front washer reservoir bolt, clamp in place with the vise grips. Maintain same distance from the top of frame to the top of baseplate on the passenger's side, align with front edge of baseplate to frame end and clamp in place with vise grip. Using the baseplate as a template, drill the three holes on the driver's side with the 13/32" drill bit. **Do not drill existing hole for the washer reservoir (white arrow).** Insert 3/8 x 1 1/2" hex bolt and lock washer into the top and back drilled holes on the driver's side, tighten into nut plate. Insert 3/8 x 1" hex bolt into lower drilled hole on the back side of webbing, tighten lock washer and hex nut. **Be sure and use loctite on all bolts before tightening. Tighten all bolts according to torque chart in the General Instruction sheet.**



16. Reinstall washer reservoir on the driver's side with existing back bolts and replace existing front bolt with the 6MM-1 x 45MM hex bolt, 1/4" flat and lock washer (Do not over tighten). **2005 MODEL:** Use the 6MM-1 x 30MM hex bolt.



14. Using the flat chisel, remove the square nut attached to the inside of the frame that aligns with existing hole in frame on the passenger's side (see white arrow in step 15).



15. Using the baseplate as a template, drill the four holes on the passenger's side with the 13/32" drill bit, while maintaining proper location of baseplate as stated in step 13. Insert 3/8 x 1 1/2" hex bolt and lock washer into the top three drilled holes on the passenger's side, tighten into nut plate. Insert 3/8 x 1" hex bolt into lower drilled hole on the back side of webbing, tighten lock washer and hex nut. **Be sure and use loctite on all bolts before tightening. Tighten all bolts according to torque chart in the General Instruction sheet.**



Strong As An Ox™



17. Hold fascia to its original position and trim horizontal rib to allow attachment receivers to come through. **OPTIONAL METHOD:** Remove lower black plastic from the back side of fascia's opening.

18. The dimensional variations between otherwise identical cars can be considerable. While the location and size of the holes in the baseplate were designed to allow for easy installation, it may be necessary to file a hole slightly to allow a bolt to clear.

19. Install the tow bar and safety cables according to the instructions included in their packages.

20. Do **not** substitute other devices if the tow bar pin and clip are lost.

21. **DEALER OR INSTALLER: BE CERTAIN THE USER RECEIVES THE INSTRUCTION SHEET.**

**RECOMMENDED INSTALLATION FOR THE BX8869**  
**2004 MODEL ONLY**

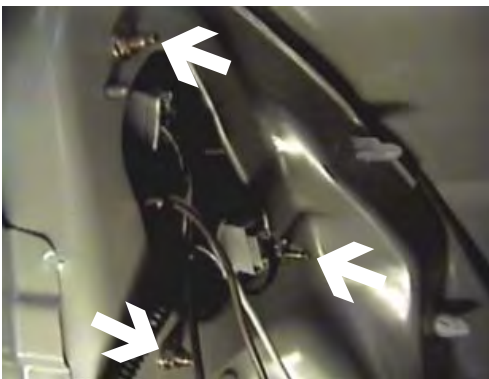

Remove two push pins from trunk liner. Pull liner back and remove three metric nuts from taillight assembly with the 8MM socket (left photo). Remove one phillips screw on the bottom of taillight assembly bracket from under the rear fascia (right photo).



Location for the BX8869, bulb and socket on the driver's side of the 2004 model.

## Tools Required



Strong As An Ox™

8MM Socket  
Flat Chisel  
Phillips Screw Driver  
Utility Knife

10MM Socket  
Loctite  
Vise Grips

12MM Socket  
13/32" Drill Bit  
9/16" Socket

## Parts List

Ref. No.	Qty.	Part No.	Description
1	1	61-6026	Weldment, Base Plate, BX2236
2	5	61-5208	3/8" Nut Plate, with Wire
3	5	201-0440	3/8-16 x 1 1/2 Bolt, Grd. 5, ZP
4	2	201-0443	3/8-16 x 1 Bolt, Grd. 5, ZP
5	7	203-0010	3/8 Lock Washer, ZP
6	2	202-0003	3/8-16 Hex Nut, ZP
7	1	201-0003	5/16-18 x 3/4 Bolt, Grd. 5, ZP
8	1	203-0009	5/16 Lock Washer, ZP
9	1	202-0070	5/16-18 Hex Flange Whiz Lock Nut, ZP
10	1	201-0655	6MM-1.00 x 30MM Hex Bolt, Grd 8.8, ZP
11	1	203-0008	1/4 Lock Washer, ZP
12	1	203-0001	1/4 Flat Washer, ZP
13	2	201-0553	1/4-20 x 1/2 Hx. Wshd, Type F Screw
14	2	202-0047	#10-32 Hex Nut
15	2	203-0054	#10 Lock Washer
16	2	201-0192	#10-32 x 1/2 Slot, Rd. Hd. Screw
17	2	101-5822	Adapter, 4 Way Connector
18	2	62-3468	Attachment, Assembly, SF/ SB (R)
	2	226-0046	Baseplate Safety Cable, 36" CL III (Not Shown)
	2	229-0359	Quicklink, 3/8, ZP (Not Shown)
	2	290-0437	Receiver, Cap Plug (BLK) (Not Shown)

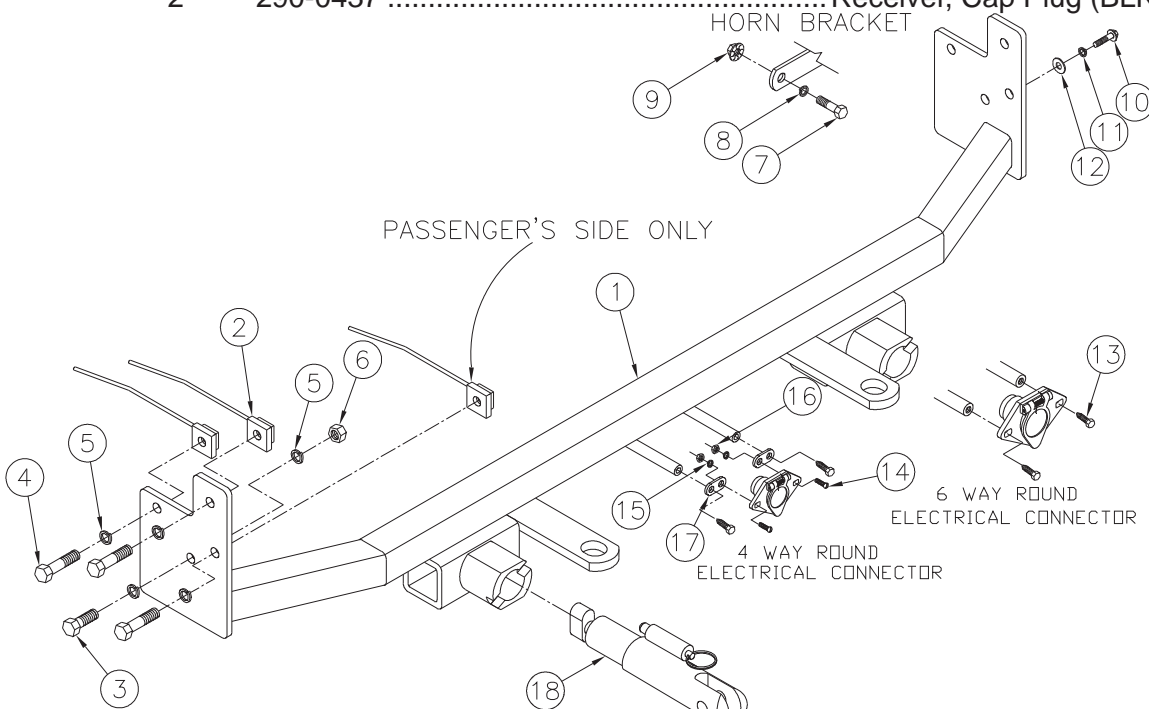

**IMPORTANT:** Use only genuine factory replacement parts on your Base Plate. Do not substitute homemade or nontypical parts. If a bolt is lost or in need of replacement, for your safety and the preservation of your Base Plate, be sure to use a replacement bolt of the same grade (Usually Grade 5, refer to parts list). Repair parts may be ordered through your nearest **Blue Ox** dealer or distributor.