

Thank you for your purchase of our new SS3 Dual-Pod Bracket Kit. This frame allows you to mount two SS3 LED Pods together as one unit. Basic installation instructions are included below.

Please contact us if you have any questions.

Tools Needed: Screwdriver with T10 Torx Bit, Latex gloves (prevents fingerprints/grease on the lens)

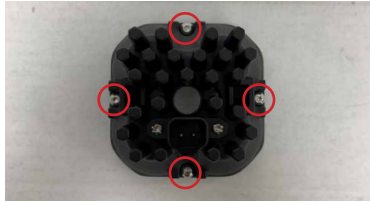
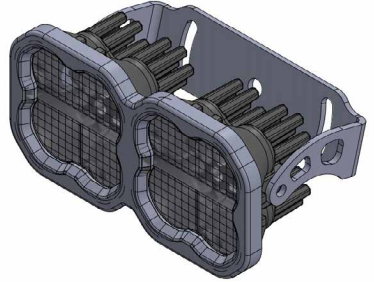

1. Remove the front bezel from the pod by placing the SS3 face down and removing the four T10 Torx screws. Repeat for the second pod.

NOTE: These screws won't be reused.



2. Place the Dual-Pod Frame upside down on a flat surface. Wearing gloves, carefully remove the lens and o-ring from the SS3.



3. Place the lens and o-ring face down into the frame. Ensure the alignment notch on each lens is at the top of the frame.



4. Place the SS3 castings on top of the lenses.

NOTE: The DT-plug should be towards the bottom. The lens alignment notch will mate with the SS3 casting.

See back for further instructions.

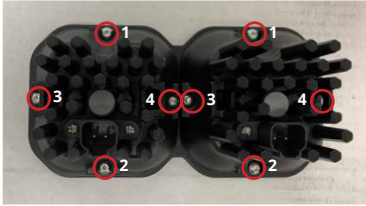

5. Using the T10 screws provided with the frame, tighten them in a "plus pattern" (top-bottom-left-right) to ensure the o-ring around the optic creates an even seal with the frame.



6. Place the included nuts in the outermost mounting points on each pod.

NOTE: The nylon portion of the nut should face inward.



7. Attach the U-bracket to the pods using the included screws and washers. Hand tighten only.



8. Mount the U-bracket to the vehicle using the supplied hardware. Adjust and aim the bracket. Then fully tighten the side bolts to complete the installation.

Refer to the Universal Bracket Info/Mounting Guide for wiring and specifications.

Please contact **Diode Dynamics** should you have any questions about the installation or wiring process, at **314-205-3033** (10a-5p CST) or **contact@diodedynamics.com**.

This installation guide is for the following SKU:

DD6610 SS3 Dual-Pod Bracket Kit

**100% SATISFACTION
GUARANTEE**

