

S5070

2011-2013 CHEV/GMC
1500 SILVERADO/SIERRA,
EXTENDED CAB 6.5' BED / CREW CAB, 6.2L,
CAT BACK, 3.5", SINGLE SIDE EXIT

MBRP®

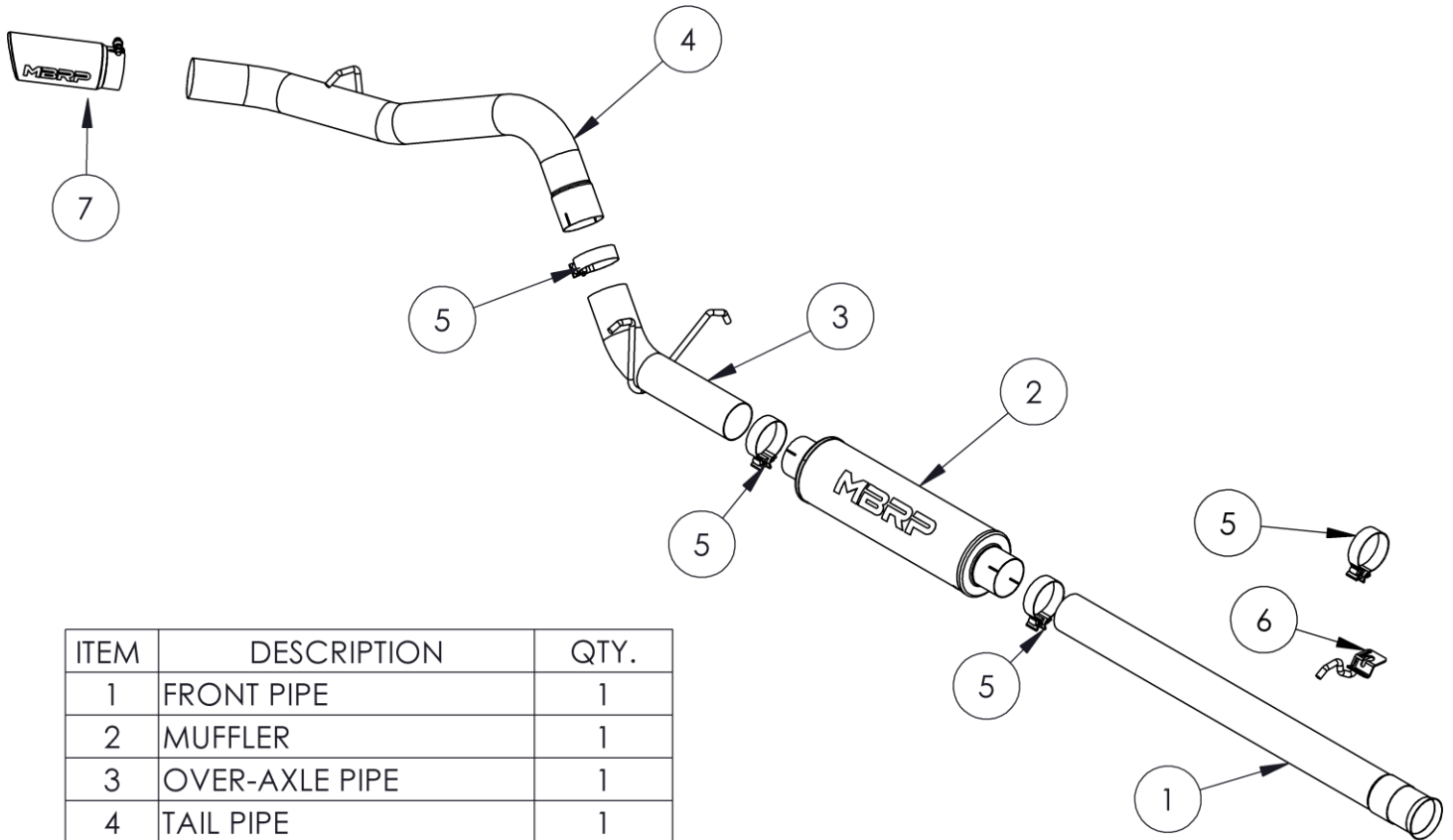

ITEM	DESCRIPTION	QTY.
1	FRONT PIPE	1
2	MUFFLER	1
3	OVER-AXLE PIPE	1
4	TAIL PIPE	1
5	3.5" BAND CLAMP	4
6	HANG TIGHT™ HANGER	1
7	TIP	1

PLEASE READ BEFORE STARTING INSTALLATION

While MBRP has made every effort to ensure that all components of this system are of superior quality and properly packaged, it is the installer's responsibility to ensure the following before removal of the factory exhaust:

- that ALL components shown above are present.
- that ALL mating components fit together.
- that there are no damaged components.
- that the system you have purchased is appropriate for your vehicle year, model and configuration.
- that the system will not interfere with any modifications previously installed or planned.
- that you have read and understand these instructions.

If you have any questions or are uncertain about any aspect of the installation of this system to your vehicle please contact your dealer before commencing installation.

MBRP



Figure 1



Figure 2



Figure 3



Figure 4

Removal of Stock System:

1. Apply a penetrating lubricant liberally to all exhaust fasteners, hangers, and rubber insulators.
2. Remove the clamp after the catalytic converter and save the clamp for the installation. **Refer to Figure 1.**
3. The tail pipe will need to be cut to clear the rear axle. **Refer to Figure 2.**
4. Remove the hangers from the rubber insulators and remove the exhaust from the vehicle. **Refer to Figure 3.**

Installation of MBRP Performance Exhaust:

1. Install the **Hang Tight™ Hanger** onto a **3.5" Band Clamp** using the procedure shown below. (Hang Tight™ Hanger not exactly as shown)

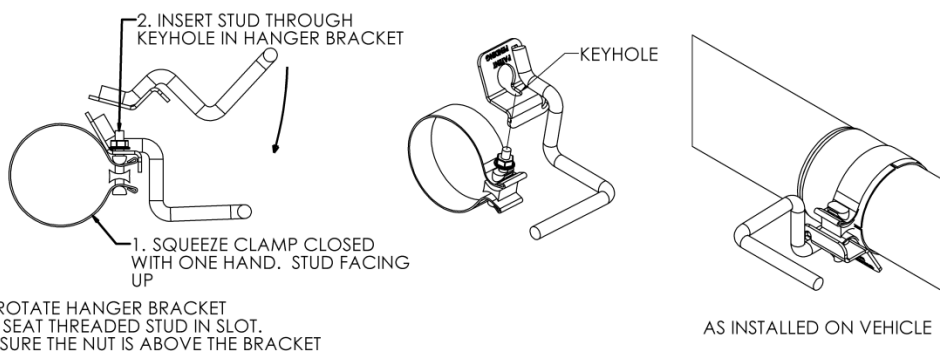

2. Loosely attach the **Extension Pipe** to the flange using the stock clamp. Slide the previously assembled **Hang Tight™ Hanger Clamp Assembly** onto the rear of the **Extension Pipe** and into the existing rubber insulator. **Refer to Figure 4.**

2. Slide a **3.5" Band Clamp** onto the rear of the **Extension Pipe**. Install the **Muffler** onto the **Extension Pipe** and slide a **3.5" Band Clamp** onto the rear of the **Muffler**.

MBRP



Figure 5

3. Feed the **Over-Axle Pipe** into the **Muffler** and install hangers into the factory rubber insulators. **Refer to Figure 5.**

4. Slide a **3.5" Band Clamp** onto the rear of the **Over Axle Pipe**. Feed the **Tail Pipe** onto the **Over Axle Pipe**.

5. Install the **Tail Pipe** hanger into the factory rubber insulator located directly above the hanger. **Refer to Figure 6.**



Figure 6

6. Loosely install and adjust the **Exhaust Tip** to suit. **Refer to Figure 6.**

7. Tighten all hardware and clamps, starting at the front and working rearward to secure the system. Check along the full length of the exhaust system to ensure there is adequate clearance for fuel lines, vent lines, brake lines, frame, bodywork, suspension, and any wiring, etc. If there is any interference detected, relocate, or adjust to provide adequate clearance. Ensure all clamp connections are secure and components are unable to rotate or slide. Band clamps require approximately 45 lb-ft (60 N-m) of torque. Verify clearances, system security and band clamp torque after 30-60 miles (50-100 km) of driving.



Congratulations! You are ready to begin experiencing the improved power, sound and driving excitement of your **MBRP** performance exhaust system. We know you will enjoy your purchase.