

# Heavy Duty Rear Bumper

## 2018 Jeep Wrangler JL Rear Bumper With/Without Parking Sensors

# RBM45/48JPN

02/27/18

### BUMPER HARDWARE KIT INCLUDES:

- (1) 4 – M10-1.50 x 35MM Hex Head Bolts
- (2) 4 – M10-1.50 Hex Head Nuts
- (3) 4 – M10 Lock Washers
- (4) 4 – M10 Plastic Push Nuts
- (5) 8 – M10 Flat Washers
- (6) 2 – M3-.50 x 20MM Allen Head Bolt
- (7) 2 – M3-.50 Serrated Flanged Nut
- (8) 4 – M6-1.00 x 12mm Hex Head Bolts
- (9) 4 – M6-1.00 Hex Head Nuts
- (10) 8 – M6 Flat Washers
- (11) 4 – M6 Lock Washers

### COMPONENTS LIST:

- (1) 1 – Magnum Rear Bumper (RBM45/48JPN)
- (2) 1 – License Plate Light (BP5185)
- (3) 1 – LED Brake Light (BP5273)
- (4) 2 – Outside Brackets (BP5874)
- (5) 4 – JL Sensor Tab (BP5878)

**LOOSE FIT ALL COMPONENTS.  
DO NOT TIGHTEN UNTIL ALL  
COMPONENTS ARE INSTALLED  
AND ADJUSTED.**



**ATTN:** STATE OF CALIFORNIA CONSUMERS  
**WARNING:** CANCER AND REPRODUCTIVE HARM  
WWW.P65WARNINGS.CA.GOV

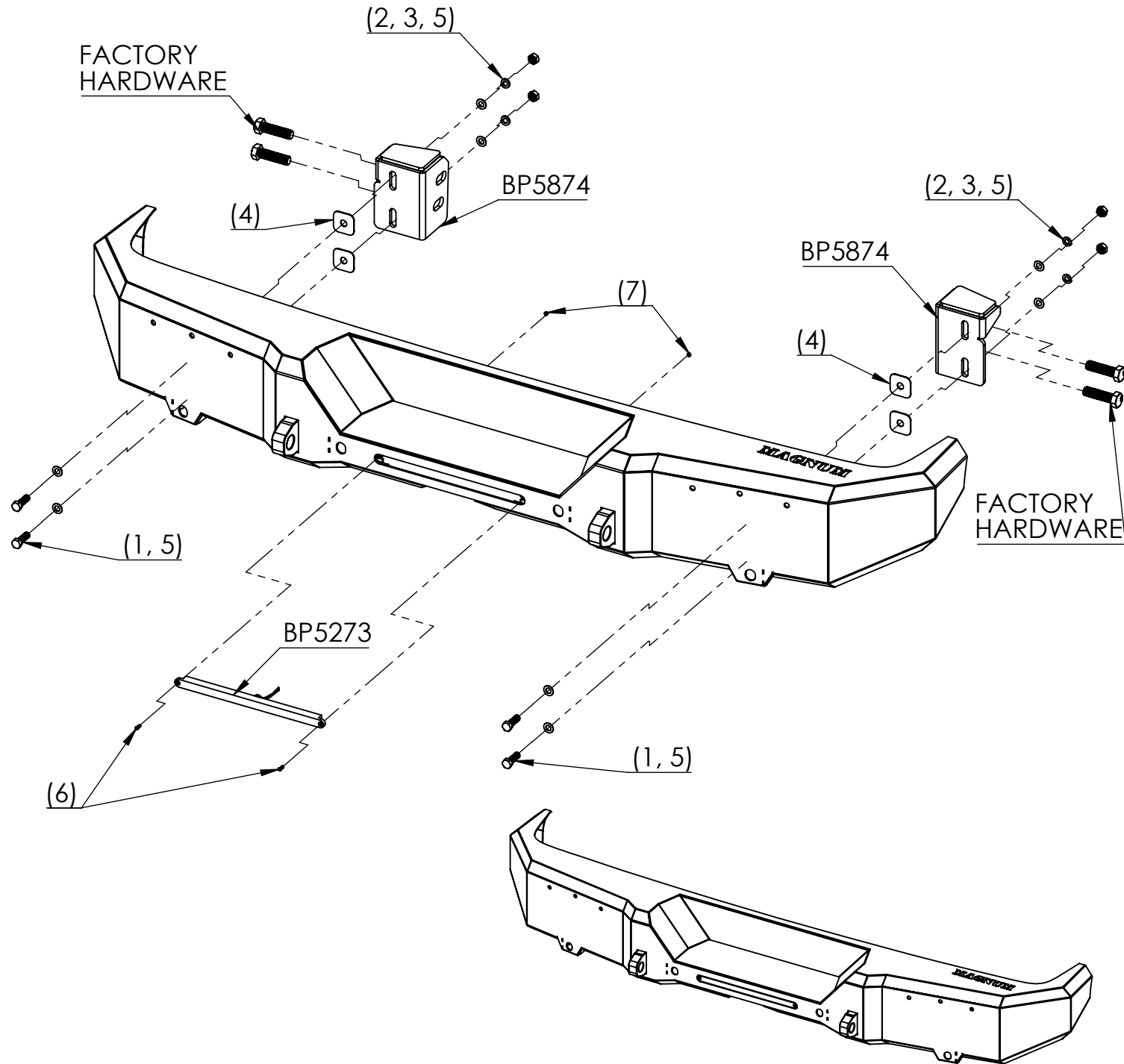

# Heavy Duty Rear Bumper

2018 Jeep Wrangler JL Rear Bumper With/Without Parking Sensors

# RBM45/48JPN

02/27/18

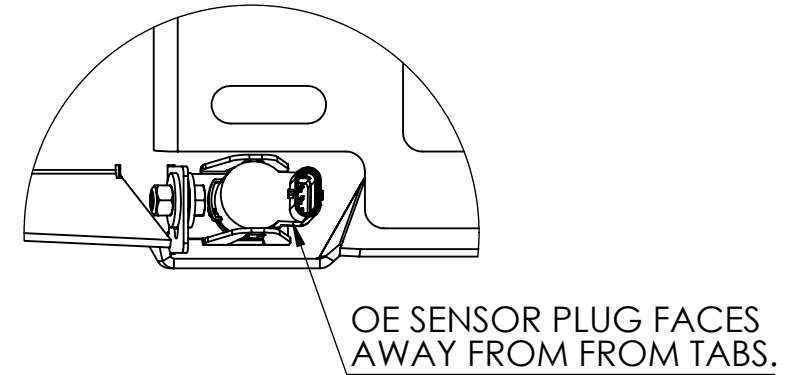
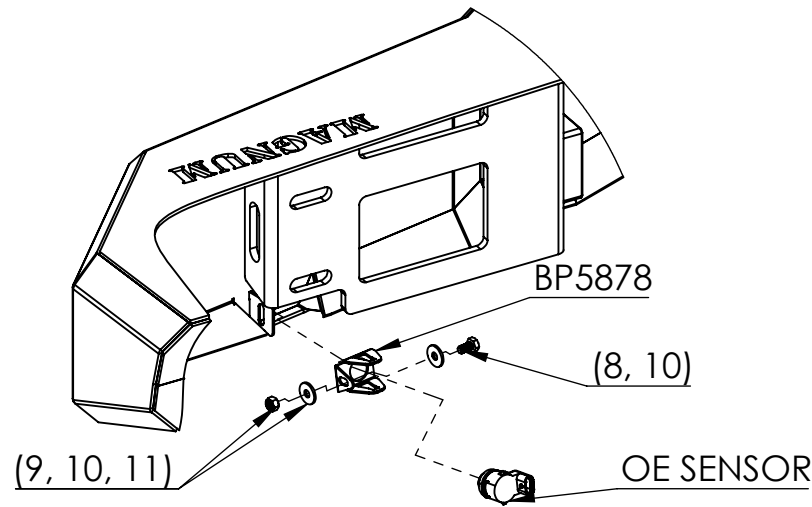

## MAGNUM BUMPER INSTALLATION INSTRUCTIONS:

- STEP 1.** Open the hood and disconnect the negative battery terminal
- STEP 2.** Begin by unplugging the rear bumper wiring harness (for License Plate Light and Sensors.)
- STEP 3.** Remove spare tire.
- STEP 4.** Remove (2) bolts holding the rear bumper to the frame of the vehicle. There are (2) per side, set aside this hardware for installation of Magnum Bumper. The factory tow hook should be held on by one extra bolt on the driver side in the bottom of the frame rail, you must remove this to complete removal of tow hook.
- STEP 5.** Remove (3) bolts holding the plastic wheel well cover to gain access to the side support brackets. Once these are removed, continue by removing the side support brackets. These are held on by (3) bolts, (1) to the frame and (2) to the bumper assembly. Repeat this step for opposite side.
- STEP 6.** Remove (2) bolts attaching bumper assembly to receiver. These are located on the bottom of the crossmember located between the frame rails.
- STEP 7.** Install Outside Brackets (BP5874) to the frame using the factory hardware removed previously in Step 2. Do not fully tighten yet.
- STEP 8.** Install provided (4) M10 bolts and flat washers into Magnum Bumper using the provided (4) M10 Plastic Push Nuts.
- STEP 9.** With help, attach bumper to the outside brackets and loosely tighten using provided M10 Flat Washers, Lock Washers, Hex Nuts.
- STEP 10.** With the Magnum Bumper now attached, align, and tighten all hardware from outside brackets to the frame, followed by bumper to outside brackets. ICI recommends leaving an 1/8"-3/16" gap between the bumper and the body of the vehicle to prevent and contact in the future.
- STEP 11.** Re-Install spare tire and (if Equipped) remove all sensors with harness from factory bumper and install into Magnum Bumper at this time.
- STEP 12.** Plug in factory wiring harness to sensor harness and ensure sensors are working properly (sensors may need to be adjusted up and down to eliminate any warnings, the bracket that OE sensors are installed into allow +/- 10 degrees of adjustment up/down. Once you have the sensors angled as needed tighten all provided M6 hardware and check for any faults. Tabs can also be pried open slightly to relieve tension on sides of OE sensors which can sometimes trigger warnings.)
- STEP 13.** Wire License Plate Light (BP5185) and Third Brake Light/Running Light (BP5273) using provided Installation Instructions.

# RBM45/48JPN - 2018 JEEP WRANGLER JL THIRD BRAKE LIGHT INSTALLATION INSTRUCTIONS

1. Install LED light into rear bumper using provided hardware.

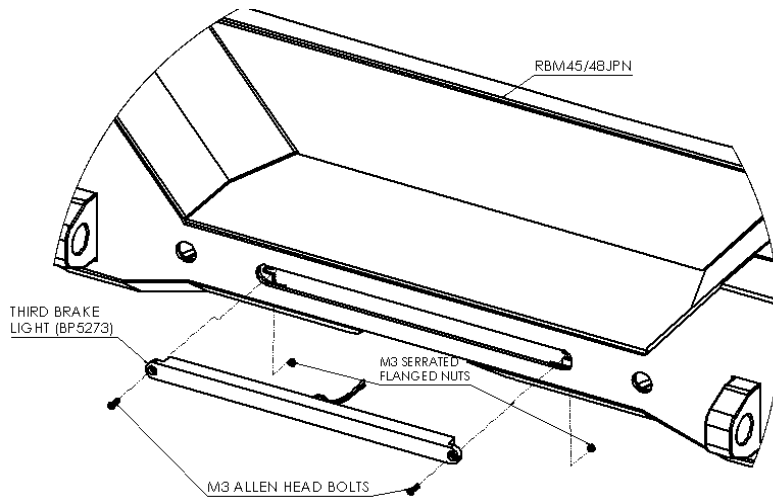

2. Remove rear passenger side tail light by unscrewing two screws closest to the spare tire.
3. Using a test light, determine which wire is for the running lights and mark it.
4. Open tail gate and remove plastic panels on back side of tail gate by gently pulling until the clips release.



## RBM45/48JPN - 2018 JEEP WRANGLER JL THIRD BRAKE LIGHT INSTALLATION INSTRUCTIONS



5. Remove plastic trim panel in passenger side rear corner of vehicle by gently pulling on the top corner until the clip releases.



## RBM45/48JPN - 2018 JEEP WRANGLER JL THIRD BRAKE LIGHT INSTALLATION INSTRUCTIONS

- Using a test light, locate the wires for the factory third brake light and determine which is positive and negative, mark them accordingly behind the panel inside the rear passenger side corner. Once marked, replace the two plastic panels on the back of the tail gate.



- Once all (3) wires have been located and marked, disconnect negative battery terminal.
- You will need to route and extend the wires on the LED third brake light to reach the factory wiring. The WHITE and RED wires go from the LED third brake light to the panel in the rear passenger side where the wires for the factory third brake light were located. These wires can be routed between the bumper and body and underneath the weather stripping, be careful it does not get pinched by the tail gate. Quick splice the WHITE wire to the negative from the factory third brake light and the RED wire to the positive from the factory third brake light. The Black wire goes to the driver side rear tail light, quick splice it to the wire for the running lights.



## **RBM45/48JPN - 2018 JEEP WRANGLER JL THIRD BRAKE LIGHT INSTALLATION INSTRUCTIONS**

9. Once all wires are connected, snap trim panel back into place and reinstall tail light, be careful no wires are going to get pinched by the tail gate hinge, panel, tail light or anything else.
10. Reconnect negative battery terminal and test the LED third brake light. The light should come on with the headlights and it should shine brighter when the brakes are applied.

