



## Bolt-On Bed Rail

Part No. D0011S/B

Fits: 2020-2021 SILVERADO 2500-3500 6-1/2FT "STANDARD" BED  
2020-2021 SIERRA 25-3500 6-1/2FT "STANDARD" BED ( EXCLUDING  
CARBON FIBER BEDS)



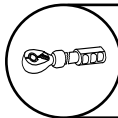
RATCHET, SOCKET SET AND WRENCH SET



REMOVE CONTENTS FROM BOX. VERIFY ALL PARTS ARE PRESENT



READ INSTRUCTIONS CAREFULLY BEFORE STARTING INSTALLATION



M10 BOLT

COATED HARDWARE  
37 FOOT POUND

SS HARDWARE  
24 FOOT POUND



60 mins



CUTTING IS  
REQUIRED



DRILLING NOT  
REQUIRED



support@trailfx.com



1- (866) 638 - 4870



POLISHED STAINLESS STEEL - LIMITED LIFETIME  
POWDER COATED BLACK - 3 YEARS

### PARTS LIST:

Qty	Part Description	Qty	Part Description
1	Driver/Left Bed Rail	2	10mm x 25mm Hex Bolts
1	Passenger/Right Bed Rail	6	10mm Lock Washers
2	80mm Rectangular Threaded Brackets	2	10mm x 34mm x 3mm Large Flat Washers
2	10mm Double Nut Plates	4	10mm x 20mm x 1.5mm S/Steel Flat Washers
4	10-1.50mm x 50mm Allen Head Bolts	1	3mm Wrench
		1	6mm Wrench

### PROCEDURE:

- REMOVE CONTENTS FROM BOX. VERIFY ALL PARTS ARE PRESENT. READ INSTRUCTIONS CAREFULLY BEFORE STARTING INSTALLATION. CUTTING MAY BE REQUIRED. VERIFY BEDRAIL IS CORRECT LENGTH TO COVER BOTH STAKE POCKETS BEFORE CUTTING BEDSIDE COVERS!**
- Start installation at the passenger side rear stake pocket, **(Figure 1)**. Select (1) 10mm Double Nut Bracket, **(Figure 2A)**. Remove the rubber plug in the side of the stake pocket. Insert the Bracket into the large rear stake pocket. Bolt the lower end of the Bracket to the hole in the side of the stake pocket with (1) 10mm x 25mm Hex Bolt, (1) 10mm Lock Washer and (1) 10mm x 34mm Large Flat Washer, **(Figure 2B)**. Snug but do not fully tighten hardware.
- Move to the front stake pocket. Carefully cut along the factory lines molded into the plastic cover, **(Figure 3)**. **IMPORTANT:** The factory lines may not represent the correct location or size of the stake pocket and may be larger than the actual stake pocket opening. **Be very careful** cutting through the plastic cover to avoid damage to the top of the bed.
- Select the passenger/right side Bed Rail. Insert (1) 10mm x 50mm Button Head Allen Bolt, (1) 10mm Lock Washer and (1) 10mm Small Flat Washer through the front mounting plate and into (1) Threaded Plate as illustrated in **Figure 4**. **NOTE:** Two types of Threaded Plates are included in the kit, **(Figures 6A & 6B)**. Use the largest Plate possible to fit across the inside of the stake pocket. Leave hardware loose at this time.
- With the hardware loose in the front mounting plate, carefully position the Bed Rail onto the top of the bed. Tilt the Bolt and/or Bedrail side to side to slide the Threaded Plate into and under the lip on both sides of the steel part of the stake pocket, **(Figure 5)**. Use the largest Plate possible to fit across the inside of the stake pocket, **(Figures 6A & 6B)**. Snug but do not tighten hardware at this time.
- Move to the rear location. Line up the hole in the mounting plate on the Bed Rail with the 10mm Nut Plate Bracket inside the stake pocket, **(see Step 2, Fig. 2B)**. Secure the Bed Rail to the Bracket with (1) 10mm x 50mm Button Head Allen Bolt, (1) 10mm Lock Washer and (1) 10mm Small Flat Washer, **(Figure 7)**. Do not tighten hardware at this time.
- Line up the front and rear of the Bed Rail with the top of the bed and tighten all hardware. To tighten the front mounting position, pull up on the Bed Rail to hold the Threaded Plate in place and centered

across the pocket. Keep pulling up on the Bed Rail to prevent the Plate from moving/rotating while tightening the 10mm mounting bolt, **(Figure 6A & 6B)**.

8. Repeat **Steps 2—7** for driver side Bed Rail installation.
9. Do periodic inspections to the installation to make sure that all hardware is secure and tight.

**To protect your investment**, wax this product after installing. Regular waxing is recommended to add a protective layer over the finish. Do not use any type of polish or wax that may contain abrasives that could damage the finish.

**For stainless steel:** Aluminum polish may be used to polish small scratches and scuffs on the finish. Mild soap may be used also to clean the Bed Rails.

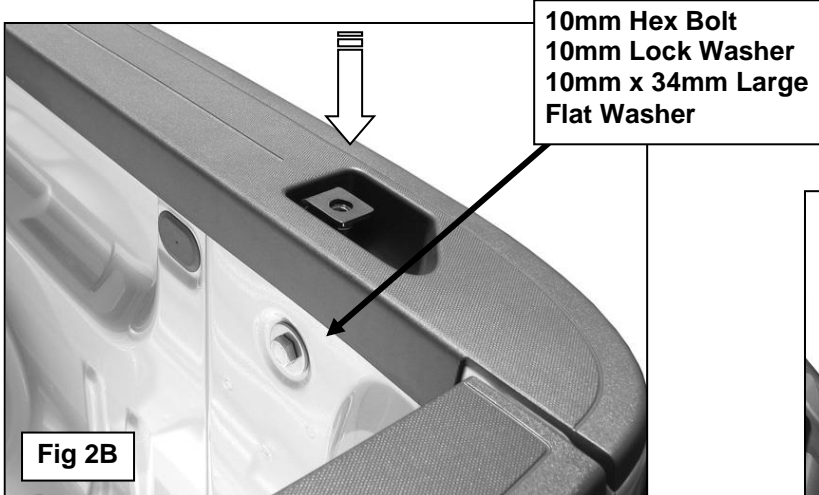
### Passenger Side Installation Pictured



**(Fig 1)** Remove rubber plug from side of rear stake pocket

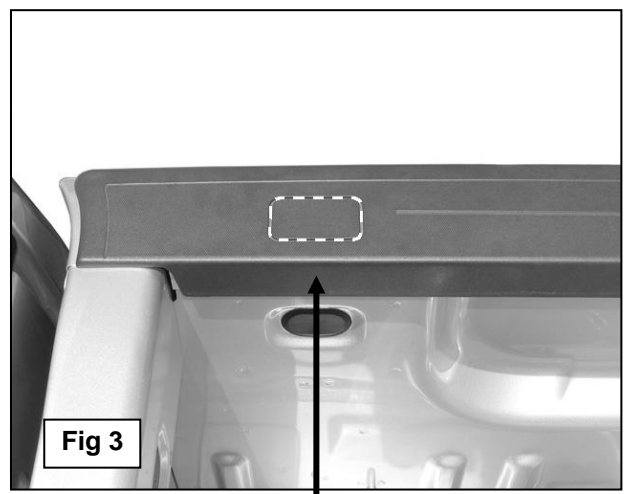


**Fig 2A**



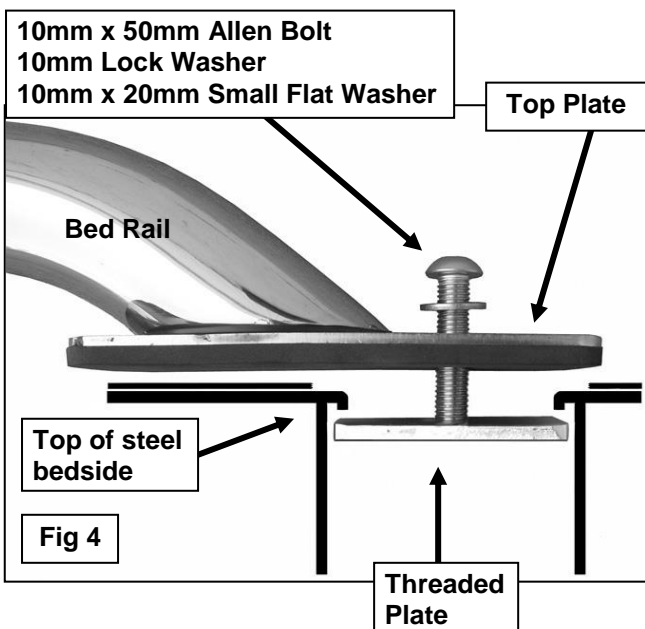
10mm Hex Bolt  
10mm Lock Washer  
10mm x 34mm Large Flat Washer

**Fig 2B**



**Fig 3**

Follow the factory guide lines to cut out the cover over the front stake pocket. The guide lines in the cover may not represent the actual size of the stake pocket. Be very careful cutting through the plastic cover to avoid damage to the top of the bed.



10mm x 50mm Allen Bolt  
10mm Lock Washer  
10mm x 20mm Small Flat Washer

Top Plate

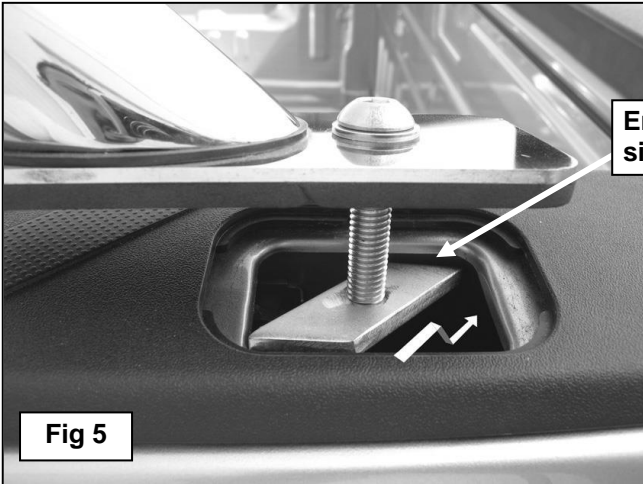
Bed Rail

Top of steel bedside

Threaded Plate

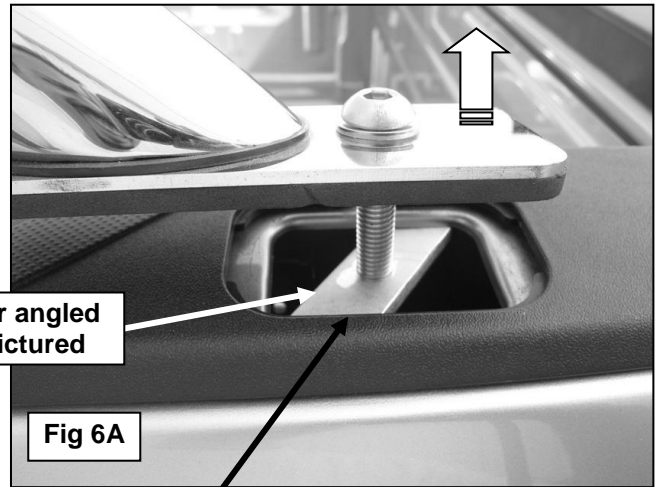
**Fig 4**

Thin black line represents plastic bed cover



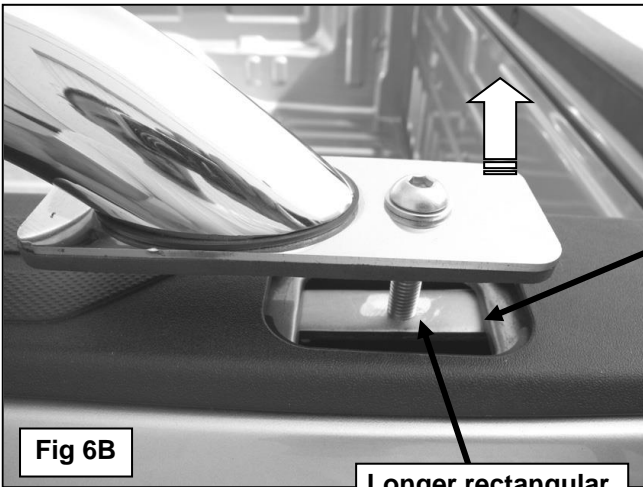
Engage one side first

Fig 5



Smaller angled plate pictured

Fig 6A



Longer rectangular plate pictured

Fig 6B

Pull up on Bedrail as you slowly tighten the mounting screw to hold the threaded plate in place against inside of stake pocket

- 10mm x 50mm Allen Bolt
- 10mm Lock Washer
- 10mm x 20mm Small Flat Washer

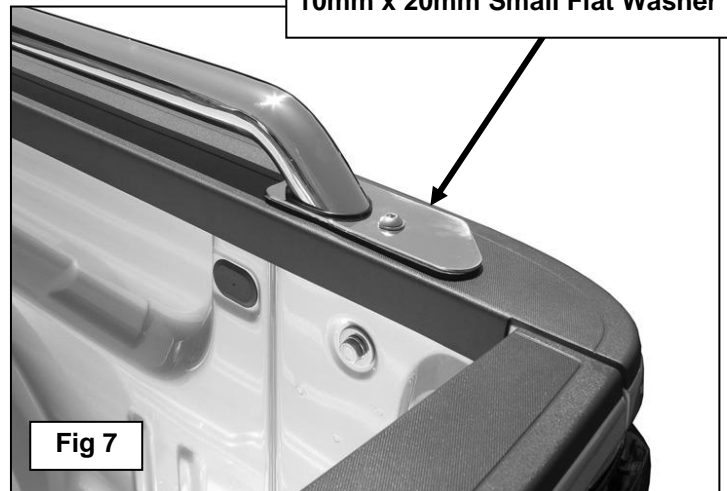


Fig 7



Complete Installation

**PRODUCT CARE**

- Periodically check the product to ensure all fasteners are tight and components are intact.
- Regular waxing is recommended to protect the finish of the product.
- **Use ONLY Non-Abrasive automotive wax.** Use of any soap, polish or wax that contains an abrasive is detrimental and can scratch the finish leading to corrosion.
- Aluminum polish may be used to polish small scratches and scuffs for **Stainless Steel finish.**
- Mild soap may be used to clean the product for both **Stainless Steel and Black finish.**

**FAQ's****1. Hardware and mounting brackets are not aligning properly**

*Ensure that hardware is being used on the correct side of the vehicle. In some cases, the hardware may appear same for driver or passenger side but may alter the alignment of mounting location. Check mounting brackets for both sides.*

**2. Products are thumping / rattling after installation.**

*Ensure that all required mounting brackets / hardware's are installed & tighten correctly. Suggest using white lithium / regular grease between metal to metal contact.*

**3. Missing / Excess Hardware.**

*Recheck hardware count as per the part list.*

**4. Product not installing properly.**

*Ensure the Year / Make / Model as well as cab and bed dimensions are correct for the application. Review all steps for installation to ensure they were followed correctly.*

**5. Who should be contacted for questions regarding product / installation assistance?**

*www.trailfx.com / support@trailfx.com 1-(866) 638-4870*

**Check out these other TrailFX Products!****www.trailfx.com****BULL BAR****GRILLE GUARDS****BED RAILS****RUNNING BOARDS**

*Keystone Automotive Operations Inc. (KAO) warrants this product to be free of defects in material and workmanship at the time of purchase by the original retail consumer. KAO disclaims any other warranties, express or implied, including the warranty of fitness for a particular purpose or an intended use. If the product is found to be defective, KAO may replace or repair the product at our option, when the product is returned prepaid, with proof of purchase. Alteration to, improper installation, or misuse of this product voids the warranty. KAO's liability is limited to repair or replacement of products found to be defective, and specifically excludes liability for any incidental or consequential loss or damage.*