

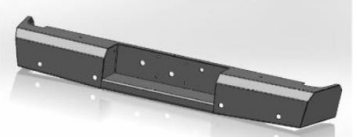

Replacement Rear Bumper

Part No. FX1011



Fits: 2007-2013

Toyota Tundra



ASSISTANCE IS RECOMMENDED.



REMOVE CONTENTS FROM BOX. VERIFY ALL PARTS ARE PRESENT.



READ INSTRUCTIONS CAREFULLY BEFORE STARTING INSTALLATION.

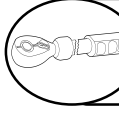

DO NOT OVER TORQUE. STANDARD OPERATING LOAD FOR TIGHTEN BODY MOUNT NUTS & BOLTS VARIES FROM 45 TO 65 FOOT POUND.



60-180 min

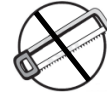

Cutting Not Required



Drilling Not Required



support@trailfx.com



1 866 638 4870



POLISHED STAINLESS STEEL – LIMITED LIFETIME
POWDER COATED BLACK – 3 YEARS

PARTS LIST:

Qty	Part Description	Qty	Part Description
1	Replacement Rear Bumper	8	12mm Lock Washers
4	5x20mm Philips Screws	8	12mm Hex Nuts
4	Plastics Plugs	6	14x1.5x55mm Hex Bolts
8	5mm Lock Washers	6	14x44x3mm Lock Washers
4	5mm Hex Nuts	6	14mm Lock Washers
4	5mm Lock Washers	8	4x10mm Button Head Allen Bolts
1	License Plate Light	1	Allen Wrench
1	Driver/Left Side Mounting Bracket	4	Rubber Sensor Plugs
1	Passenger/Right Side Mounting Bracket	2	Wiring
4	Bolt Plate		
8	12x32x3mm Lock Washers		

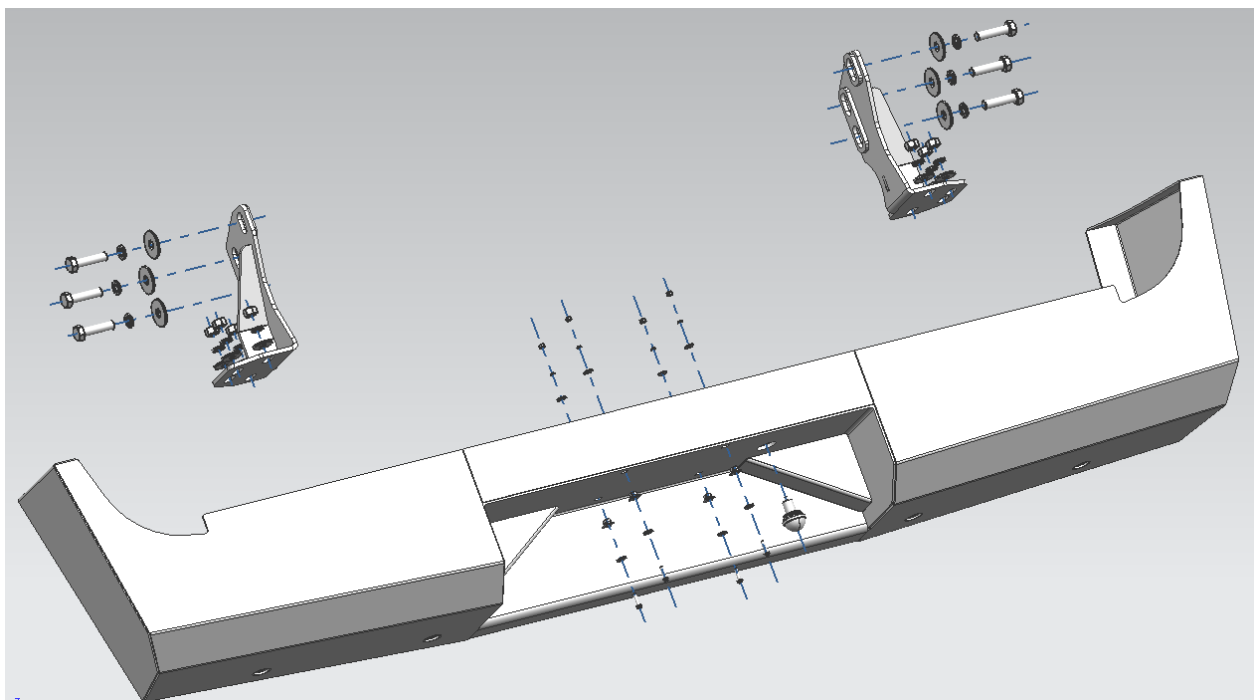

INSTALLATION PROCEDURE

BUMPER IS HEAVY, ASSISTANCE IS HIGHLY RECOMMENDED TO AVOID POSSIBLE INJURY OR DAMAGE TO THE VEHICLE.

Vehicle Preparation

1. Using a Philip's head screwdriver remove the license plate light s from each side of the OEM bumper. Disconnect the harness on the back side of the light to remove fully. Secure the harness out of harm's way to the frame.
2. Removed your license plate from the OEM bumper.
3. Remove the plastic corner pieces from the top of the OEM bumper by pulling up from the outside edge. If the plastic is being stubborn during removal the plastic clips can be popped loose from the bottom side of the bumper (**Fig 1**).



Fig 1

4. Remove the Philips head screw passing through the plastic that was hidden by the license plate previously (**Fig 2A & 2B**).



Fig 2A



Fig 2B

5. Pop the plastic clips loose on the bottom side of the main piece of plastic on the top side of the bumper allowing access to the OEM fasteners.
6. Using a 12mm wrench remove the eight OEM fasteners holding the OEM bumper shell to the receiver hitch.
7. Remove the OEM bumper and set aside.
8. Your truck is ready for the installation of your new bumper now.

Bumper Installation

1. Install the license plate on the replacement rear bumper with the hardware (**Fig 3**).

5x20mm Philips Screws
Plastics Plugs
5mm Lock Washers
5mm Hex Nuts
5mm Lock Washers

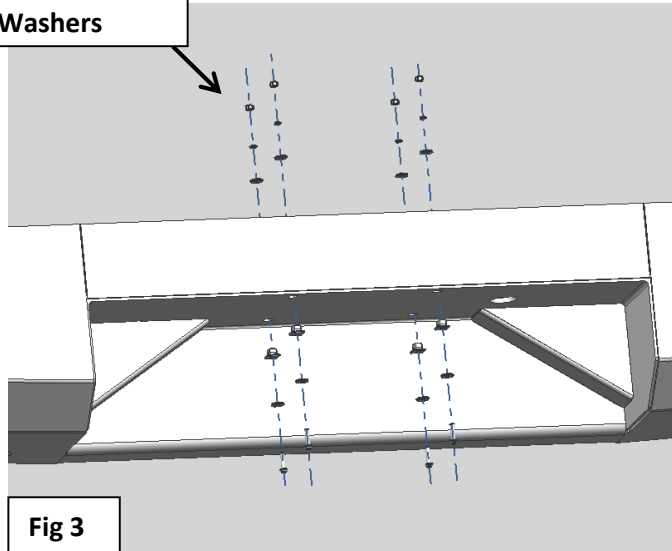

Fig 3

2. Install license plate light on the replacement bumper with hardware (**Fig 4**), please pay attention to the orientation of the light.

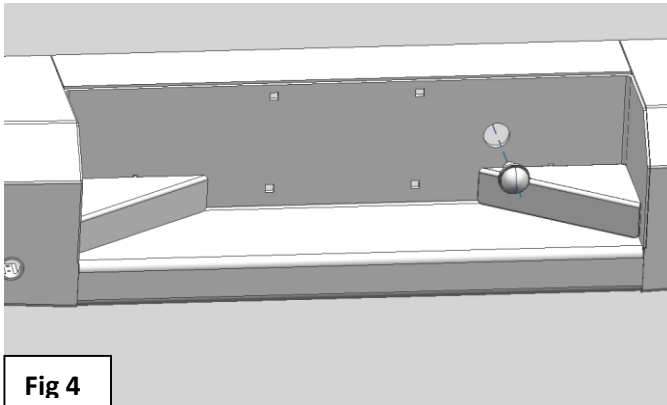

Fig 4

3. Install the mounting brackets on the replacement rear bumper with the hardware (**Fig 5A & 5B**).

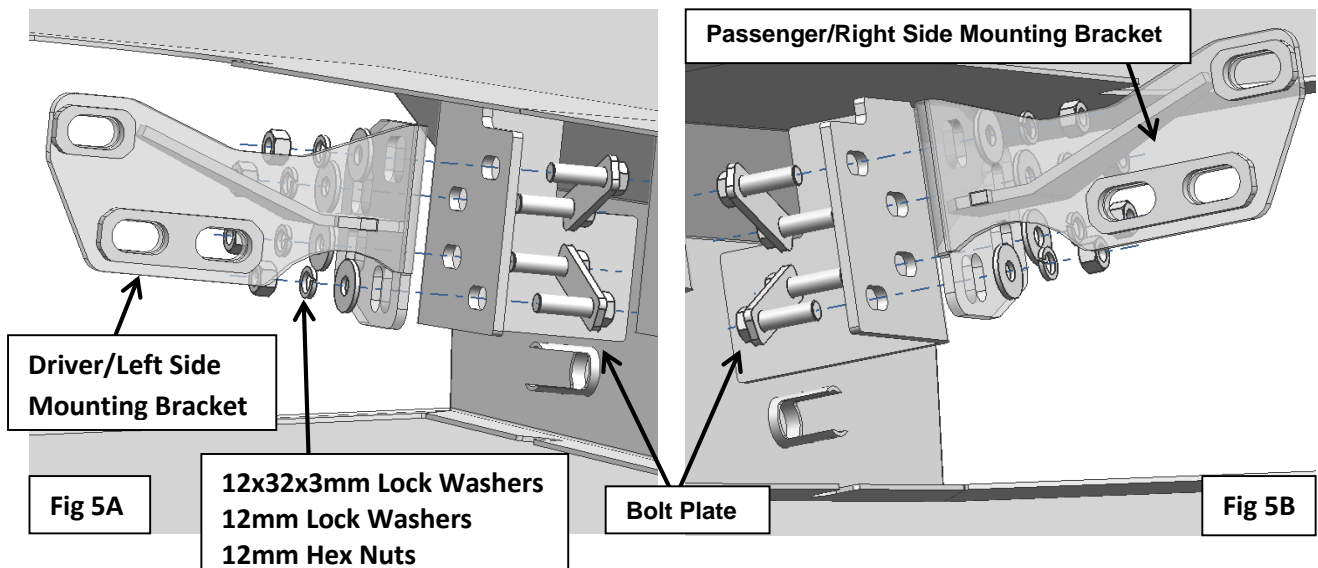

Fig 5A

12x32x3mm Lock Washers
12mm Lock Washers
12mm Hex Nuts

Bolt Plate

Fig 5B

4. Install the sensor sleeves into the sensor hole. If the sensor is not equipped, install the provided plugs into the sleeves (**Fig 6A**). If the sensor is equipped, install the OEM sensor with the hardware (**Fig 6B**).

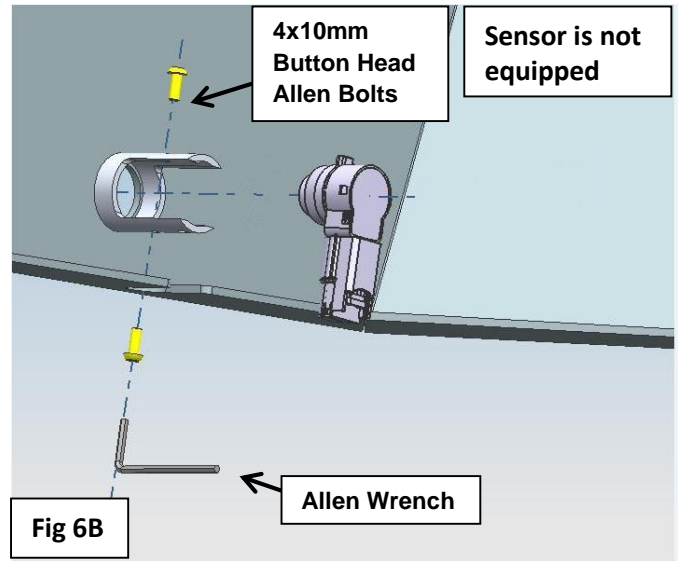
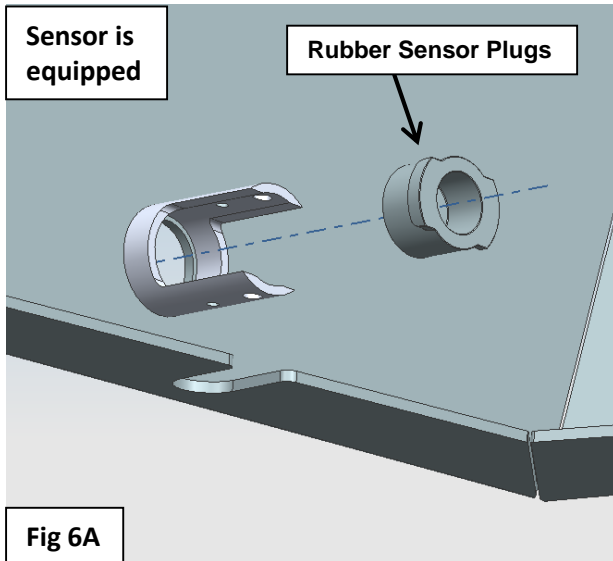

5. Install the replacement rear bumper on the vehicle, fasten the hardware,

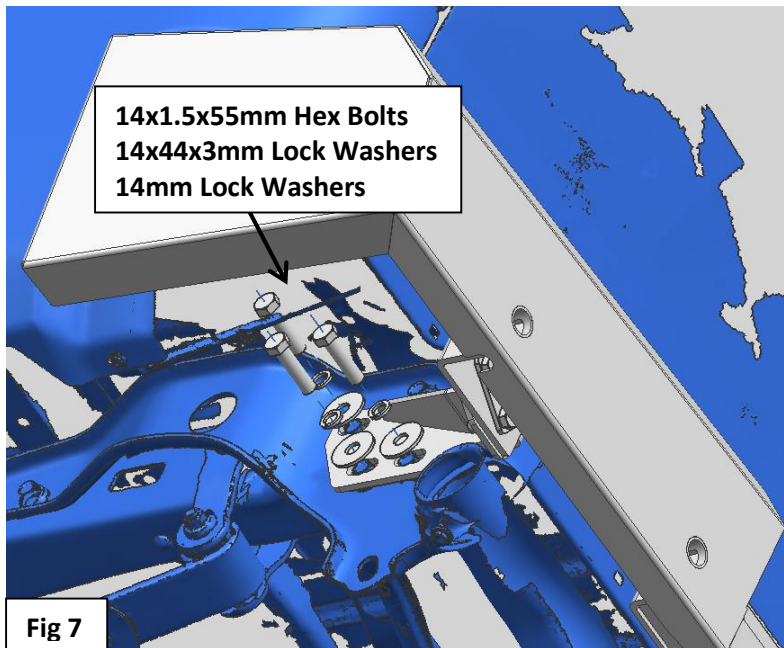

6. Connect the wiring for the license plate light and the sensor, make sure they work.
 7. Recheck and confirm if the gap between the bumper and the vehicle.
 8. Installation is finished, pick up all tools.

PRODUCT CARE

- Periodically check the product to ensure all fasteners are tight and components are intact.
- Regular waxing is recommended to protect the finish of the product.
- **Use ONLY Non-Abrasive automotive wax.** Use of any soap, polish or wax that contains an abrasive is detrimental and can scratch the finish leading to corrosion.
- Aluminum polish may be used to polish small scratches and scuffs for **Stainless Steel finish.**
- Mild soap may be used to clean the product for both **Stainless Steel and Black finish.**

FAQ's**1. Hardware's are not of correct size.**

In GMC / Chevrolet truck model 2006 & up, customer needs to reuse the factory body bolts to install the bracket. If your vehicle is not GMC / Chevrolet 2006 & up, ensure that holes are not partially covered with any plastic grommet or rust? If it is, remove the plastic grommet & rust from the thread holes & re-try the installation.

2. Mounting Bracket are not getting Installed properly.

In some cases Illustration images shown in Installation manual may not be the exactly same as per actual vehicle images ,also if Driver / Passenger side mounting brackets are very identical in the design, suggest referring Parts Identification guide to avoid fitment issue.

3. Products are thumping / rattling after installation.

Ensure that all required mounting brackets / hardware's are installed & tighten correctly. Suggest using white lithium / regular grease between the metal to metal contact surfaces.

4. Side Bar is not aligning with vehicle / Step Pads are not aligning with vehicle doors.

Side bar may be interchanged or mounting brackets are not installed at the correct position in the vehicle. Refer Parts identification guide.

5. Missing / Excess Hardware.

Recheck hardware count as per the part list.

6. Product not installing properly.

Ensure make model year, cab length and bed size of your vehicle is listed in the application. All installation steps are followed correctly.

Check out these other TrailFX Products!!

www.TrailFX.com



SIDE BAR

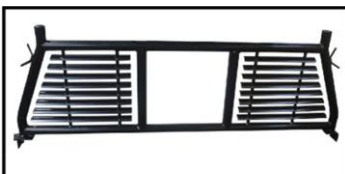

HEADACHE RACKS

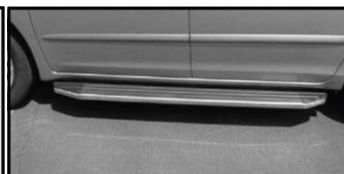

RUNNING BOARDS



ROCKER GUARDS

Keystone Automotive Operations Inc. (KAO) warrants this product to be free of defects in material and workmanship at the time of purchase by the original retail consumer. KAO disclaims any other warranties, express or implied, including the warranty of fitness for a particular purpose or an intended use. If the product is found to be defective, KAO may replace or repair the product at our option, when the product is returned prepaid, with proof of purchase. Alteration to, improper installation, or misuse of this product voids the warranty. KAO's liability is limited to repair or replacement of products found to be defective, and specifically excludes liability for any incidental or consequential loss or damage.