

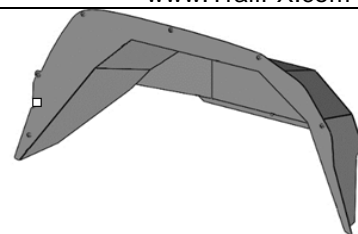

REAR FENDER LINERS

Part No. JL010RI



Fits: Current JEEP GLADIATOR



REMOVE CONTENTS FROM BOX. VERIFY ALL PARTS ARE PRESENT.



READ INSTRUCTIONS CAREFULLY BEFORE STARTING INSTALLATION.

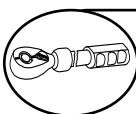

DO NOT OVER TORQUE. USE STANDARD OPERATING LOAD FOR TIGHTENING BODY MOUNT NUTS & BOLTS VARIES



60-180 min



Cutting Not Required



Drilling Not Required



support@trailfx.com



1 866 638 4870



POLISHED STAINLESS STEEL – LIMITED LIFETIME
POWDER COATED BLACK – 3 YEARS

PARTS LIST:

Qty	Part Description	Qty	Part Description
1	Driver/Left Fender Liner	6	6mm Clip Nuts
1	Passenger/Right Fender Liner Front	1	4mm Hex Wrench
18	6-1.0mm x 20mm Button Head Combo Bolts		

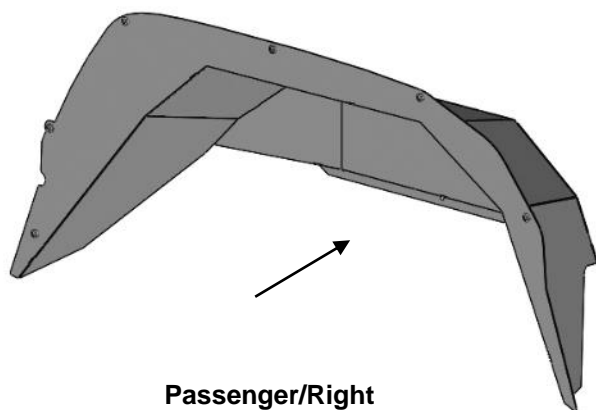

Passenger/Right
Fender Liner

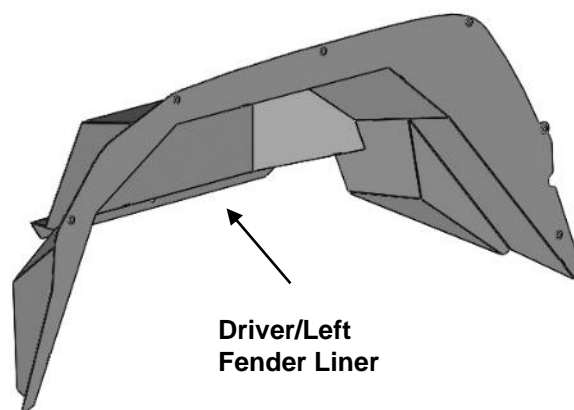

Driver/Left
Fender Liner

PROCEDURE:

REMOVE CONTENTS FROM BOX. VERIFY ALL PARTS ARE PRESENT. READ INSTRUCTIONS CAREFULLY. ASSISTANCE IS RECOMMENDED.

1. Start installation in the Driver/Left wheel well. Locate the tabs along the bottom of the wheel well above the frame, **(Figure 1)**. **NOTE:** The factory fender liner is attached to these tabs.
2. Select (3) 6mm Clip Nuts. Slide the Clip Nuts onto the (3) inner mounting tabs, **(Figure 1)**.
3. Select the Driver/Left Rear Fender Liner. Insert the Fender Liner into position up to the back of the inner body panel. **IMPORTANT:** If the vehicle has aftermarket fenders previously installed, it may be necessary to temporarily remove any hardware interfering with the Fender Liners. **NOTE:** It may be easier to install the Fender Liner with the vehicle raised up and/or rear tire removed.
4. Attach the bottom of the Fender Liner to the (3) 6mm Clip Nuts with (3) 6mm Button Head Combo Bolts, **(Figure 2)**. Do not tighten hardware.

5. Attach the Fender Liner to the (6) mounting locations with (6) 6mm Button Head Combo Bolts, **(Figures 3—5)**. Do not tighten hardware.
6. Align and adjust the Fender Liner. Fully tighten all hardware attaching the Fender Liner and fender.
7. Repeat **Steps 1—6** for Passenger/Right side Fender Liner installation.
8. Do periodic inspections to the installation to make sure that all hardware is secure and tight.

To protect your investment, Do not use any type of polish or wax that may contain abrasives that could damage the finish. Mild soap may be used to clean the Fender Liners.

Driver/Left Side Installation Pictured



(Fig 1) Remove the factory clip nuts and slide (3) 6mm Clip Nuts onto the (3) mounting holes inside the wheel well

(3) 6mm Button Head Combo Bolts
(3) 6mm Clip Nuts

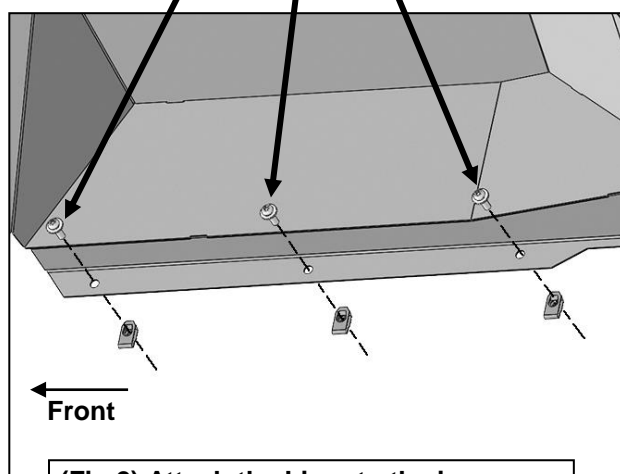

(Fig 2) Attach the Liner to the inner body panel. **(NOTE: Slide the (3) Clip Nuts onto the panel first)**

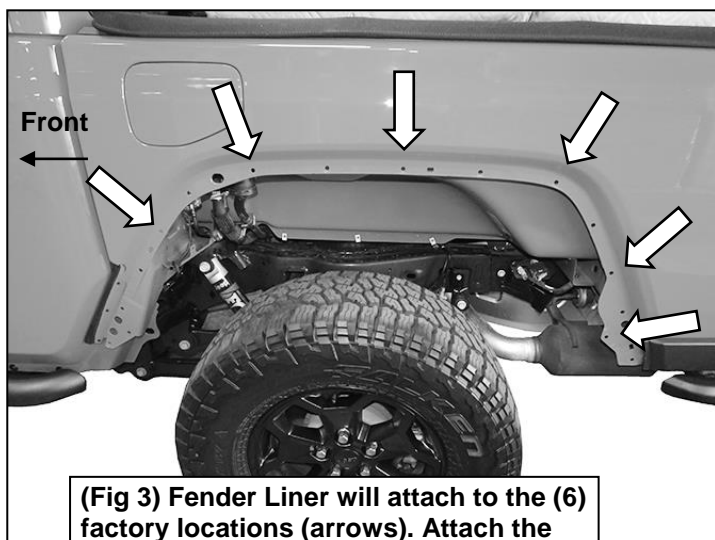

(Fig 3) Fender Liner will attach to the (6) factory locations (arrows). Attach the Fender Liner to these mounting points

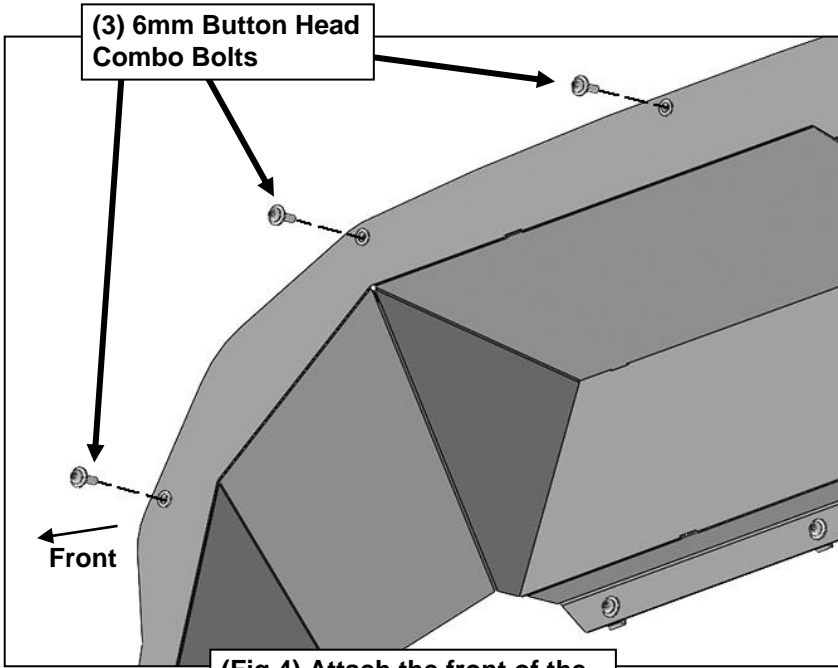

(Fig 4) Attach the front of the Fender Liner to the wheel well

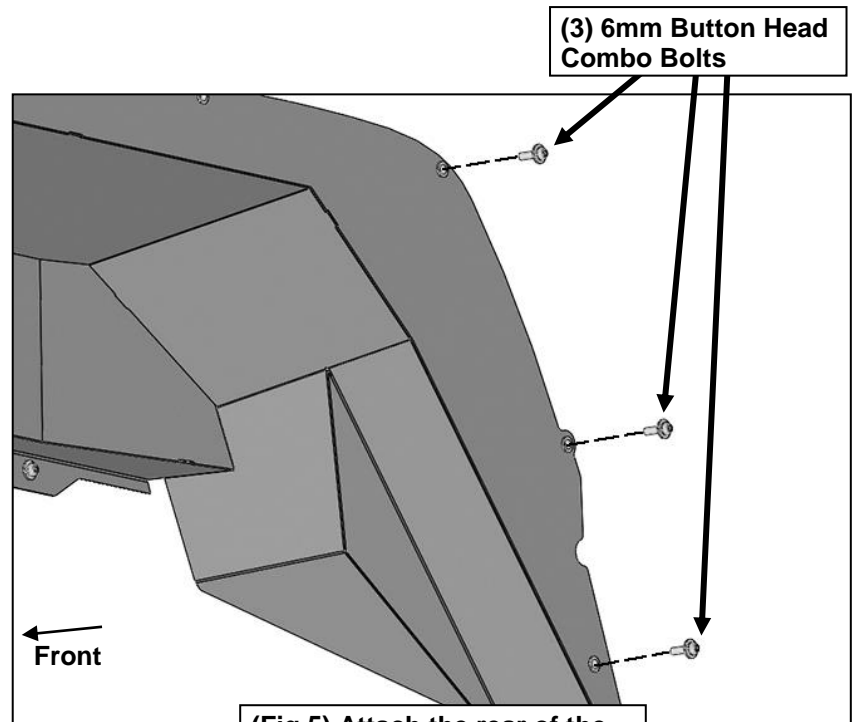

(Fig 5) Attach the rear of the Fender Liner to the wheel well

PRODUCT CARE

- Periodically check the product to ensure all fasteners are tight and components are intact.
- Regular waxing is recommended to protect the finish of the product.
- **Use ONLY Non-Abrasive automotive wax.** Use of any soap, polish or wax that contains an abrasive is detrimental and can scratch the finish leading to corrosion.
- Aluminum polish may be used to polish small scratches and scuffs for **Stainless Steel finish.**
- Mild soap may be used to clean the product for both **Stainless Steel and Black finish.**

FAQ'S

1. Hardware's are not of correct size.

In GMC / Chevrolet truck model 2006 & up, customer needs to reuse the factory body bolts to install the bracket. If your vehicle is not GMC / Chevrolet 2006 & up, ensure that holes are not partially covered with any plastic grommet or rust? If it is, remove the plastic grommet & rust from the thread holes & re-try the installation.

2. Mounting Bracket are not getting Installed properly.

In some cases Illustration images shown in Installation manual may not be the exactly same as per actual vehicle images ,also if Driver / Passenger side mounting brackets are very identical in the design, suggest referring Parts Identification guide to avoid fitment issue.

3. Products are thumping / rattling after installation.

Ensure that all required mounting brackets / hardware's are installed & tighten correctly. Suggest using white lithium / regular grease between the metal to metal contact surfaces.

4. Side Bar is not aligning with vehicle / Step Pads are not aligning with vehicle doors.

Side bar may be interchanged or mounting brackets are not installed at the correct position in the vehicle. Refer Parts identification guide.

5. Missing / Excess Hardware.

Recheck hardware count as per the part list.

6. Product not installing properly.

Ensure make model year, cab length and bed size of your vehicle is listed in the application. All installation steps are followed correctly.

Check out these other TrailFX Products!!

www.TrailFX.com



BULL BAR



GRILLE GUARDS



BED RAILS

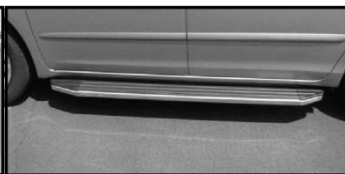

RUNNING BOARDS



RUNNING BOARDS



RUNNING BOARDS

Free of defects in material and workmanship at the time of purchase by the manufacturer, including the warranty of fitness for a particular purpose or an implied warranty, when the product is returned prepaid, the return of this product voids the warranty. KAO's liability is limited to repair or replacement of the product for any incidental or consequential loss or damage.