

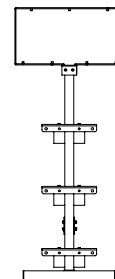

Winch Display Rack

Part No. WA013



Fits: TrailFX Winches - W08B, W10B, W12B & WS10B



REMOVE CONTENTS FROM BOX. VERIFY ALL PARTS ARE PRESENT.



45-60 min



Cutting Not
Required



Drilling Not
Required



READ INSTRUCTIONS CAREFULLY BEFORE STARTING INSTALLATION.



support@trailfx.com



LIMITED LIFETIME WARRANTY



1 866 638 4870

PARTS LIST:

Item	Part Details	Qty	Item	Part Details	Qty
1	Base Frame	1	7	Winch Mounting Plate	3
2	Support Bracket - Left	3	8	M8 X 70 Hex Bolts	12
3	Support Bracket - Right	3	9	Main Frame	1
4	M8 X 22 Hex Bolt	14	10	Washer	26
5	Support Frame	1	11	Header Card Frame	1
6	M8 Hex Nut	26	12	Header Card	1

INSTALLATION PROCEDURE

- Place the base frame on the floor.
- Assemble main frame & support frame with base frame using M8 X 70 hex bolts, M8 hex nuts & Washers.
- Assemble Left & Right Support brackets with the main Frame using M8 X 22 hex bolts, M8 hex nuts & Washers.
- Assemble Winch mounting plate on the support brackets using M8 X 22 hex bolts, M8 hex nuts & Washers.
- Insert the header card frame on top of the main frame and assemble using M8 X 22 hex bolts, M8 hex nuts & Washers.
- Slide the header card inside the frame.
- Mount the winches on the mounting plate.
- Display Rack is ready for use.

Assembly Drawing

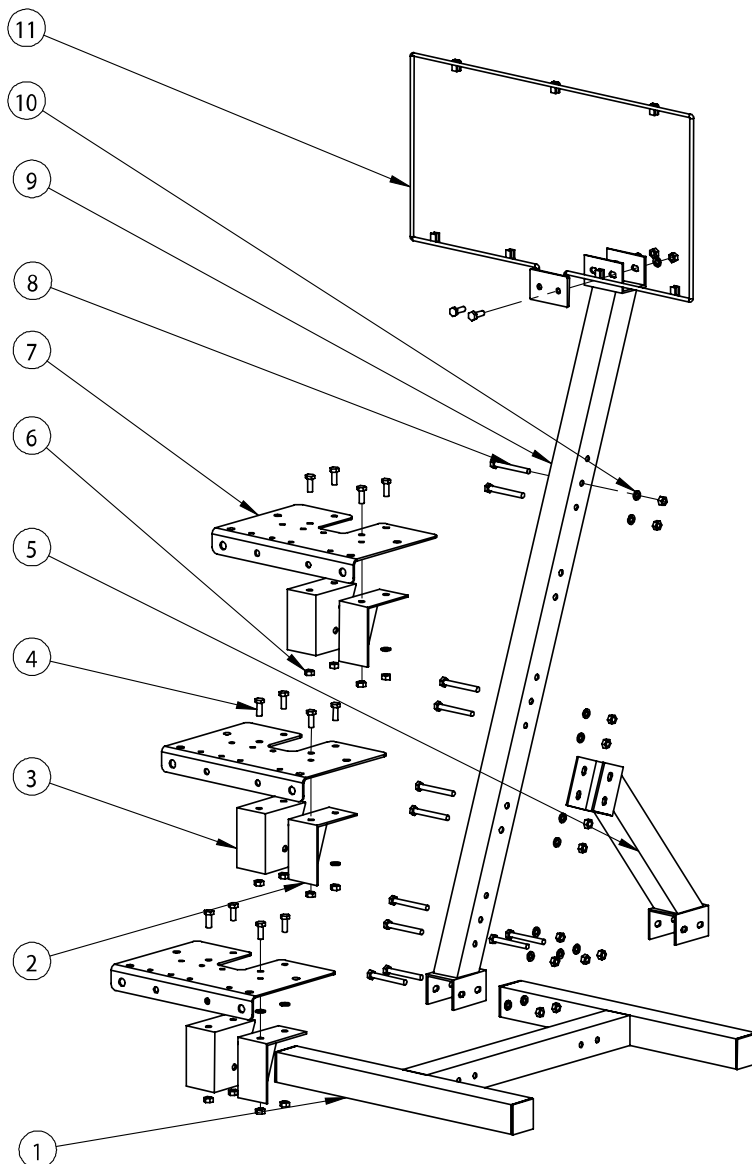

! WARNING: PLEASE DO NOT PUSH, PULL OR CLIMB ON THE RACK!!

Check out these other TrailFX Products!!

www.TrailFX.com



WIRELESS REMOTE



MOUNTING PLATE - CRADLE



MOUNTING PLATE - UNIVERSAL



ACCESSORY KIT

Keystone Automotive Operations Inc. (KAO) warrants this product to be free of defects in material and workmanship at the time of purchase by the original retail consumer. KAO disclaims any other warranties, express or implied, including the warranty of fitness for a particular purpose or an intended use. If the product is found to be defective, KAO may replace or repair the product at our option, when the product is returned prepaid, with proof of purchase. Alteration to, improper installation, or misuse of this product voids the warranty. KAO's liability is limited to repair or replacement of products found to be defective, and specifically excludes liability for any incidental or consequential loss or damage.