



TOW MIRROR GM14HET



2014-2017 Chevrolet Silverado / GMC Sierra 1500
2015-2017 Chevrolet Silverado / GMC Sierra HD



DO NOT OVER-TIGHTEN THE MOUNTING SCREWS.
OVER-TIGHTENING THE MOUNTING SCREWS MAY RESULT IN DAMAGE TO MOUNTING PLATE OR HARDWARE.



60-180 min

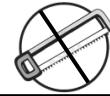

Cutting Not Required



Drilling Not Required



REMOVE CONTENTS FROM BOX. VERIFY ALL PARTS ARE PRESENT.



support@trailfx.com



1 866 638 4870



READ INSTRUCTIONS CAREFULLY BEFORE STARTING INSTALLATION.



Limited Lifetime Warranty

PARTS LIST

SL.No	Part Description	SL.No	Part Description
1	Drivers Side Mirror	2	Passenger Side Mirror

TOOLS NEEDED

10mm Socket (A)	Bezel Removal Tool (C)
7mm Socket (B)	Flat Head Screw Driver (D)
Ratchet (E)	

1



C



B

A



D

2



E

Installation Instruction

1. Using flat head screw driver remove the plastic cover inside door handle storage area. Insert the flat head screw driver in the notch of cover and pop out the plastic cover. See figure 1.

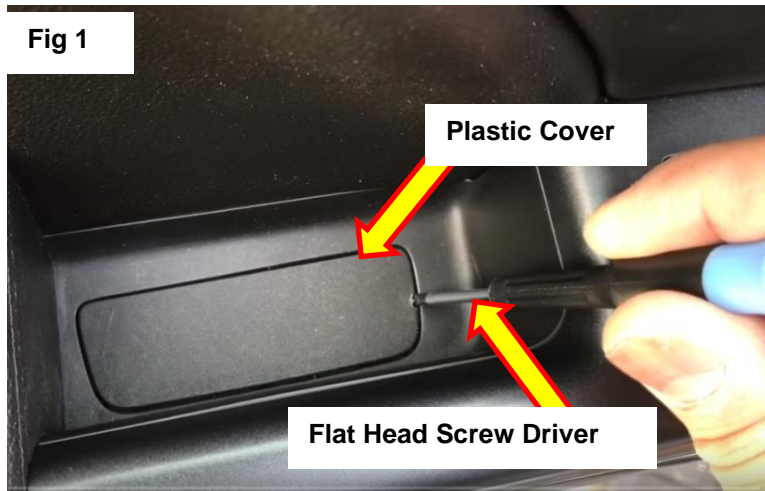

2. Using flat head screw driver remove the plastic cover located behind the door handle, Insert the flat head screw driver in the notch of cover and pop out the plastic cover. See figure 2.



3. Using bezel removal tool pull up the silver bezel trim near the switches. See figure 3.



NOTE: Pull the bezel out slow to help prevent the retention clips from breaking.

4. Remove all six screws using a 7mm socket. Refer to images below for screw locations.



5. Door panel has retention clips all around the door panel itself. Start pulling the door from one corner so that retention clips comes out of the retention clips holes. Once done door panel becomes loose. Lift up and pull the door panel out. See below images.



6. Remove the door handle latch which is located on back side of the door by pushing the lever down and pulling the latch out from door panel. See below images.



7. Disconnect the wiring harness from door panel. See below image.



8. Speaker has to be removed to get access to pull the door connector out remove the 7mm bolt using socket and ratchet. See below image.

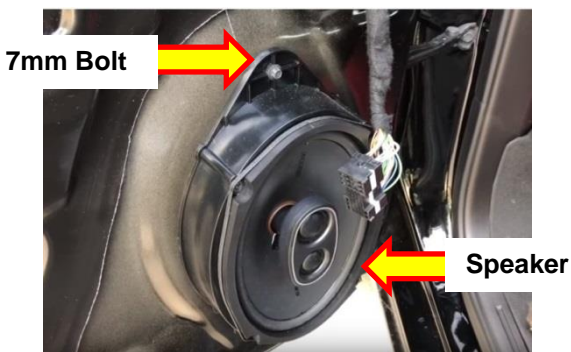

9. Remove the plastic trim panel near mirror. This trim is one single piece which goes around the entire window. See below image.

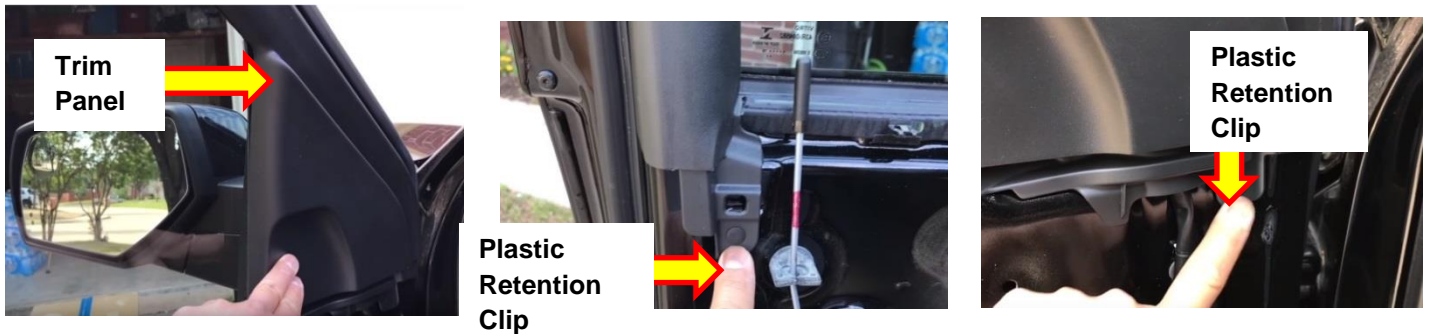

10. Remove both the plastic retention clips using bezel removal tool. Pull the plastic trim towards you so that it comes out of the door panel. See below image.

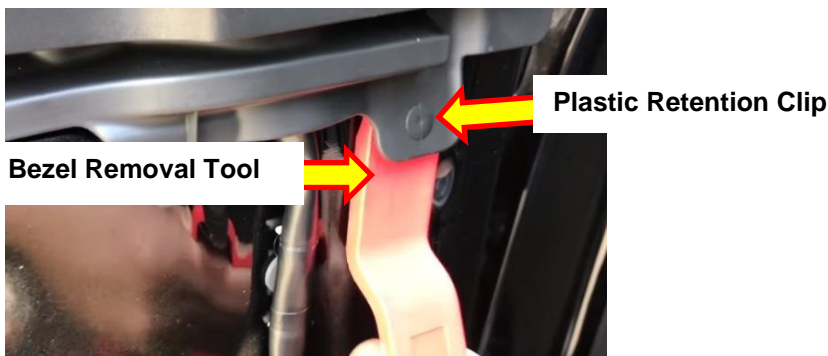

11. Once you take out the plastic trim panel you have access to the three 10mm bolts of existing mirror. Remove the bolts and washers using 10mm socket. See below images.



12. After all nuts are removed and wire connection is unplugged, slowly remove the OEM mirror from the vehicle.
13. Slide the mirror studs of the new TrailFX tow mirror into the three holes in door.



14. Re-install the washers and nuts using a 10mm socket and ratchet. Once mirror is secure, plug in wiring connection.
15. Re-install the plastic trim panel by inserting the plastic clips of the cover into the slot and push into place.
16. After installation, check all mirror functions to make sure they are working properly.

PRODUCT CARE

1. Periodically check the product to ensure all fasteners are tightened and components are intact.
2. Regular waxing is recommended to protect the finish of the product.
3. **Use ONLY Non-Abrasive automotive wax.** Use of any soap, polish or wax that contains an abrasive is detrimental and can scratch the finish leading to corrosion, ensure the cloth used for wiping is clean and soft.

FAQ's

1. **Tow mirrors are loose after installation.**
Please ensure that all required mounting brackets / hardware's are installed & tightened correctly.
2. **Missing / Excess Hardware.**
Re-check hardware count as per the part list.

Check out these other TrailFX Products!!

www.TrailFX.com



FULL FRONT REPLACEMENT BUMPER



REAR REPLACEMENT BUMPER



3.5 INCH OVAL BULL BAR



6" OVAL BENT STEP BAR

Keystone Automotive Operations Inc. (KAO) warrants this product to be free of defects in material and workmanship at the time of purchase by the original retail consumer. KAO disclaims any other warranties, express or implied, including the warranty of fitness for a particular purpose or an intended use. If the product is found to be defective, KAO may replace or repair the product at our option, when the product is returned prepaid, with proof of purchase. Alteration to, improper installation, or misuse of this product voids the warranty. KAO's liability is limited to repair or replacement of products found to be defective, and specifically excludes liability for any incidental or consequential loss or damage.